

SPRING 2023

FACULTY OF ECONOMICS PEARL

TIMETABLE

FIRST YEAR

Notes

1. Please pay attention and do not confuse course registration numbers with classroom numbers.
2. Half-year intensive courses have two classes per week, for example, English Academic Skills. For these courses, the same course registration number is printed for both classes.
For intensive course registration, if you enter the registration number, you will be registered for both classes automatically.
3. Important announcements from the university will be posted on the Keio University Student Website or "News" on keio.jp. Also, there will be notices posted at these locations if there are any classroom changes in the middle of the semester or temporary classroom changes. It is your responsibility to check the website regularly so as not to miss notices.
4. Any results in courses you have not registered for will be invalid, even if you take the exams or submit assignments.

*** Course Registration**

<http://keio.jp/> > Class > Course Registration

*** Keio University Syllabus and Timetable**

<https://gslbs.keio.jp/syllabus/login>

*** Keio University Student Website**

<https://www.students.keio.ac.jp/>

MEMO

		1 : 9 : 00 ~ 10 : 30					2 : 10 : 45 ~ 12 : 15				
		Lecturer	cls	Reg.No.	Courses	Room	Lecturer	cls	Reg.No.	Courses	Room
Mon	FOREIGN LANGUAGES										
	FOUNDATION	DIKONOMIDES, CATHERINE		94907	[Sp] INTRODUCTION TO CALCULUS	12	DIKONOMIDES, CATHERINE		99344	[Sp] ADVANCED LINEAR ALGEBRA	12
	GENERAL EDUCATION (CATEGORY I)										
	GENERAL EDUCATION (CATEGORY II)						SASAKI, YUMI		05595	[SpIn] INTERCULTURAL COMMUNICATION	D305
	GENERAL EDUCATION (CATEGORY III)						BATTY, ROGER M.		40774	[SpIn] HISTORY OF WESTERN ART AND FASHION 2	D402
Tue	FOUNDATION	SATO, SORA	P	95478	[Sp] HISTORICAL PERSPECTIVES IN ECONOMIC ANALYSIS	D203					
	MAJOR SUBJECTS						HIROSE, YASUO	P	95463	[Sp] ELEMENTARY MACROECONOMICS 2	13
	GENERAL EDUCATION (CATEGORY I)										
	GENERAL EDUCATION (CATEGORY II)										
	GENERAL EDUCATION (CATEGORY III)										
Wed	FOREIGN LANGUAGES	KAZ, DIANA M. NAKATSUGAWA, MIYUKI NOBUOKA, MARY BOHME, STEVENA MURPHY, KEVIN		94869 94357 94361 94911 94873	[SpIn] ENGLISH ACADEMIC SKILLS 2 [SpIn] ENGLISH ACADEMIC SKILLS 2 [SpIn] ENGLISH ACADEMIC SKILLS 2 [SpIn] ENGLISH ACADEMIC SKILLS 2 [SpIn] ENGLISH ACADEMIC SKILLS 2	D204 D401 J413 D404 D409					
	GENERAL EDUCATION (CATEGORY I)	SUGIMOTO, CHIKATOSH		05959	[Sp] LIFE SCIENCE - CURRENT STATUS AND PERSPECTIVES (GIC-certified courses)	D304	KANETA, KUNIO		40755	[Sp] NATURAL SCIENCES 2	D310
	GENERAL EDUCATION (CATEGORY II)						SASAKI, YUMI		05595	[SpIn] INTERCULTURAL COMMUNICATION	J431A
	GENERAL EDUCATION (CATEGORY III)						BONZI, ALANA R.		97451	[Sp] MARKETING AND SOCIETY	DB110
	FOUNDATION										
Thu	FOUNDATION										
	GENERAL EDUCATION (CATEGORY I)										
	GENERAL EDUCATION (CATEGORY II)										
	GENERAL EDUCATION (CATEGORY III)										
	FOUNDATION										
Fri	FOREIGN LANGUAGES	KAZ, DIANA M. NAKATSUGAWA, MIYUKI NOBUOKA, MARY BOHME, STEVENA MURPHY, KEVIN		94869 94357 94361 94911 94873	[SpIn] ENGLISH ACADEMIC SKILLS 2 [SpIn] ENGLISH ACADEMIC SKILLS 2 [SpIn] ENGLISH ACADEMIC SKILLS 2 [SpIn] ENGLISH ACADEMIC SKILLS 2 [SpIn] ENGLISH ACADEMIC SKILLS 2	D206 J435A 303 D401 D409					
	GENERAL EDUCATION (CATEGORY I)										
	GENERAL EDUCATION (CATEGORY II)						ERTL, WOLFGANG		46658	[Sp] ETHICS 1 (GIC-certified courses)	D205
	GENERAL EDUCATION (CATEGORY III)										
	FOUNDATION										
Sat	GENERAL EDUCATION (CATEGORY I)										
	GENERAL EDUCATION (CATEGORY II)						KIBATA, MIO RHYDEN, THOMAS P.		97997 05519	[Sp] HEALTH AND HUMAN PERFORMANCE 1 (GIC-certified courses) [Sp] HISTORY 1 (GIC-certified courses)	D304 J611

[Notes]:

【Sp】 : course offered in the Spring Semester

【SpIn】 : intensive course offered in the Spring Semester

→ : courses offered from preceding period

(GIC-certified courses): course not only for PEARL students whose main language of instruction is English, but also for students who take mainly courses with Japanese as the main language of instruction

*Courses without classroom numbers listed will be offered online.

*Classroom numbers for INTENSIVE JAPANESE2B, 5B (Offered at Mita Campus) will be fixed later. Please check on K-LMS before starting class.

* Adjustments will be made to a course if there are a particularly large number of student registering for it. (Highly possible for General Education Courses, especially for Intensive Courses marked as 【SpIn】 .)

3 : 13 : 00 ~ 14 : 30					4 : 14 : 45 ~ 16 : 15					5 : 16 : 30 ~ 18 : 00				
Lecturer	Clas	Reg.No.	Courses	Room	Lecturer	Clas	Reg.No.	Courses	Room	Lecturer	Clas	Reg.No.	Courses	Room
IKEDA, YUKIHIRO		83814	[Sp] INTENSIVE JAPANESE 1B(offere d at Mita Campus)	541	IKEDA, YUKIHIRO		83829	[Sp] INTENSIVE JAPANESE 4B(offere d at Mita Campus)	541	MCCOY, DAVIDH		94801	[Sp] GERMAN 1B	325
										BREFUEL, ROMUALD		95573	[Sp] FRENCH 3B	309
										MATSUKAWA, IKUYO		94888	[Sp] CHINESE 3B	D303
										MATSUKAWA, KOSUKE		94759	[Sp] SPANISH 1B	D304
										SANAI, KAORU		02471	[Sp] JAPANESE 1B	J435B
OBATA, RIKI		97050	[Sp] SCIENCE AND THE ENVIRONMENT1	D312						OBATA, RIKI		92301	[Sp] SCIENCE AND THE ENVIRONMENT1 (GIC-certified courses)	214
NOTTER, DAVID M.		97432	[SpIn] HISTORICAL SOCIOLOGY	D401						SHIRA, TETSUYA		97227	[Sp] TOPICS IN CONTEMPORARY BUSIN ESS 1(GIC-certified courses)	D410
				DB108						TSUCHIDA, HARUNOBU		92168	[Sp] MUSIC1(GIC-certified courses)	AV Hall 1
OKIMOTO, TATSUYOSHI	P	95444	[Sp] STATISTICS 2	33										
										KAJIMURA, MAYUMI		06022	[Sp] SCIENCE AND THE ENVIRONMENT1 (GIC-certified courses)	D403
					INOUE, SATOSHI		92153	[Sp] MUSIC1(GIC-certified courses)	AV Hall 1	TANREDI, CHRISTOPHER D.		91745	[Sp] LINGUISTICS SCIENCE 1(GIC-co rtified courses)	D206
										HAYASHI, HIDEKI		40535	[Sp] TOPICS IN CONTEMPORARY BUSIN ESS 1(GIC-certified courses)	325
										YAMAMOTO, YUKI		98037	[Sp] SOCIOLOGY 1(GIC-certified co urses)	D302
ISHINO, YURIKO		83833	[Sp] INTENSIVE JAPANESE 2B(offere d at Mita Campus)	1BA	ISHINO, YURIKO		83848	[Sp] INTENSIVE JAPANESE 5B(offere d at Mita Campus)	1BA	MCCOY, DAVIDH		94816	[Sp] GERMAN 2B	325
										SAUVEGRAIN, SYLVAIN		95281	[Sp] FRENCH 2B	336
										WU, MAOSONG		95186	[Sp] CHINESE 1B	D309
										MATSUKAWA, KOSUKE		94763	[Sp] SPANISH 2B	D407
										AKISADA, MIHO		02505	[Sp] JAPANESE 3B	J436B
NOTTER, DAVID M. YUKAWA, YAYOI		97432 46089	[SpIn] HISTORICAL SOCIOLOGY [Sp] GENDER STUDIES 1(GIC-certifi ed courses)	308 33						VOGL, WALTER		94706	[Sp] LITERATURE 1(GIC-certified c ourses)	J421
										FITZ, STEPHEN		01092	[Sp] INFORMATION PROCESSING 2(Pyt hon Programming)	D403
										FLACHI, ANTONINO		35468	[Sp] SCIENCE AND COOKING1(GIC-)	
										OGAWA, TADASHI		06109	[Sp] AREA STUDIES ON CULTURE 1(GI C-certified courses)	DB112
										GORSHKOV, VICTOR		01331	[Sp] TOPICS IN CONTEMPORARY BUSIN ESS 1(GIC-certified courses)	302
										LIAN, SHU		43424	[Sp] AREA STUDIES-CONTEMPORARY ST ATE OF AFFAIRS IN CHINA 1(GIC-cert ified courses)	D309
IKEDA, YUKIHIRO		83852	[Sp] INTENSIVE JAPANESE 3B(offere d at Mita Campus)	142C	IKEDA, YUKIHIRO		83943	[Sp] INTENSIVE JAPANESE 6B(offere d at Mita Campus)	142C	DEGEN, RALPH		94835	[Sp] GERMAN 3B	D404
					TAKAHASHI, KEIKO		00096	[Sp] JAPANESE 5B	J425	OSHIMA, ERIKO		95277	[Sp] FRENCH 1B	D303
FLACHI, ANTONINO		96402	[Sp] INTRODUCTION TO COSMOLOGY(GI C-certified courses)	224	FLACHI, ANTONINO		92244	[Sp] SCIENCE AND THE ENVIRONMENT1 (GIC-certified courses)	224	WU, MAOSONG		95205	[Sp] CHINESE 2B	J426
MARUYA, KAZUSHI		05227	[Sp] PSYCHOLOGY 2	811						SANCHEZ BARRERA, MARTA		94778	[Sp] SPANISH 3B	J413
SAKO, KATSURA		95076	[Sp] LITERATURE 1(GIC-certified c ourses)	22	TARUMI, YUKO		05600	[Sp] SOCIOLOGY 2	J631	MIYAMOTO, HANAE		02486	[Sp] JAPANESE 2B	J437B
					BAI, YINGJIU		39611	[Sp] GEOGRAPHY1(GIC-certified cou rses)	12					
					BATTY, ROGER M.		40774	[SpIn] HISTORY OF WESTERN ART AND FASHION 2	Seminar Room 1	BENNETT, ALEXANDER C.		91764	[Sp] AREA STUDIES ON CULTURE 1(GI C-certified courses)	
TOYODA, KENSURE		91711	[Sp] LIFE SCIENCE – CURRENT STATU S AND PERSPECTIVES(GIC-certified c ourses)											
OMAE, KEIICHIRO		97944	[Sp] TOPICS IN CONTEMPORARY BUSIN ESS 1(GIC-certified courses)	D201										

• In order to register courses listed in the above timetable, please register through the Course Registration System and select column A.

• In order to register courses for type A/B students instructed in Japanese excluding courses offered by various research institutes and other faculties, please consult with the Office of Student Services during the Course Registration Period with extra time. It is not possible to register these courses through the Course Registration System. Dates and periods of those courses can be found on the timetable for type AB students. These credits are counted as Optional Subjects.

• The office will inform students who have not completed“English Academic Skills 2”of which class to re-register for the course at“News”on Keio.jp.

Course Timetable for the Various Research Centers and Institutes at Hiyoshi

There are different course registration procedures for the various research centers and institutes.
Carefully read the course descriptions, syllabi online and relative documents.

1. Credits for these courses are counted as Electives (Non-specific) credits.

• Courses offered by the Institute of Physical Education

It is possible to take the same course (sport) multiple times.

In order to register for the following courses, please select column A.

Course	Lecturer	Semester	Day/Period	Registration No.	Classroom
PHYSICAL ACTIVITY A (TENNIS)	SAKAI, TOSHIKI	Spring	Mon/2	39044	Tennis courts (Mamushi Valley)
PHYSICAL ACTIVITY A (SWIMMING)	TORIUMI, TAKASHI	Spring	Thu/3	07731	Hiyoshi Collaboration Complex (Kyosei-kan) Swimming Pool

2. Credits for these courses are counted as Optional credits.

• Courses offered by the Keio Research Center for Foreign Language Education

Courses offered by the Keio Research Center for Foreign Language Education are normally taught in Japanese.

In order to register for the following courses, please select column A.

For procedures to course registration and the results of course registration adjustment, please refer to the website:

<http://www.flang.keio.ac.jp/en/>

		1st period	2nd period	3rd period	4th period	5th period
Mon.	Reg. No					
	Course Name					
	Lecturer					
	Room					
	Credits					
	Field					
Tues.	Reg. No					
	Course Name					
	Lecturer					
	Room					
	Credits					
	Field					
Wed.	Reg. No					
	Course Name					
	Lecturer					
	Room					
	Credits					
	Field					
Thurs.	Reg. No					
	Course Name					
	Lecturer					
	Room					
	Credits					
	Field					
Fri.	Reg. No					
	Course Name					
	Lecturer					
	Room					
	Credits					
	Field					
Sat.	Reg. No					
	Course Name					
	Lecturer					
	Room					
	Credits					
	Field					

Number of Credits for the Fall Semester
 _____ credits in total
 Max credits for a full year
 (2022 Fall Sem. + 2023 Spring Sem.)
 : 48 credits

Classroom Map

【Fujiyama Memorial Hall】

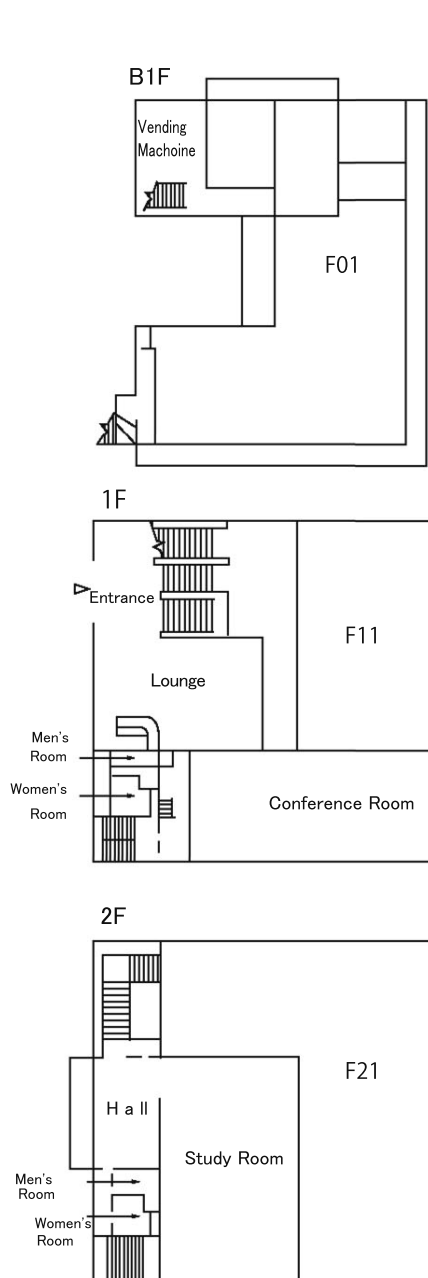

Renovation work will be carried out in Fujiyama Memorial Hall starting in the fall semester of 2023.

【Fourth Building Independence Wing】

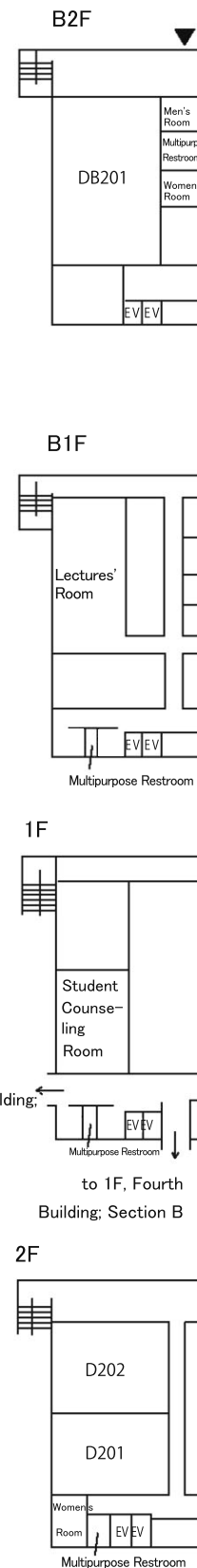
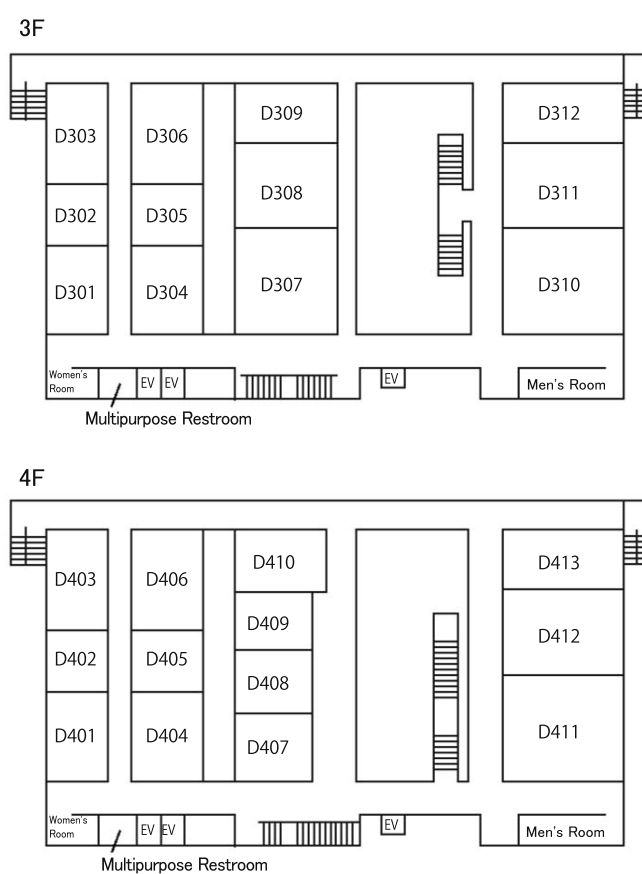

【Fourth Building General View】

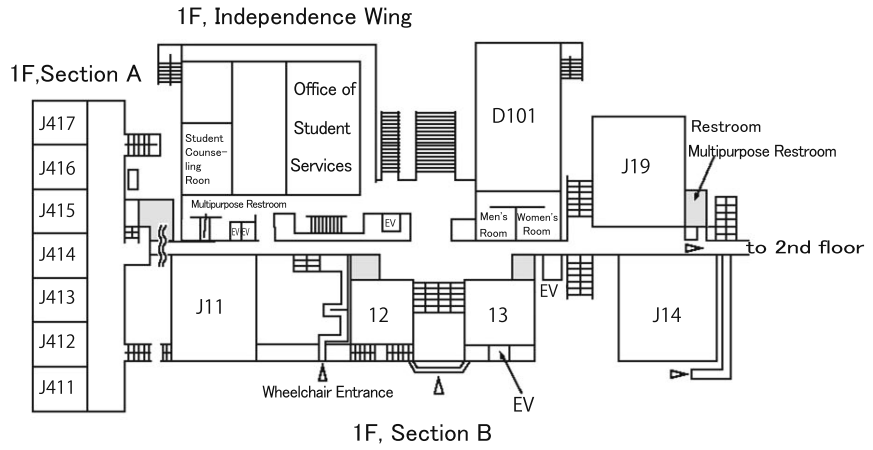
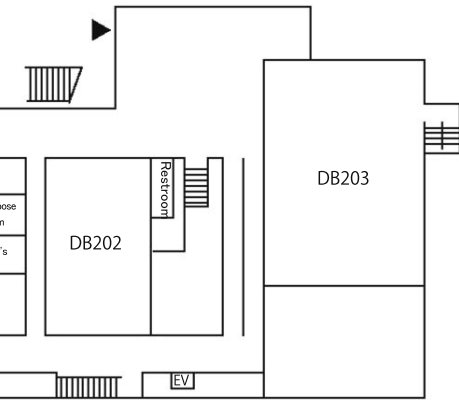

1F, Section B

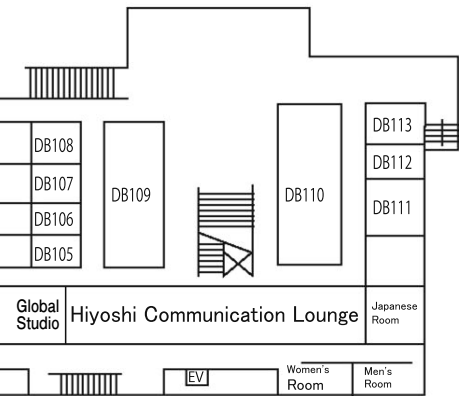

2F, Section A

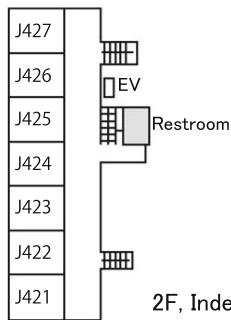

2F, Independence Wing

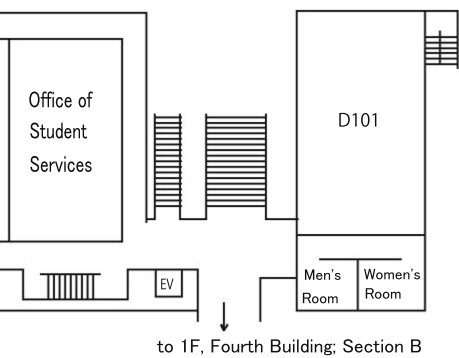

3F, Section A

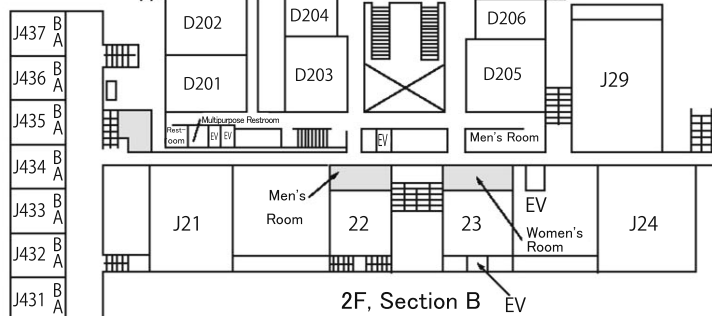

2F, Section B

3F, Independence Wing

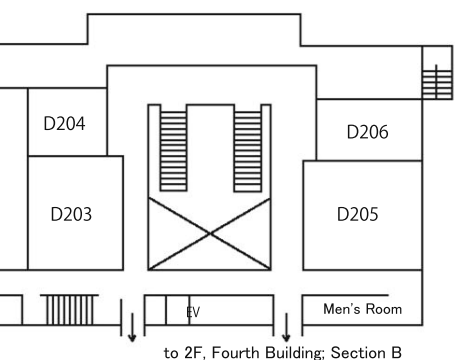

4F, Section A

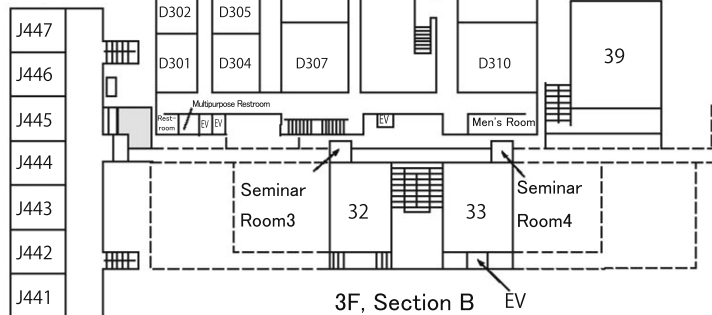

3F, Section B

【Eighth Building】

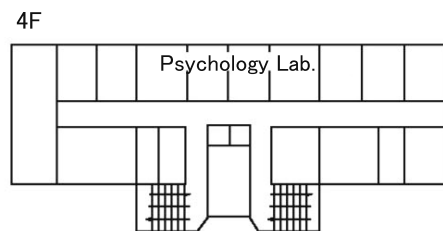
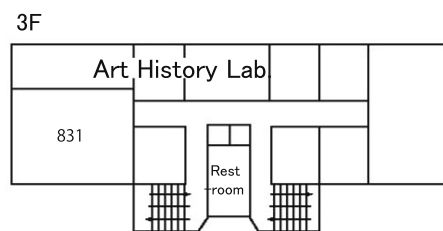
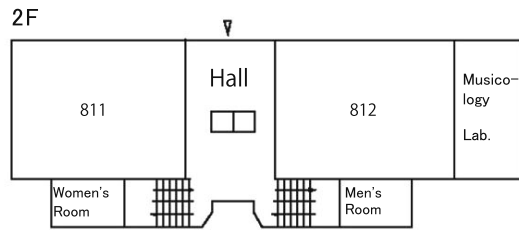

【Seventh Building】

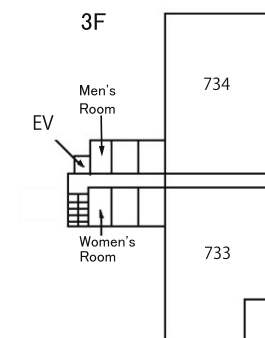
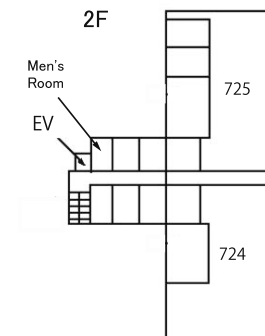
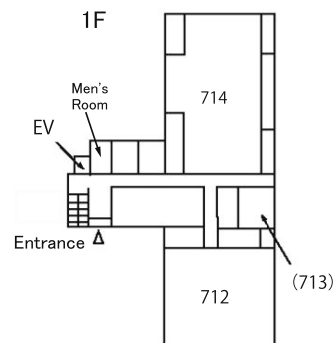
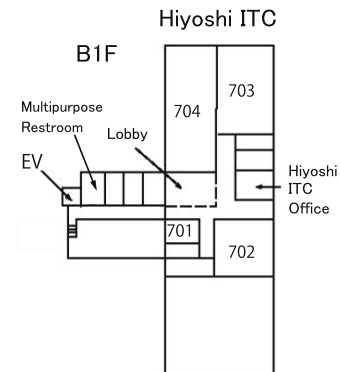

【Sixth Building】

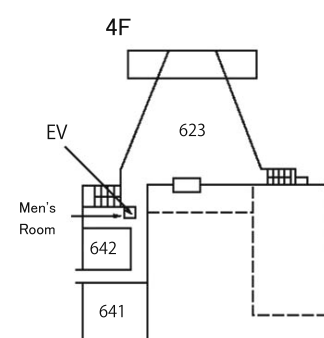
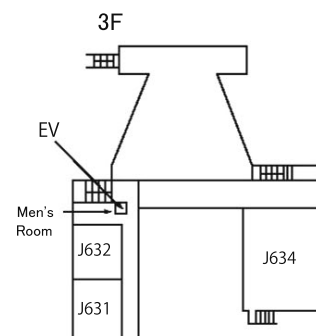
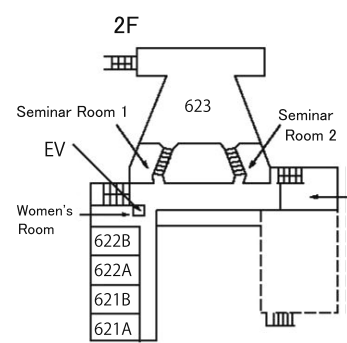
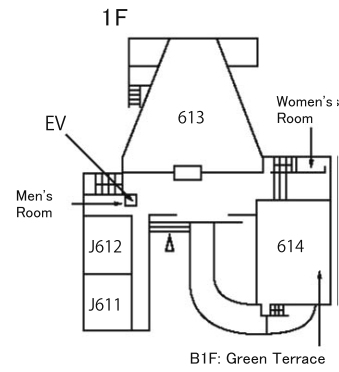

【Third Building】

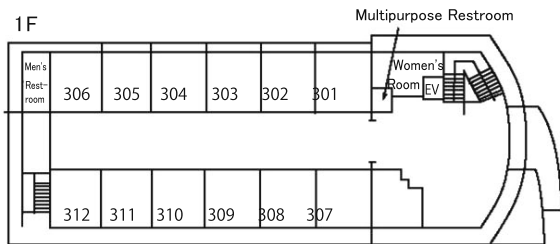

【Second Building】

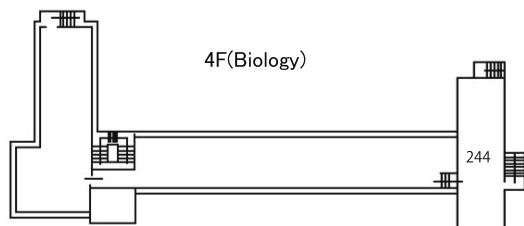
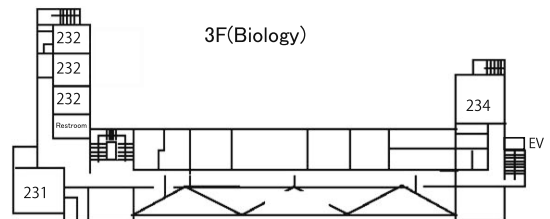
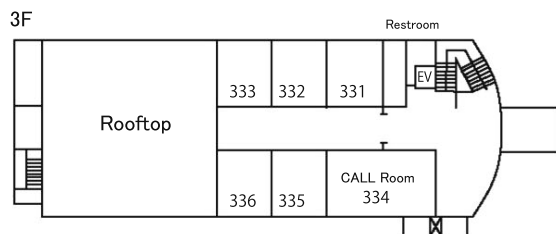
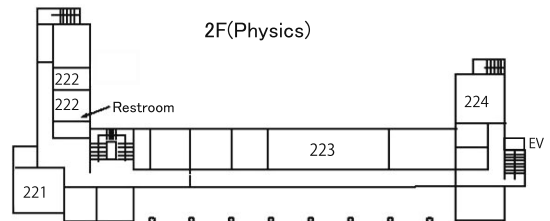
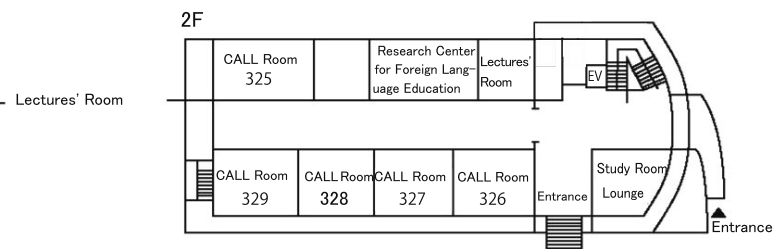
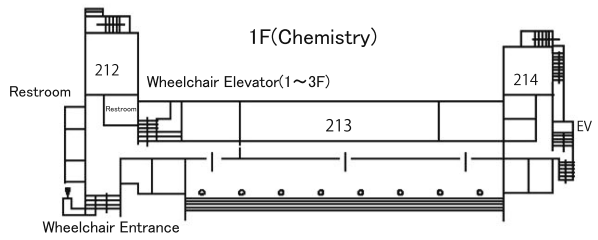

[Hiyoshi Campus Map]

