

SPRING 2023

FACULTY OF ECONOMICS PEARL

TIMETABLE

SECOND YEAR

Notes

1. Please pay attention and do not confuse course registration numbers with classroom numbers.
2. Half-year intensive courses have two classes per week, for example, English Academic Skills. For these courses, the same course registration number is printed for both classes.
For intensive course registration, if you enter the registration number, you will be registered for both classes automatically.
3. Important announcements from the university will be posted on the Keio University Student Website or "News" on keio.jp. Also, there will be notices posted at these locations if there are any classroom changes in the middle of the semester or temporary classroom changes. It is your responsibility to check the website regularly so as not to miss notices.
4. Any results in courses you have not registered for will be invalid, even if you take the exams or submit assignments.

*** Course Registration**

<http://keio.jp/> > Class > Course Registration

*** Keio University Syllabus and Timetable**

<https://gslbs.keio.jp/syllabus/login>

*** Keio University Student Website**

<https://www.students.keio.ac.jp/>

		1st period	2nd period	3rd period	4th period	5th period
Mon.	Reg. No					
	Course Name					
	Lecturer					
	Room					
	Credits					
	Field					
Tues.	Reg. No					
	Course Name					
	Lecturer					
	Room					
	Credits					
	Field					
Wed.	Reg. No					
	Course Name					
	Lecturer					
	Room					
	Credits					
	Field					
Thurs.	Reg. No					
	Course Name					
	Lecturer					
	Room					
	Credits					
	Field					
Fri.	Reg. No					
	Course Name					
	Lecturer					
	Room					
	Credits					
	Field					
Sat.	Reg. No					
	Course Name					
	Lecturer					
	Room					
	Credits					
	Field					

Number of Credits for the Fall Semester
 _____ credits in total
 Max credits for a full year
 (2022 Fall Sem. + 2023 Spring Sem.)
 : 48 credits

		1 : 9 : 00 ~ 10 : 30					2 : 10 : 45 ~ 12 : 15				
		Lecturer	Cl	Reg.No.	Courses	Room	Lecturer	Cl	Reg.No.	Courses	Room
Mon	FOREIGN LANGUAGES										
	FOUNDATION ELECTIVE						DIKONOHIDES, CATHERINE		99344	【Sp】 ADVANCED LINEAR ALGEBRA	12
	GENERAL EDUCATION (CATEGORY I)										
	GENERAL EDUCATION (CATEGORY II)						SASAKI, YUMI		05595	【SpIn】 INTERCULTURAL COMMUNICATION	D305
Tue	MAJOR SUBJECTS						BATTY, ROGER M.		40774	【SpIn】 HISTORY OF WESTERN ART AND FASHION 2	D402
	GENERAL EDUCATION (CATEGORY I)						ERTL, JOHN J.		45207	【SpIn】 GENERAL EDUCATION SEMINAR (GIC-certified courses)	DB108
	GENERAL EDUCATION (CATEGORY II)										
	GENERAL EDUCATION (CATEGORY III)										
Wed	FOREIGN LANGUAGES										
	GENERAL EDUCATION (CATEGORY I)	SUGIMOTO, CHIKATOSH		05959	【Sp】 LIFE SCIENCE - CURRENT STATUS AND PERSPECTIVES (GIC-certified courses)	D304	KANETA, KUNIO		40755	【Sp】 NATURAL SCIENCES 2	D310
	GENERAL EDUCATION (CATEGORY II)						SASAKI, YUMI		05595	【SpIn】 INTERCULTURAL COMMUNICATION	J431A
	GENERAL EDUCATION (CATEGORY III)						BONZI, ALANA R.		97451	【Sp】 MARKETING AND SOCIETY	DB110
Thu	FOUNDATION										
	MAJOR SUBJECTS	KURINO, MORIMITSU	P	98462	【Sp】 INTRODUCTION TO MICROECONOMICS 2	J19	OTA, ATSUSHI	P	98443	【Sp】 ELEMENTARY ECONOMIC HISTORY 2	12
	GENERAL EDUCATION (CATEGORY I)										
	GENERAL EDUCATION (CATEGORY II)										
Fri	FOREIGN LANGUAGES										
	MAJOR SUBJECTS						HOKARI, TORU		06568	【Sp】 MATHEMATICS FOR ECONOMICS 3	D310
	GENERAL EDUCATION (CATEGORY I)						WADA, TATSUMA		97045	【Sp】 TOPICS ON INTERNATIONAL ECONOMICS	D307
	GENERAL EDUCATION (CATEGORY II)						ERTL, WOLFGANG		46658	【Sp】 ETHICS 1 (GIC-certified courses)	D205
Sat	GENERAL EDUCATION (CATEGORY I)										
	GENERAL EDUCATION (CATEGORY II)						KIBATA, MIO		97997	【Sp】 HEALTH AND HUMAN PERFORMANCE 1 (GIC-certified courses)	D304
	GENERAL EDUCATION (CATEGORY III)						RINDWEN, THOMAS P		05519	【Sp】 HISTORY 1 (GIC-certified courses)	J611
	GENERAL EDUCATION (CATEGORY IV)										

[Notes]:

【Sp】 : course offered in the Spring Semester

【SpIn】 : intensive course offered in the Spring Semester

→ : courses offered from preceding period

(GIC-certified courses): course not only for PEARL students whose main language of instruction is English, but also for students who take mainly courses with Japanese as the main language of instruction

*Courses without classroom numbers listed will be offered online.

*Adjustments will be made to a course if there are a particularly large number of students registering for it. (Highly possible for General Education Courses, especially for Intensive Courses marked as 【SpIn】 .)

3 : 13 : 00 ~ 14 : 30					4 : 14 : 45 ~ 16 : 15					5 : 16 : 30 ~ 18 : 00				
Lecturer	Cl	Reg. No.	Courses	Room	Lecturer	Cl	Reg. No.	Courses	Room	Lecturer	Cl	Reg. No.	Courses	Room
AKISADA, MIHO		98113	[Sp] INTENSIVE JAPANESE 7B	J 434B	MCCOY, DAVIDH		12501	[SpIn] GERMAN 4A	325					
					LEBOIS, JEROME		12535	[SpIn] FRENCH 4A	D409					
					ZHANG, YUE		12516	[SpIn] CHINESE 4A	D305					
					ALONSO, JOSER		12497	[SpIn] SPANISH 4A	J442					
					SANAL, KAORU		18108	[SpIn] JAPANESE 4A	J435B					
					AKISADA, MIHO		98128	[Sp] INTENSIVE JAPANESE 10B	J434B					
OBATA, RIKA		97050	[Sp] SCIENCE AND THE ENVIRONMENT1	D312						OBATA, RIKA		92301	[Sp] SCIENCE AND THE ENVIRONMENT1 (GIC-certified courses)	214
NOTTER, DAVID M.		97432	[SpIn] HISTORICAL SOCIOLOGY	D401						SHIRA, TETSUYA		97227	[Sp] TOPICS IN CONTEMPORARY BUSINESS 1 (GIC-certified courses)	D410
										TSUCHIDA, HARUNOBU		92168	[Sp] MUSIC1 (GIC-certified courses)	AV Hall
				DB108										
					KAWASHITA, MASAKAZU		01088	[Sp] ECONOMICS AND ENVIRONMENT	23					
					KONISHI, YOSHIFUMI		98458	[Sp] MARXIAN ECONOMICS 2	D309					
					OHNISHI, HIROSHI					KAJIMURA, MAYUMI		06022	[Sp] SCIENCE AND THE ENVIRONMENT1 (GIC-certified courses)	D403
					INOUE, SATOSHI		92153	[Sp] MUSIC1 (GIC-certified courses)	AV Hall	TANCREDI, CHRISTOPHER D.		91745	[Sp] LINGUISTICS SCIENCE 1 (GIC-certified courses)	D206
										HAYASHI, HIDEKI		40535	[Sp] TOPICS IN CONTEMPORARY BUSINESS 1 (GIC-certified courses)	325
										YAMAMOTO, YUKI		98037	[Sp] SOCIOLOGY 1 (GIC-certified courses)	D302
					MCCOY, DAVIDH		12501	[SpIn] GERMAN 4B	325	MIYAMOTO, HANAE		00670	[Sp] INTENSIVE JAPANESE 11B	J435A
					SAUVEGRAIN, SYLVAIN		12535	[SpIn] FRENCH 4B	336					
					ZHANG, YUE		12516	[SpIn] CHINESE 4B	D405					
					ALONSO, JOSER		12497	[SpIn] SPANISH 4B	J424					
					KASHIKURA, HIROMI		18108	[SpIn] JAPANESE 4B	J436B					
					MIYAMOTO, HANAE		00665	[Sp] INTENSIVE JAPANESE 8B	J435A					
NOTTER, DAVID M. YUKAWA, YAYOI		97432 46089	[SpIn] HISTORICAL SOCIOLOGY [Sp] GENDER STUDIES 1 (GIC-certified courses)	308 33						VOGL, WALTER		94706	[Sp] LITERATURE 1 (GIC-certified courses)	J421
										FITZ, STEPHEN		01092	[Sp] INFORMATION PROCESSING 2 (Python Programming)	D403
										FLACHI, ANTONINO		35468	[Sp] SCIENCE AND COOKING1 (GIC-certified courses)	
										OGAWA, TADASHI		06109	[Sp] AREA STUDIES ON CULTURE 1 (GIC-certified courses)	DB112
										GORSHKOV, VICTOR		01331	[Sp] TOPICS IN CONTEMPORARY BUSINESS 1 (GIC-certified courses)	302
										LIAN, SHU		43424	[Sp] AREA STUDIES-CONTEMPORARY STATE OF AFFAIRS IN CHINA 1 (GIC-certified courses)	D309
ISHIZUKA, KYOKO		00354	[Sp] INTENSIVE JAPANESE 9B	D302	ISHIZUKA, KYOKO		00938	[Sp] INTENSIVE JAPANESE 12B	D302					
					TAKAHASHI, KEIKO		00096	[Sp] JAPANESE 5B	J425					
FLACHI, ANTONINO		96402	[Sp] INTRODUCTION TO COSMOLOGY (GIC-certified courses)	224	FLACHI, ANTONINO		92244	[Sp] SCIENCE AND THE ENVIRONMENT1 (GIC-certified courses)	224					
MARUYA, KAZUSHI		05227	[Sp] PSYCHOLOGY 2	811										
SAKO, KATSURA		95076	[Sp] LITERATURE 1 (GIC-certified courses)	22	TARUMI, YUKO		05600	[Sp] SOCIOLOGY 2	J631	BENNETT, ALEXANDER C.		91764	[Sp] AREA STUDIES ON CULTURE 1 (GIC-certified courses)	
					BAI, YINGJIU		39611	[Sp] GEOGRAPHY1 (GIC-certified courses)	12					
					BATTY, ROGER M.		40774	[SpIn] HISTORY OF WESTERN ART AND FASHION 2	Seminar Room 1					
TOYODA, KENSUKE		91711	[Sp] LIFE SCIENCE - CURRENT STATUS AND PERSPECTIVES (GIC-certified courses)											
OMAE, KEIICHIRO		97944	[Sp] TOPICS IN CONTEMPORARY BUSINESS 1 (GIC-certified courses)	D201										

*Students who have not taken all of the mandatory subjects for the Spring Semester of the first year should check the timetable on page 6.

*In order to register courses listed in the above timetable, please register through the Course Registration System and select column A.

*If you wish to register courses for type A/B students instructed in Japanese excluding courses offered by various research institutes and other faculties, please consult with the Office of Student Services during the Course Registration Period with extra time. It is not possible to register these courses through the Course Registration System. Dates and periods of those courses can be found on the timetable for type AB students. These credits are counted as Optional Subjects.

Course Timetable for the Various Research Centers and Institutes at Hiyoshi

There are different course registration procedures for the various research centers and institutes. Carefully read the course descriptions, syllabi online and relative documents.

1. Credits for these courses are counted as Electives (Non-specific) credits.

• Courses offered by the Institute of Physical Education

It is possible to take the same course (sport) multiple times.
In order to register for the following courses, please select column A.

Course	Lecturer	Semester	Day/Period	Registration No.	Classroom
PHYSICAL ACTIVITY A (TENNIS)	SAKAI, TOSHIKI	Spring	Mon/2	39044	Tennis courts (Mamushi Valley)
PHYSICAL ACTIVITY A (SWIMMING)	TORIUMI, TAKASHI	Spring	Thu/3	07731	Hiyoshi Collaboration Complex (Kyosei-kan) Swimming Pool

• Courses offered by the International Center

Courses offered by the International Center are held at **Mita Campus**.
When course names are the same, students are able to take only one of them even though they are taught by different lecturers.
In order to register for the following courses, please select column A.

For procedures to course registration and the results of course registration adjustment, please refer to the website:
<https://www.ic.keio.ac.jp/en/aboutic/aboutcourse/>

2. Credits for these courses are counted as Optional credits.

• Courses offered by the Keio Research Center for Foreign Language Education

Courses offered by the Keio Research Center for Foreign Language Education are normally taught in Japanese.
In order to register for the following courses, please select column A.

For procedures to course registration and the results of course registration adjustment, please refer to the website:
<http://www.flang.keio.ac.jp/en/>

Timetable of Mandatory Subjects and Foundation Subjects (Elective subjects) for First-Year Students

Students who have not taken all of the required credits of the mandatory subjects for the Spring Semester of the first year need to retake the courses. These courses are pre-registered. Please make sure to check during the registration period to see if the designated class have been registered.

The designated class for “English Academic Skills 2” will be informed via keio.jp "News" to the students who have not completed the course.

Course	Lecturer	Semester	Day/Period	Registration No.	Classroom
ENGLISH ACADEMIC SKILLS 2	KAZ,DIANA M.	Spring	Wed/1, Fri/1	94869	D204,D206
ENGLISH ACADEMIC SKILLS 2	NAKATSUGAWA,MIYUKI	Spring	Wed/1, Fri/1	94357	D401,J435A
ENGLISH ACADEMIC SKILLS 2	NOBUOKA,MARY	Spring	Wed/1, Fri/1	94361	J413,303
ENGLISH ACADEMIC SKILLS 2	BOHME,STEVEN A	Spring	Wed/1, Fri/1	94911	D404,D401
ENGLISH ACADEMIC SKILLS 2	MURPHY,KEVIN	Spring	Wed/1, Fri/1	94873	D409,D409
GERMAN 1B	MCCOY, DAVID H	Spring	Mon/5	94801	325
GERMAN 2B	MCCOY, DAVID H	Spring	Wed/5	94816	325
GERMAN 3B	DEGEN, RALPH	Spring	Fri/5	94835	D404
FRENCH 1B	OSHIMA,ERIKO	Spring	Fri/5	95277	D303
FRENCH 2B	SAUVEGRAIN,SYLVAIN	Spring	Wed/5	95281	336
FRENCH 3B	BREFUEL,ROMUALD	Spring	Mon/5	95573	309
CHINESE 1B	WU,MAOSONG	Spring	Wed/5	95186	D309
CHINESE 2B	WU,MAOSONG	Spring	Fri/5	95205	J426
CHINESE 3B	MATSUKAWA,IKUYO	Spring	Mon/5	94888	D303
SPANISH 1B	MATSUKAWA,KOSUKE	Spring	Mon/5	94759	D304
SPANISH 2B	MATSUKAWA,KOSUKE	Spring	Wed/5	94763	D407
SPANISH 3B	SANCHEZ BARRERA,MARTA	Spring	Fri/5	94778	J413
JAPANESE 1B	SANAI,KAORU	Spring	Mon/5	02471	J435B
JAPANESE 2B	MIYAMOTO,HANAE	Spring	Fri/5	02486	J437B
JAPANESE 3B	AKISADA,MIHO	Spring	Wed/5	02505	J436B
STATISTICS 2	OKIMOTO,TATSUYOSHI	Spring	Tue/3	95444	33
HISTORICAL PERSPECTIVES IN ECONOMIC ANALYSIS	SATO,SORA	Spring	Tue/1	95478	D203
ELEMENTARY MACROECONOMICS 2	HIROSE, YASUO	Spring	Tue/2	95463	13

First Year Foundation Subjects (Elective subjects)

Although the course listed below is for the first year students, it is available for the second year students to take.

Course	Lecturer	Semester	Day/Period	Registration No.	Classroom
INTRODUCTION TO CALCULUS	OIKONOMIDES,CATHERINE	Spring	Mon/1	94907	12

Classroom Map

【Fujiyama Memorial Hall】

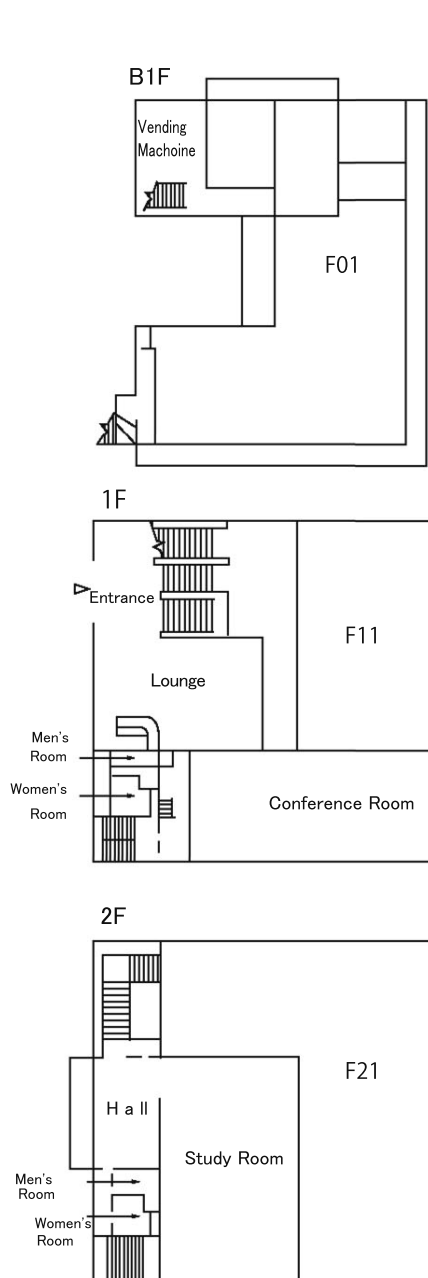

Renovation work will be carried out in Fujiyama Memorial Hall starting in the fall semester of 2023.

【Fourth Building Independence Wing】

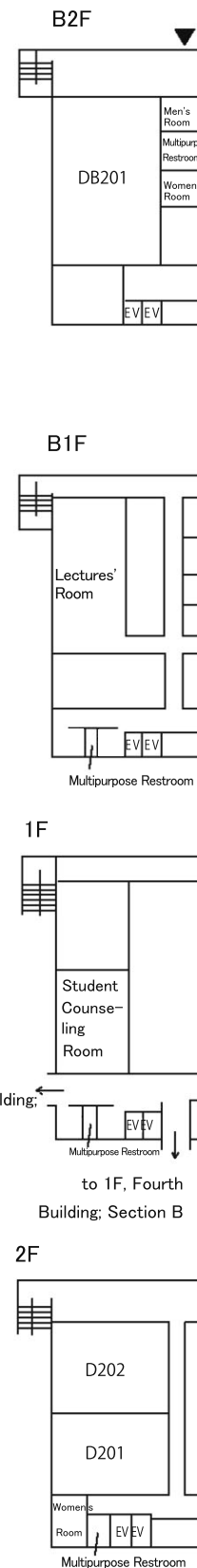
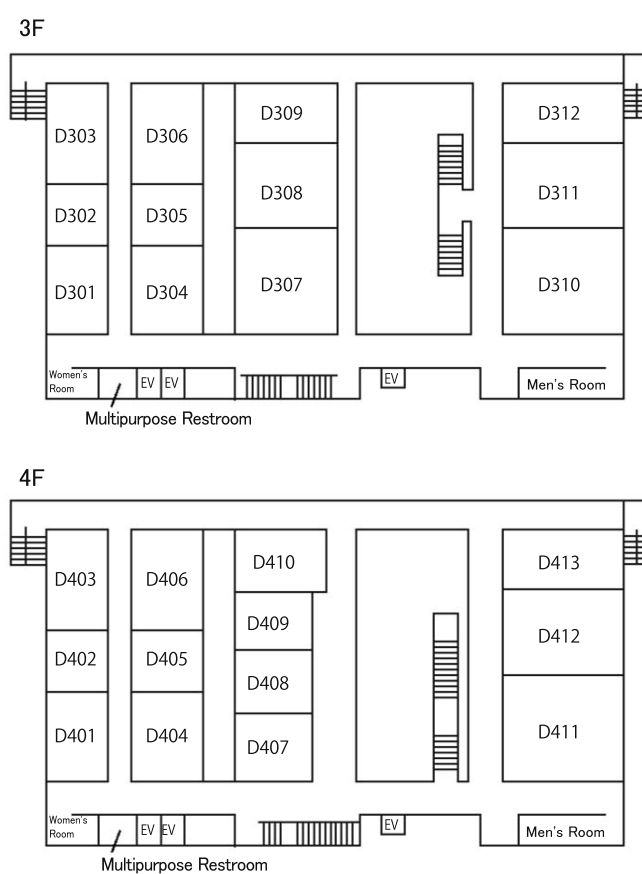

【Fourth Building General View】

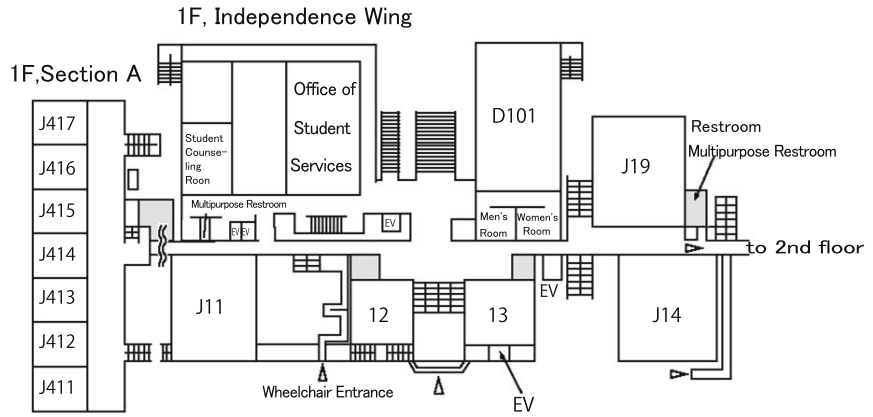
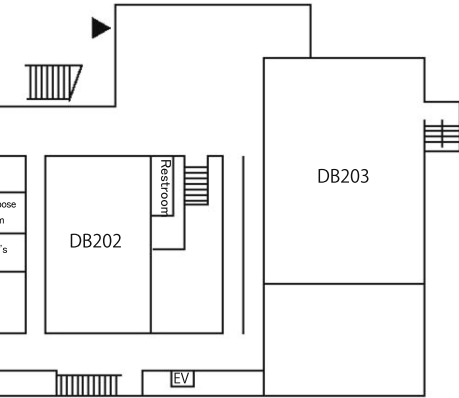

1F, Section B

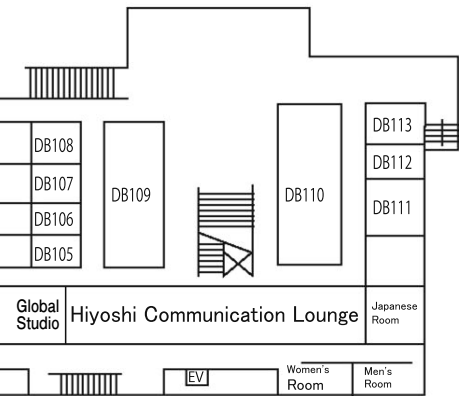

2F, Section A

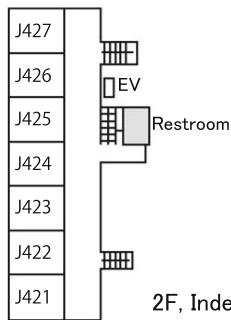

2F, Independence Wing

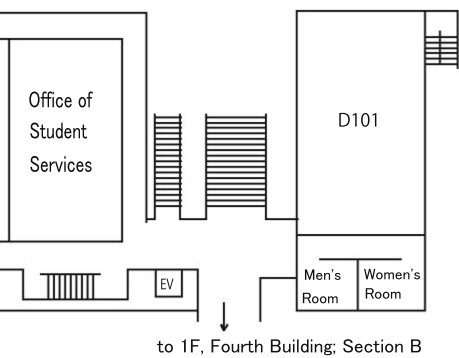

3F, Section A

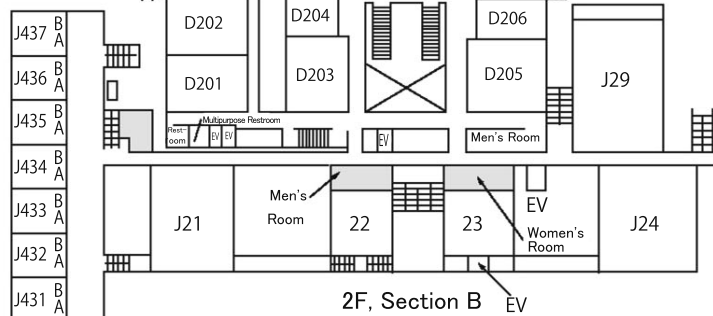

2F, Section B

3F, Independence Wing

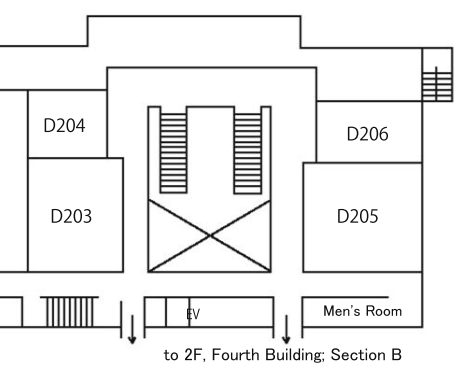

4F, Section A

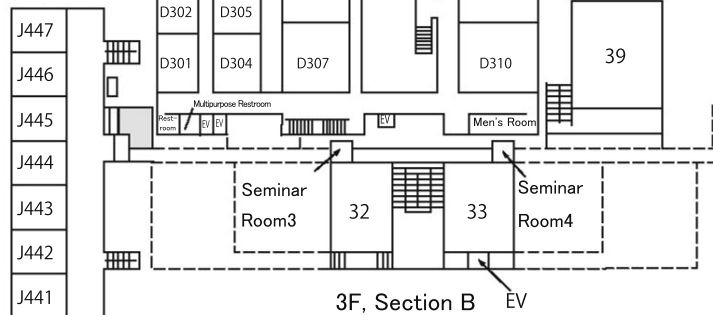

3F, Section B

【Eighth Building】

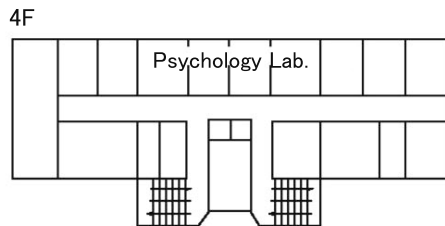
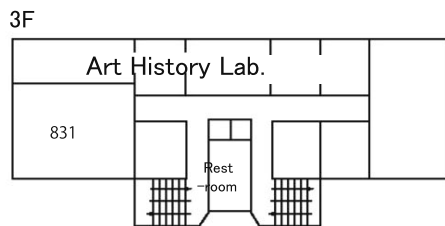
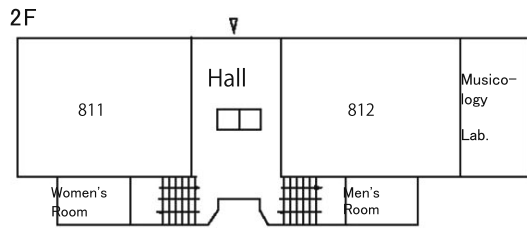

【Seventh Building】

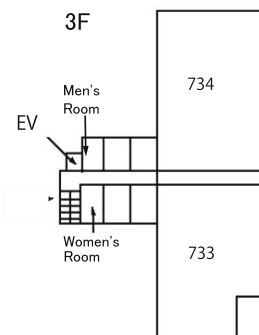
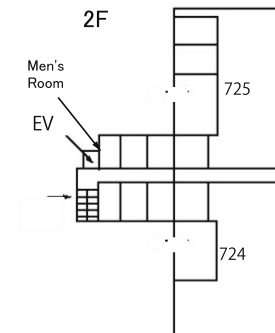
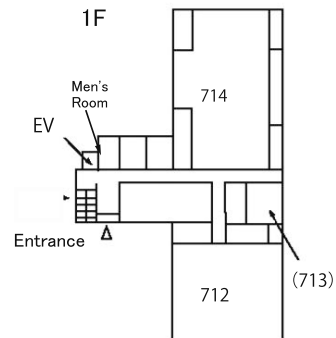
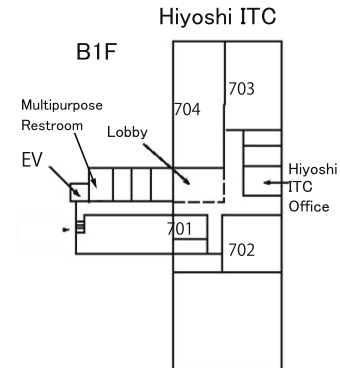

【Sixth Building】

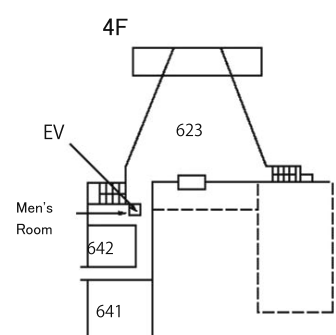
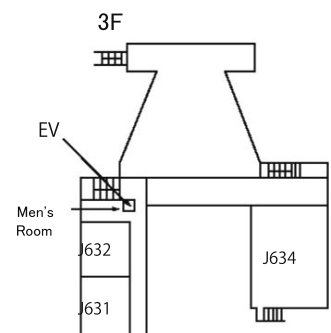
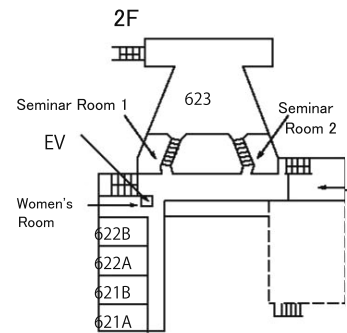
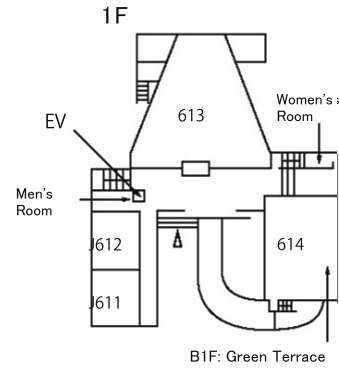

【Third Building】

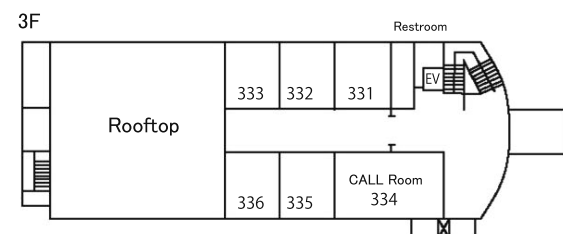
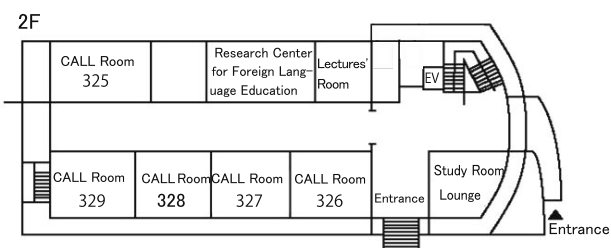
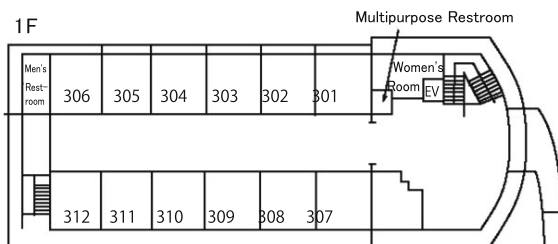

【Second Building】

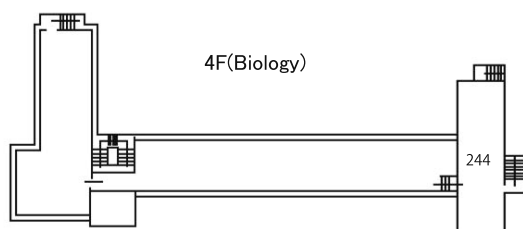
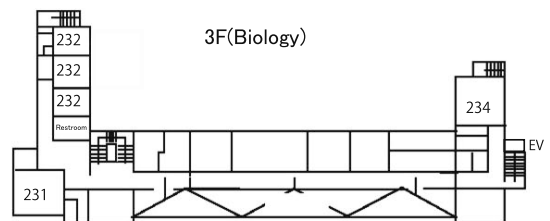
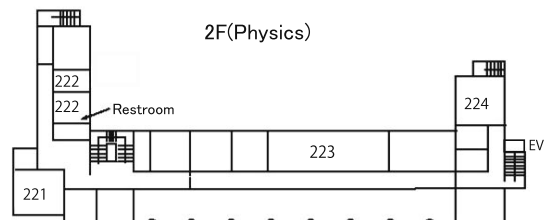
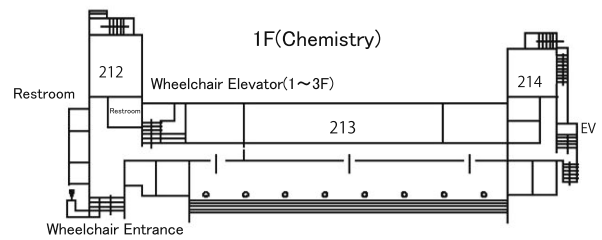

[Hiyoshi Campus Map]

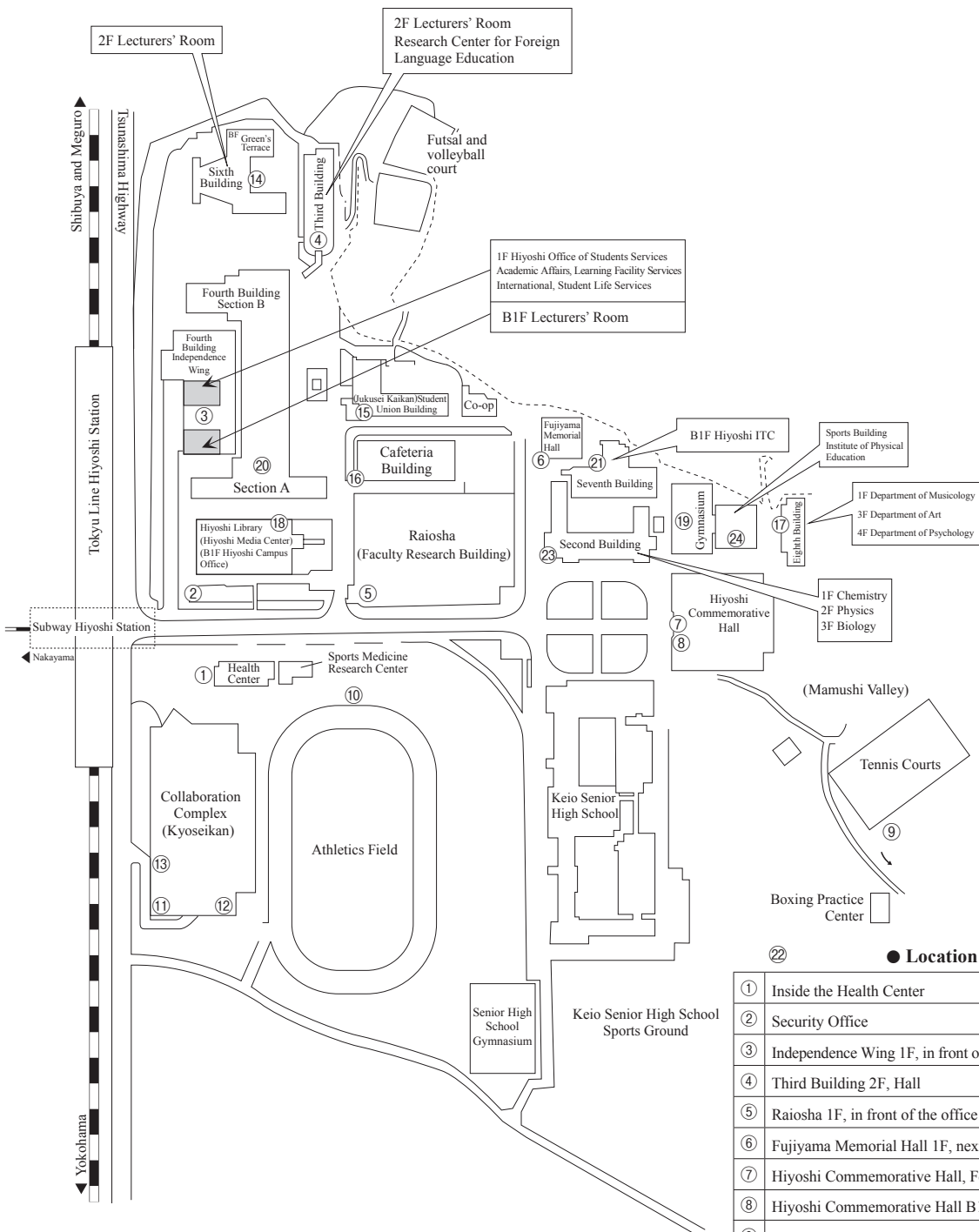

● Location of AEDs	
①	Inside the Health Center
②	Security Office
③	Independence Wing 1F, in front of the Office of Student Services
④	Third Building 2F, Hall
⑤	Raiosha 1F, in front of the office
⑥	Fujiyama Memorial Hall 1F, next to the stairs
⑦	Hiyoshi Commemorative Hall, Foyer
⑧	Hiyoshi Commemorative Hall B1, Arena
⑨	Mamushi Valley Shower Rooms, in front of the men's showers
⑩	Athletics Field facility building 1F
⑪	Collaboration Complex (Kyoseikan) 1F Security Center
⑫	Collaboration Complex (Kyoseikan), underground university fitness facility entrance
⑬	Collaboration Complex (Kyoseikan) 7F, Hall in front of the elevator
⑭	Sixth Building 1F, entrance hall
⑮	Jukusei Kaikan Student Union Building 1F (Extracurricular facilities building)
⑯	Cafeteria Building student plaza (inner courtyard), side entrance
⑰	Eighth Building 1F, glass entrance
⑱	Library (Media Center) 1F, reception counter
⑲	Gymnasium (Judo hall), Hiyoshi Commemorative Hall, annex entrance
⑳	Fourth Building Section A 1F, entrance hall
㉑	Seventh Building 1F, front entrance
㉒	Mamushi Valley Gymnasium, entrance hall
㉓	Second Building 1F, glass entrance
㉔	Sports Building, entrance

As of April 2023