

FALL 2020
FACULTY OF ECONOMICS PEARL
TIMETABLE
FIRST YEAR

Notes

1. Please pay attention and do not confuse course registration numbers with classroom numbers.
2. Half-year intensive courses have two classes per week, for example, English Academic Skills. For these courses, the same course registration number is printed for both classes.
For intensive course registration, if you enter the registration number, you will be registered for both classes automatically.
3. Important announcements from the university will be posted on the Faculty of Economics bulletin board, the common bulletin board, and/or the website. Also, there will be notices posted at these locations if there are any classroom changes in the middle of the year or temporary classroom changes. It is your responsibility to check the bulletin boards and website regularly so as not to miss notices.
4. Any results in courses you have not registered for will be invalid, even if you take the exams or submit assignments.

*** URL (Academic Affairs Web System) for course registration**

<http://keio.jp/> > The Academic Affairs Web System

		1 : 9 : 00 ~ 10 : 30					2 : 10 : 45 ~ 12 : 15				
		Lecturer	Cls	Reg. No.	Courses	Room	Lecturer	Cls	Reg. No.	Courses	Room
Mon	FOREIGN LANGUAGES										
	GENERAL EDUCATION (CATEGORY 1)										
	GENERAL EDUCATION (CATEGORY 1)	KIBATA, MIO		31348	【Fa】 HEALTH AND HUMAN PERFORMANCE 1(GIC-certified courses)		KAMADA, YUMIKO		25858	【FaIn】 FINE ARTS (*)	
	GENERAL EDUCATION (CATEGORY 1)	MORITA, MAKIKO		31223	【Fa】 GERONTOLOGY 1(GIC-certified courses)		SASAKI, YUMI		36081	【FaIn】 INTERCULTURAL COMMUNICATION(*)	
Tue	FOUNDATION	SHIRATSUKA, SHIGENO R1 etc	p	19105	【Fa】 INTRODUCTION TO THE JAPANESE ECONOMY						
	MAJOR SUBJECTS						FUJIWARA, IPPEI	p	19727	【Fa】 ELEMENTARY MACROECONOMICS 1	
	GENERAL EDUCATION (CATEGORY 1)	SUZUKI, AKIHITO		22002	【Fa】 HISTORY 2(GIC-certified courses)		SUZUKI, AKIHITO		21207	【Fa】 HISTORY 2(GIC-certified courses)	
Wed	FOREIGN LANGUAGES	RAZ, DIANA M. NAKATSUGAWA, MIYUKI NOBUOKA, MARY MURPHY, KEVIN RAINE, PAUL		18094 19139 19124 24560 19143	【FaIn】 ENGLISH ACADEMIC SKILLS 1 【FaIn】 ENGLISH ACADEMIC SKILLS 1 【FaIn】 ENGLISH ACADEMIC SKILLS 1 【FaIn】 ENGLISH ACADEMIC SKILLS 1 【FaIn】 ENGLISH ACADEMIC SKILLS 1						
	GENERAL EDUCATION (CATEGORY 1)										
	GENERAL EDUCATION (CATEGORY 1)						BONZI, ALANA R. SASAKI, YUMI		21446 36081	【Fa】 CORPORATE SOCIAL RESPONSIBILITY AND ETHICS 1 【FaIn】 INTERCULTURAL COMMUNICATION(*)	
	GENERAL EDUCATION (CATEGORY 1)										
Thu	GENERAL EDUCATION (CATEGORY 1)										
Fri	FOREIGN LANGUAGES	RAZ, DIANA M. NAKATSUGAWA, MIYUKI NOBUOKA, MARY MURPHY, KEVIN RAINE, PAUL		18094 19139 19124 24560 19143	【FaIn】 ENGLISH ACADEMIC SKILLS 1 【FaIn】 ENGLISH ACADEMIC SKILLS 1 【FaIn】 ENGLISH ACADEMIC SKILLS 1 【FaIn】 ENGLISH ACADEMIC SKILLS 1 【FaIn】 ENGLISH ACADEMIC SKILLS 1						
	GENERAL EDUCATION (CATEGORY 1)						ERTL, WOLFGANG		31587	【Fa】 ETHICS 2(GIC-certified courses)	
	GENERAL EDUCATION (CATEGORY 1)						LIM, YOUNGMI		35324	【Fa】 SOCIOLOGY 1	
	GENERAL EDUCATION (CATEGORY 1)						SATOU, YUKIKO		21867	【Fa】 LIFE SCIENCE - CURRENT STATUS AND PERSPECTIVES(GIC-certified courses)	
Sat	GENERAL EDUCATION (CATEGORY 1)						NAKAYAMA, KOICHI		30815	【Fa】 TOPICS IN CONTEMPORARY BUSINESS 1(GIC-certified courses)	
	GENERAL EDUCATION (CATEGORY 1)										

[Notes]:

【Fa】 : course offered in the Fall Semester

【FaIn】 : intensive course offered in the Fall Semester

→ : courses offered from preceding period

(GIC-certified courses): course not only for PEARL students whose main language of instruction is English, but also for students who take mainly courses with Japanese as the main language of instruction

- INTENSIVE JAPANESE classes are offered at Mita Campus.

- If you've got a credit from "INTRODUCTION TO JAPANESE ARTS AND CULTURE" in your previous year, "THEORY OF ARTS AND CULTURE 2" is not available since their contents are same.

3 : 13 : 00 ~ 14 : 30					4 : 14 : 45 ~ 16 : 15					5 : 16 : 30 ~ 18 : 00				
Lecturer	Cls	Reg. No.	Courses	Room	Lecturer	Cls	Reg. No.	Courses	Room	Lecturer	Cls	Reg. No.	Courses	Room
ISHINO, YURIKO		94000	[Fa] INTENSIVE JAPANESE 1A		ISHINO, YURIKO		94014	[Fa] INTENSIVE JAPANESE 4A		MCCOY, DAVIDH BREFUEL, ROMUALD MATSUKAWA, IKUYO MATSUKAWA, KOSUKE ONO, NAOMI		19158 19215 19550 19253 32636	[Fa] GERMAN 1A [Fa] FRENCH 3A [Fa] CHINESE 2A [Fa] SPANISH 1A [Fa] JAPANESE 1A	
AOKI, KENICHIRO		43190	[Fa] NATURAL SCIENCES 1							OBATA, RIKI		22127	[Fa] SCIENCE AND THE ENVIRONMENT1 (GIC-certified courses)	
NOTTER, DAVID M.		27698	[FaIn] HISTORICAL SOCIOLOGY(*)							GORSHKOV, VICTOR		31132	[Fa] TOPICS IN CONTEMPORARY BUSIN ESS 1(GIC-certified courses)	
TSUDA, MAYUMI etc		43682	[Fa] THEORY OF ARTS AND CULTURE 2 (GIC-certified courses)											
SUZUKI, AKIHITO		36301	[Fa] GENERAL EDUCATION SEMINAR(GI C-certified courses)(*)											
MIGAKURA, DAISUKE etc	p	19378	[Fa] STATISTICS 1		DIROMATHIDES, CATHER INE		19086	[Fa] LINEAR ALGEBRA						
										FOSTER, PATRICK J		31261	[Fa] SCIENCE AND THE ENVIRONMENT1 (GIC-certified courses)	
HAYASHI, JUNKO		92891	[Fa] INTENSIVE JAPANESE 2A		HAYASHI, JUNKO		94033	[Fa] INTENSIVE JAPANESE 5A		MCCOY, DAVIDH SAUVEGRAIN, SYLVAIN ZHOU, YUAN MATSUKAWA, KOSUKE AKISADA, MIHO		19162 19196 19564 19268 32660	[Fa] GERMAN 2A [Fa] FRENCH 2A [Fa] CHINESE 3A [Fa] SPANISH 2A [Fa] JAPANESE 3A	
FLACHI, ANTONINO		22074	[Fa] SCIENCE AND THE ENVIRONMENT2 (GIC-certified courses)											
NOTTER, DAVID M.		27698	[FaIn] HISTORICAL SOCIOLOGY(*)							VOGL, WALTER		24627	[Fa] LITERATURE 2(GIC-certified c ourses)	
					KAWASHITA, MASAKAZU		21470	[Fa] SCIENCE AND THE ENVIRONMENT2						
MURAKAMI, AYANO		94048	[Fa] INTENSIVE JAPANESE 3A		MURAKAMI, AYANO TAKAHASHI, KEIKO		94052 28785	[Fa] INTENSIVE JAPANESE 6A [Fa] JAPANESE 5A		DEGEN, RALPH HAYASHIDA, AI LIAN, SHU BARBASSO ROMERO, VI CTORH MIYAMOTO, HANA E		19177 19181 19545 19712 32655	[Fa] GERMAN 3A [Fa] FRENCH 1A [Fa] CHINESE 1A [Fa] SPANISH 3A [Fa] JAPANESE 2A	
					MARUYA, KAZUSHI		36043	[Fa] PSYCHOLOGY 1						
					BAI, YINGJIU		47893	[Fa] GEOGRAPHY2(GIC-certified cou rses)		BENNETT, ALEXANDER C.		21910	[Fa] AREA STUDIES ON CULTURE 1(GI C-certified courses)	
TOYODA, KENSUKE		22131	[Fa] SCIENCE AND THE ENVIRONMENT2 (GIC-certified courses)											
WEBSTER, DANIEL J		22280	[Fa] LITERATURE 1(GIC-certified c ourses)											
OMAE, KEIICHIRO		31185	[Fa] TOPICS IN CONTEMPORARY BUSIN ESS 2(GIC-certified courses)											
TOMIDA, HIROKO		22552	[Fa] SEX ROLES AND STATUS(GIC- ertified courses)											

• In order to register courses listed in the above timetable, please register through the Academic Affairs Web System and select column A.

• In order to register courses for type A/B students instructed in Japanese excluding courses offered by various research institutes and other faculties, please consult with the Office of Student Services. It is not possible to register these courses through the Academic Affairs Web System. Dates and periods of those courses can be found on the timetable for type AB students. These credits are counted as Optional Subjects.

• The office will inform students who have not completed "English Academic Skills 1" of which class to take to re-register for the course. Applicable students should check "Message" on keio.jp.

• Adjustments will be made to a course if there are a particularly large number of students registering for it. (Highly possible for the course *.)

• If the course is conducted on site, check the Keio University Student Website or "News" on keio.jp for the classroom.

Course Timetable for the Various Research Centers and Institutes at Hiyoshi

There are different course registration procedures for the various research centers and institutes. Carefully read the course descriptions, syllabi online and relative documents.

Credits for these courses are counted as Electives (Non-specific) credits.

• Courses offered by the Institute of Physical Education

It is possible to take the same course (sport) multiple times.

In order to register for the following courses, please select column A.

For procedures to course registration, please refer to the "News" on keio.jp.

Course	Lecturer	Semester	Day/Period	Registration No.	Classroom
PHYSICAL ACTIVITY A (TENNIS)	SAKAI, TOSHIAKI	Fall	Wed/2	66821	Online
PHYSICAL ACTIVITY A (SWIMMING)	TORIUMI, TAKASHI	Fall	Thur/3	00409	Kyoseikan Swimming Pool

		1st period	2nd period	3rd period	4th period	5th period
Mon.	Reg. No					
	Course Name					
	Lecturer					
	Room					
	Credits					
	Field					
Tues.	Reg. No					
	Course Name					
	Lecturer					
	Room					
	Credits					
	Field					
Wed.	Reg. No					
	Course Name					
	Lecturer					
	Room					
	Credits					
	Field					
Thurs.	Reg. No					
	Course Name					
	Lecturer					
	Room					
	Credits					
	Field					
Fri.	Reg. No					
	Course Name					
	Lecturer					
	Room					
	Credits					
	Field					
Sat.	Reg. No					
	Course Name					
	Lecturer					
	Room					
	Credits					
	Field					

Number of Credits for the Fall Semester
 _____ credits in total
 Max credits for a full year
 (2020 Fall Sem. + 2021 Spring Sem.): 48
 credits

MEMO

MEMO

Classroom Map

【Fujiyama Memorial Hall】

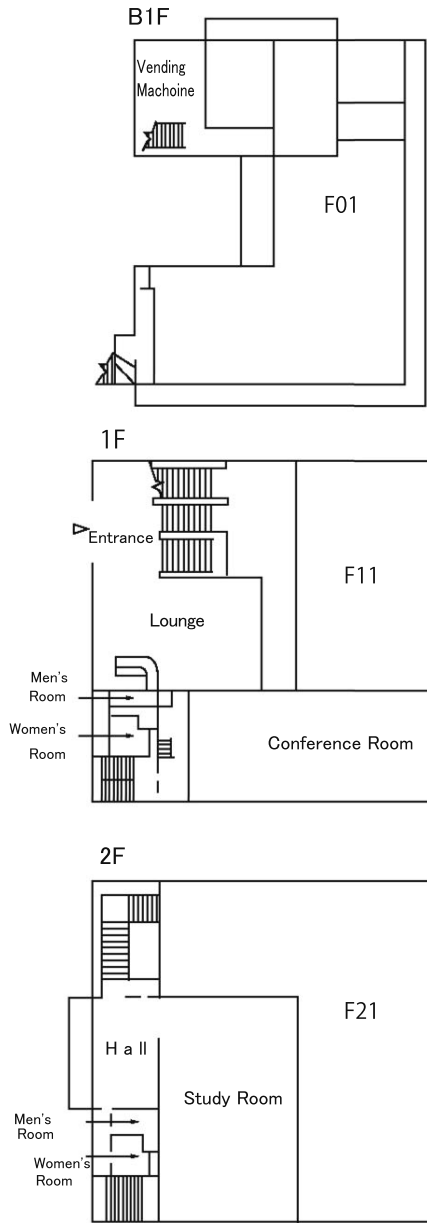

【Fourth Building Independence Wing】

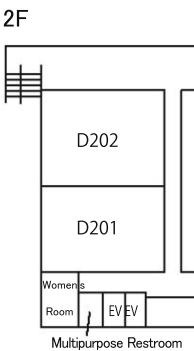
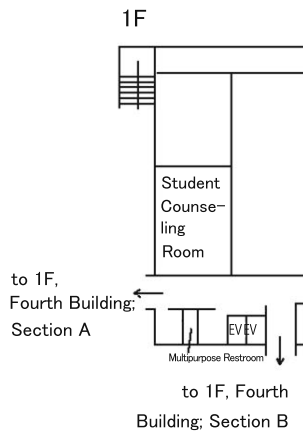
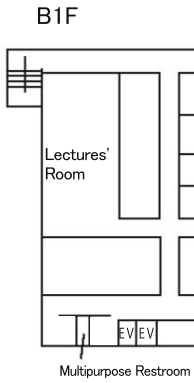
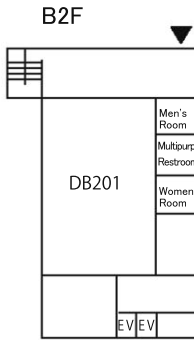
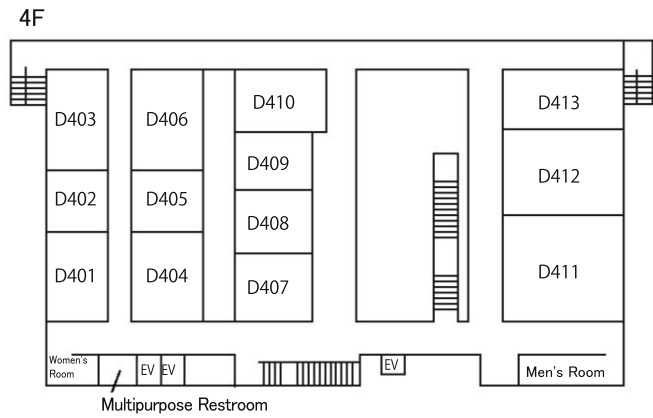
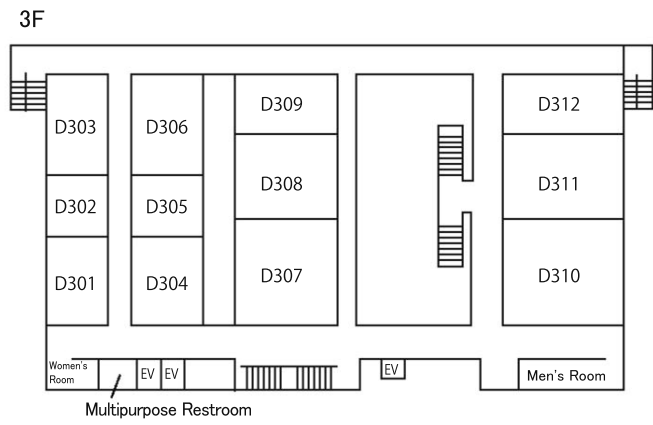

【Fourth Building General View】

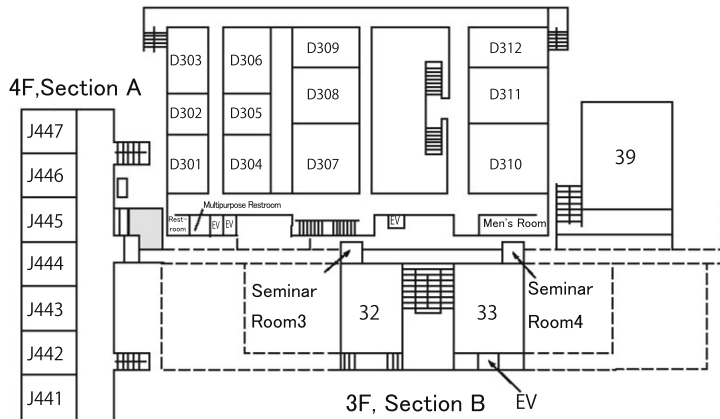
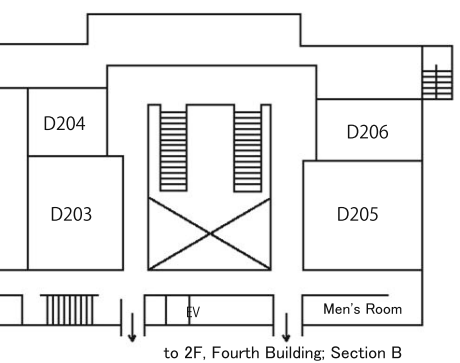
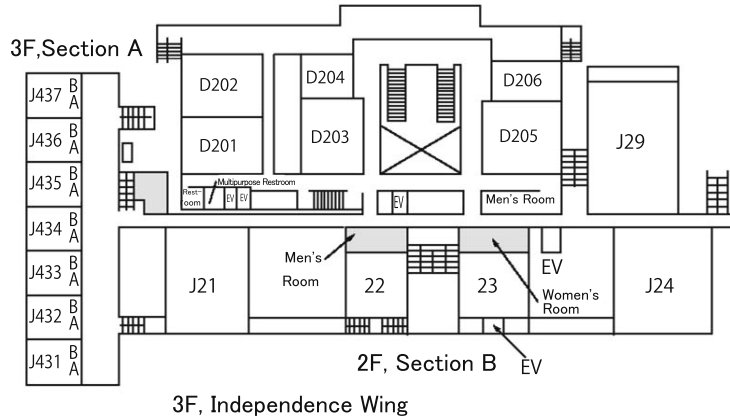
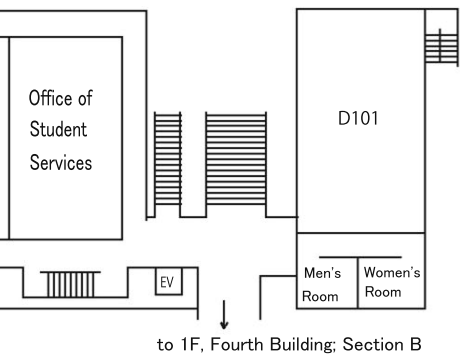
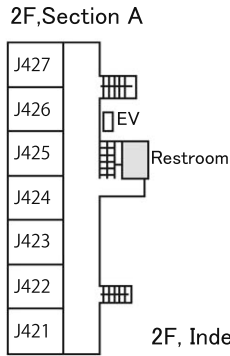
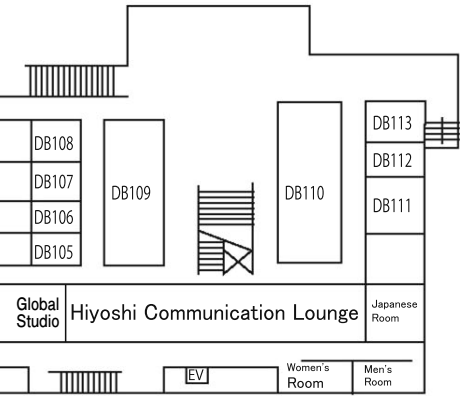
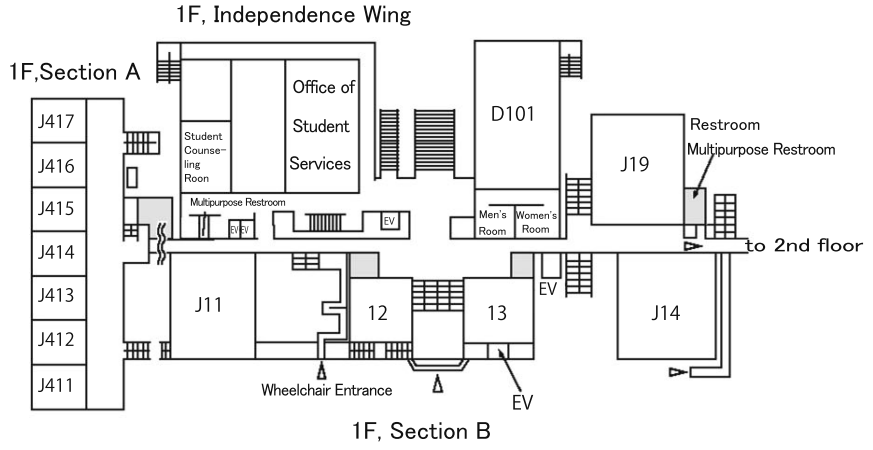
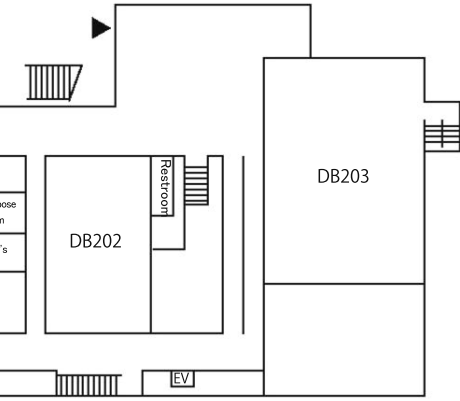

【Eighth Building】

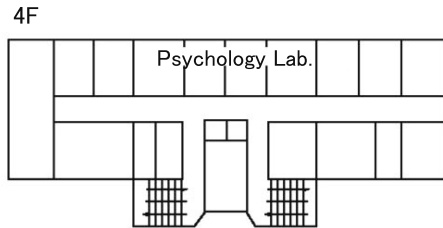
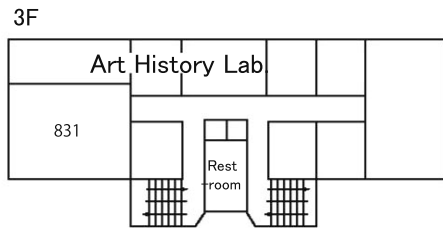
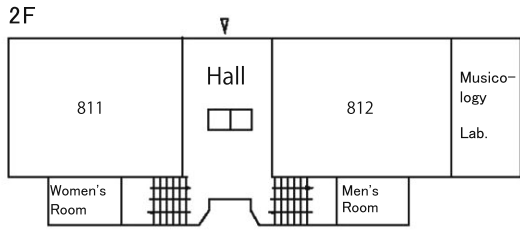

【Seventh Building】

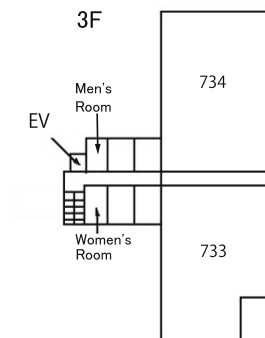
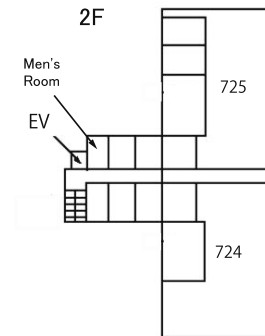
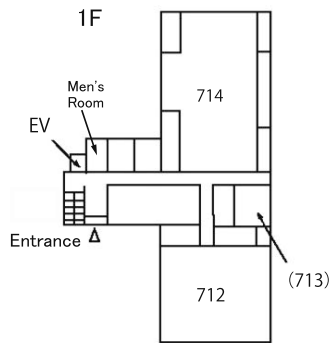
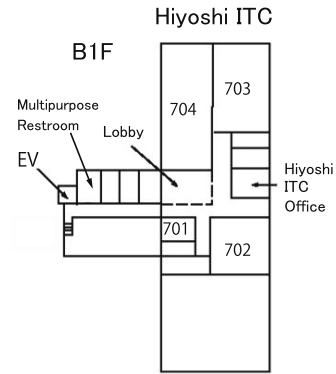

【Sixth Building】

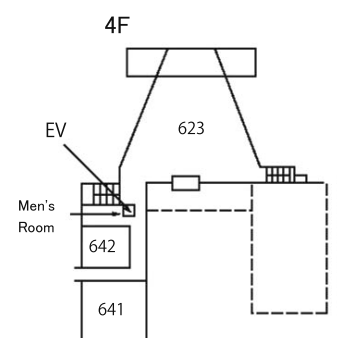
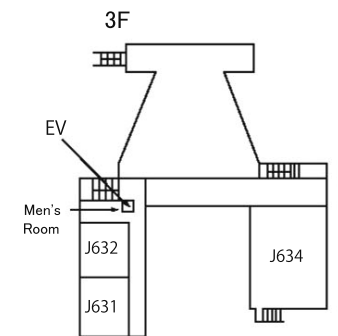
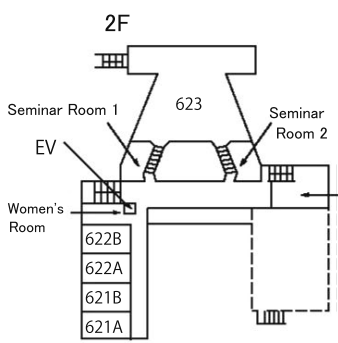
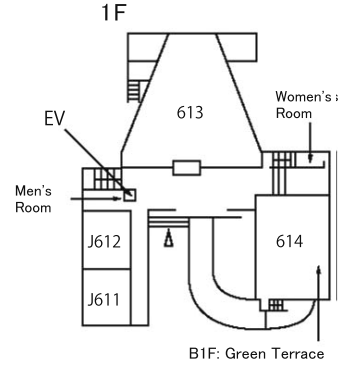

【Third Building】

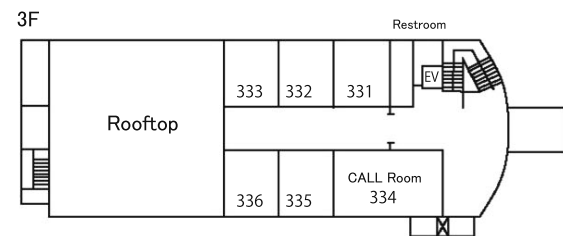
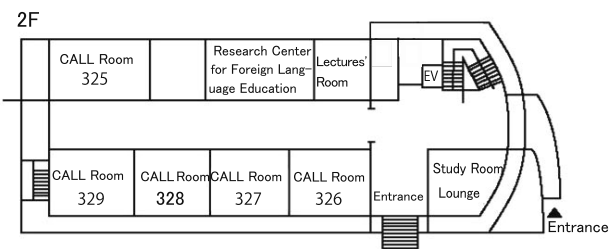
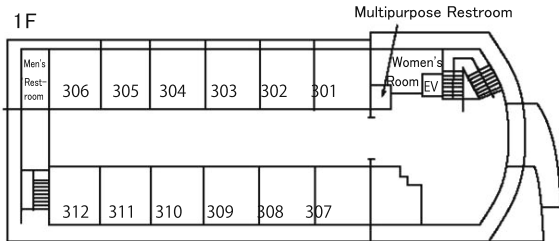

【Second Building】

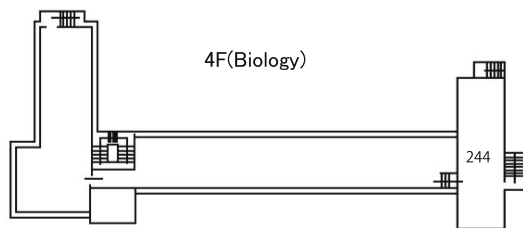
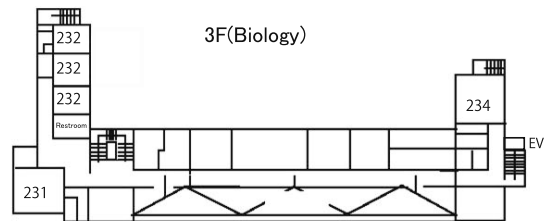
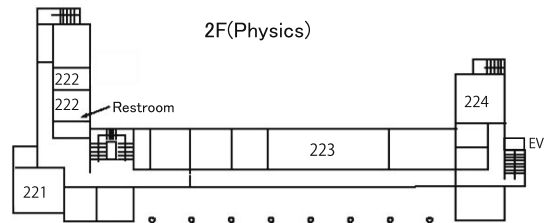
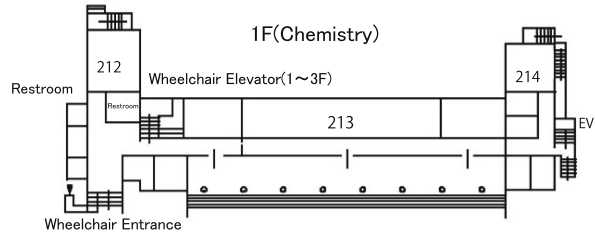

[Hiyoshi Campus Map]

