

FALL 2020
FACULTY OF ECONOMICS PEARL
TIMETABLE
SECOND YEAR

Notes

1. Please pay attention and do not confuse course registration numbers with classroom numbers.
2. Half-year intensive courses have two classes per week, for example, English Academic Skills. For these courses, the same course registration number is printed for both classes.
For intensive course registration, if you enter the registration number, you will be registered for both classes automatically.
3. Important announcements from the university will be posted on the Faculty of Economics bulletin board, the common bulletin board, and/or the website. Also, there will be notices posted at these locations if there are any classroom changes in the middle of the year or temporary classroom changes. It is your responsibility to check the bulletin boards and website regularly so as not to miss notices.
4. Any results in courses you have not registered for will be invalid, even if you take the exams or submit assignments.

*** URL (Academic Affairs Web System) for course registration**

<http://keio.jp/> > The Academic Affairs Web System

		1 : 9 : 00 ~ 10 : 30					2 : 10 : 45 ~ 12 : 15				
		Lecturer	Cls	Reg. No.	Courses	Room	Lecturer	Cls	Reg. No.	Courses	Room
Mon	FOREIGN LANGUAGES										
	FOUNDATION ELECTIVE GENERAL EDUCATION (CATEGORY I)						OKONOMIDES, CATHERINE		26615	[Fa] CALCULUS	
	GENERAL EDUCATION (CATEGORY I)	KIBATA, MIO		31348	[Fa] HEALTH AND HUMAN PERFORMANCE 1(GIC-certified courses)		KAMADA, YUMIKO SASAKI, YUMI		25858 36081	[FaIn] FINE ARTS(*) [FaIn] INTERCULTURAL COMMUNICATION(*)	
	GENERAL EDUCATION (CATEGORY I)	MORITA, MAKIKO		31223	[Fa] GERONTOLOGY 1(GIC-certified courses)						
Tue	MAJOR SUBJECTS										
	GENERAL EDUCATION (CATEGORY I)										
	GENERAL EDUCATION (CATEGORY I)	SUZUKI, AKIHITO FUSE, TSUTOMU		22002 28216	[Fa] HISTORY 2(GIC-certified courses) [Fa] HEALTH AND HUMAN PERFORMANCE 1(GIC-certified courses)		SUZUKI, AKIHITO		21207	[Fa] HISTORY 2(GIC-certified courses)	
Wed	FOREIGN LANGUAGES										
	GENERAL EDUCATION (CATEGORY I)										
	GENERAL EDUCATION (CATEGORY I)						BONZI, ALANA R. SASAKI, YUMI		21446 36081	[Fa] CORPORATE SOCIAL RESPONSIBILITY AND ETHICS 1 [FaIn] INTERCULTURAL COMMUNICATION(*)	
Thu	MAJOR SUBJECTS	HOKARI, TORU	P	25513	[Fa] INTRODUCTION TO MICROECONOMICS 1		YAGYU, TOMOKO	P	25528	[Fa] ELEMENTARY ECONOMIC HISTORY 1	
	GENERAL EDUCATION (CATEGORY I)										
Fri	FOREIGN LANGUAGES										
	MAJOR SUBJECTS						IKEDA, YUKIHIRO		25260	[Fa] INTRODUCTION TO THE HISTORY OF ECONOMIC THOUGHT 1	
	GENERAL EDUCATION (CATEGORY I)						ERTL, WOLFGANG		31587	[Fa] ETHICS 2(GIC-certified courses)	
Sat	GENERAL EDUCATION (CATEGORY I)						LIM, YOUNGMI		35324	[Fa] SOCIOLOGY 1	
	GENERAL EDUCATION (CATEGORY I)						SATOU, YUKIKO		21867	[Fa] LIFE SCIENCE - CURRENT STATUS AND PERSPECTIVES(GIC-certified courses)	
	GENERAL EDUCATION (CATEGORY I)						NAKAYAMA, KOICHI		30815	[Fa] TOPICS IN CONTEMPORARY BUSINESS 1(GIC-certified courses)	

[Notes]:

[Fa] : course offered in the Fall Semester

[FaIn] : intensive course offered in the Fall Semester

→ : courses offered from preceding period

(GIC-certified courses): course not only for PEARL students whose main language of instruction is English, but also for students who take mainly courses with Japanese as the main language of instruction

- INTENSIVE JAPANESE classes for second year students are offered at Hiyoshi Campus.

- If you've got a credit from "INTRODUCTION TO JAPANESE ARTS AND CULTURE" in your previous year, "THEORY OF ARTS AND CULTURE 2" is not available since their contents are same.

3 : 13 : 00 ~ 14 : 30				4 : 14 : 45 ~ 16 : 15				5 : 16 : 30 ~ 18 : 00						
Lecturer	Cls	Reg. No.	Courses	Room	Lecturer	Cls	Reg. No.	Courses	Room	Lecturer	Cls	Reg. No.	Courses	Room
HAYASHI, KAORI		28790	[Fa] INTENSIVE JAPANESE 7A		MCCOY, DAVIDH NARAGAWA, MACHIKO LI, JINJIA MATSUKAWA, KOSUKE ONO, NAOMI HAYASHI, KAORI		15659 15663 15678 15682 16469 28804	[FaIn] GERMAN 4A [FaIn] FRENCH 4A [FaIn] CHINESE 4A [FaIn] SPANISH 4A [FaIn] JAPANESE 4A [Fa] INTENSIVE JAPANESE 10A						
AOKI, KENICHIRO		43190	[Fa] NATURAL SCIENCES 1							OBATA, RIKA		22127	[Fa] SCIENCE AND THE ENVIRONMENT1 (GIC-certified courses)	
NOTTER, DAVID M.		27698	[FaIn] HISTORICAL SOCIOLOGY(*)							GORSHKOV, VICTOR		31132	[Fa] TOPICS IN CONTEMPORARY BUSINESS 1(GIC-certified courses)	
TSUDA, MAYUMI etc		43682	[Fa] THEORY OF ARTS AND CULTURE 2 (GIC-certified courses)											
SUZUKI, AKIHITO		36301	[Fa] GENERAL EDUCATION SEMINAR(GIC-certified courses) (*)											
					BERKENZIE, COLIN R		25480	[Fa] INTRODUCTION TO ECONOMETRICS		OHNISHI, HIROSHI SASAHARA, AKIRA		25642 42758	[Fa] MARXIAN ECONOMICS 1 [Fa] ECONOMIES AND SOCIETIES IN GLOBALIZATION	
										POSTER, PATRICK J		31261	[Fa] SCIENCE AND THE ENVIRONMENT1 (GIC-certified courses)	
					MCCOY, DAVIDH SAUVEGRAIN, SYLVAIN LI, JINJIA MATSUKAWA, KOSUKE AKISADA, MIHO ISHIZUKA, KYOKO		15659 15663 15678 15682 16469 28819	[FaIn] GERMAN 4B [FaIn] FRENCH 4B [FaIn] CHINESE 4B [FaIn] SPANISH 4B [FaIn] JAPANESE 4B [Fa] INTENSIVE JAPANESE 8A		ISHIZUKA, KYOKO		29155	[Fa] INTENSIVE JAPANESE 11A	
FLACHI, ANTONINO		22074	[Fa] SCIENCE AND THE ENVIRONMENT2 (GIC-certified courses)											
NOTTER, DAVID M.		27698	[FaIn] HISTORICAL SOCIOLOGY(*)							VOGL, WALTER		24627	[Fa] LITERATURE 2(GIC-certified courses)	
					KAWASHITA, MASAKAZU		21470	[Fa] SCIENCE AND THE ENVIRONMENT2						
MIYAMOTO, HANAE		28895	[Fa] INTENSIVE JAPANESE 9A		MIYAMOTO, HANAE TAKAHASHI, KEIKO		28900 28785	[Fa] INTENSIVE JAPANESE 12A [Fa] JAPANESE 5A						
					MARUYA, KAZUSHI BAI, YINGJIU		36043 47893	[Fa] PSYCHOLOGY 1 [Fa] GEOGRAPHY2(GIC-certified courses)		BENNETT, ALEXANDER C.		21910	[Fa] AREA STUDIES ON CULTURE 1(GIC-certified courses)	
TOYODA, KENSUKE		22131	[Fa] SCIENCE AND THE ENVIRONMENT2 (GIC-certified courses)											
WEBSTER, DANIEL J		22280	[Fa] LITERATURE 1(GIC-certified courses)											
OMAE, KEIICHIRO		31185	[Fa] TOPICS IN CONTEMPORARY BUSINESS 2(GIC-certified courses)											
TOMIDA, HIROKO		22552	[Fa] SEX ROLES AND STATUS(GIC-certified courses)											

• In order to register courses listed in the above timetable, please register through the Academic Affairs Web System and select column A.

• In order to register courses for type A/B students instructed in Japanese excluding courses offered by various research institutes and other faculties, please consult with the Office of Student Services. It is not possible to register these courses through the Academic Affairs Web System. Dates and periods of those courses can be found on the timetable for type AB students. These credits are counted as Optional Subjects.

• Adjustments will be made to a course if there are a particularly large number of students registering for it. (Highly possible for the course *.)

• If the course is conducted on site, check the Keio University Student Website or "News" on keio.jp for the classroom.

Course Timetable for the Various Research Centers and Institutes

There are different course registration procedures for the various research centers and institutes. Carefully read the course descriptions, syllabi online and relative documents.

Credits for these courses are counted as Electives (Non-specific) credits.

• Courses offered by the Institute of Physical Education

It is possible to take the same course (sport) multiple times.

In order to register for the following courses, please select column A.

For procedures to course registration, please refer to the "News" on keio.jp.

Course	Lecturer	Semester	Day/Period	Registration No.	Classroom
PHYSICAL ACTIVITY A (TENNIS)	SAKAI, TOSHIAKI	Fall	Wed/2	66821	Online
PHYSICAL ACTIVITY A (SWIMMING)	TORIUMI, TAKASHI	Fall	Thur/3	00409	Kyoseikan Swimming Pool

• Courses offered by the International Center

Courses offered by the International Center are held at Mita Campus.

When course names are the same, students are able to take only one of them even though they are taught by different lecturers.

In order to register for the following courses, please select column A.

For procedures to course registration and the results of course registration adjustment, please refer to the website:

<http://www.ic.keio.ac.jp/en/aboutic/aboutcourse/>

Timetable of Mandatory Subjects and Foundation Subjects (Elective subjects) for First-Year Students

Students who have not taken all of the mandatory subjects for the Fall Semester of the first year should check the timetable below and carry out the course registrations.

The office will inform in "Message" on keio.jp students who have not completed "English Academic Skills 1" of which class to take to re-register for the course.

Course	Lecturer	Semester	Day/Period	Registration No.
ENGLISH ACADEMIC SKILLS 1	KAZ, DIANA M.	Fall	Wed/1,Fri/1	18094
ENGLISH ACADEMIC SKILLS 1	NAKATSUGAWA, MIYUKI	Fall	Wed/1,Fri/1	19139
ENGLISH ACADEMIC SKILLS 1	NOBUOKA, MARY	Fall	Wed/1,Fri/1	19124
ENGLISH ACADEMIC SKILLS 1	MURPHY, KEVIN	Fall	Wed/1,Fri/1	24560
ENGLISH ACADEMIC SKILLS 1	RAINE, PAUL	Fall	Wed/1,Fri/1	19143
GERMAN 1A	MCCOY, DAVID H.	Fall	Mon/5	19158
GERMAN 2A	MCCOY, DAVID H.	Fall	Wed/5	19162
GERMAN 3A	DEGEN, RALPH	Fall	Fri/5	19177
FRENCH 1A	HAYASHIDA, AI	Fall	Fri/5	19181
FRENCH 2A	SAUVEGRAIN., SYLVAIN	Fall	Wed/5	19196
FRENCH 3A	BREFUEL, ROMUALD	Fall	Mon/5	19215
CHINESE 1A	LIAN, SHU	Fall	Fri/5	19545
CHINESE 2A	MATSUKAWA, IKUYO	Fall	Mon/5	19550
CHINESE 3A	ZHOU, YUAN	Fall	Wed/5	19564
SPANISH 1A	MATSUKAWA, KOSUKE	Fall	Mon/5	19253
SPANISH 2A	MATSUKAWA, KOSUKE	Fall	Wed/5	19268
SPANISH 3A	BARRASO ROMERO, VICTOR M.	Fall	Fri/5	19712
JAPANESE 1A	ONO, NAOMI	Fall	Mon/5	32636
JAPANESE 2A	MIYAMOTO, HANAE	Fall	Fri/5	32655
JAPANESE 3A	AKISADA, MIHO	Fall	Wed/5	32660
ELEMENTARY MACROECONOMICS 1	FUJIWARA, IPPEI	Fall	Tue/2	19727
INTRODUCTION TO THE JAPANESE ECONOMY	SHIRATSUKA, SHIGENORI etc	Fall	Tue/1	19105
STATISTICS 1	NAGAKURA, DAISUKE etc	Fall	Tue/3	19378

First Year Foundation Subjects (Elective subjects)

Although the course listed below is for the first year students, it is available for the second year students to take.

Course	Lecturer	Semester	Day/Period	Registration No.
LINEAR ALGEBRA	OIKONOMIDES, CATHERINE	Fall	Tue/4	19086

		1st period	2nd period	3rd period	4th period	5th period
Mon.	Reg. No					
	Course Name					
	Lecturer					
	Room					
	Credits					
	Field					
Tues.	Reg. No					
	Course Name					
	Lecturer					
	Room					
	Credits					
	Field					
Wed.	Reg. No					
	Course Name					
	Lecturer					
	Room					
	Credits					
	Field					
Thurs.	Reg. No					
	Course Name					
	Lecturer					
	Room					
	Credits					
	Field					
Fri.	Reg. No					
	Course Name					
	Lecturer					
	Room					
	Credits					
	Field					
Sat.	Reg. No					
	Course Name					
	Lecturer					
	Room					
	Credits					
	Field					

Number of Credits for the Fall Semester
 _____ credits in total
 Max credits for a full year
 (2020 Fall Sem. + 2021 Spring Sem.): 48
 credits

MEMO

Classroom Map

【Fujiyama Memorial Hall】

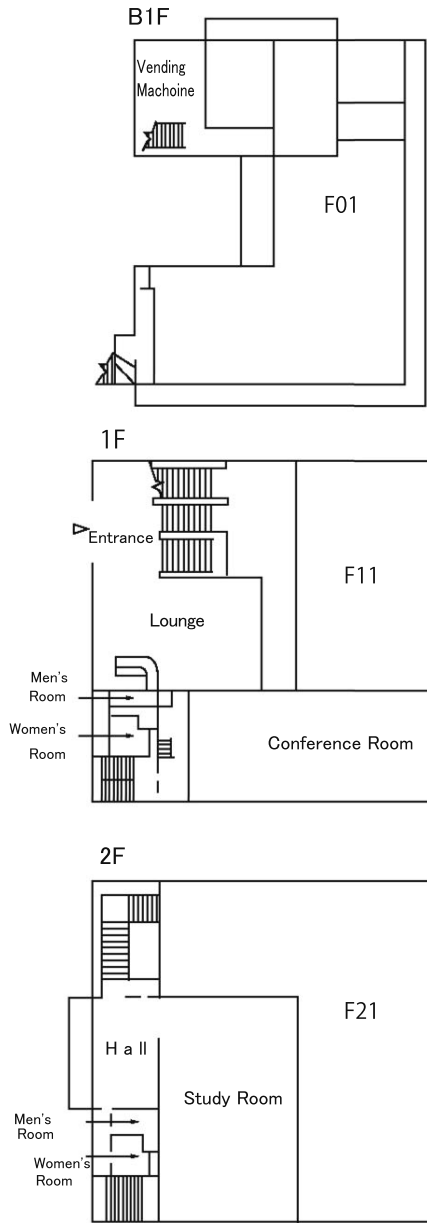

【Fourth Building Independence Wing】

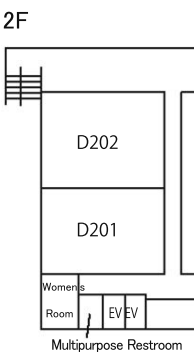
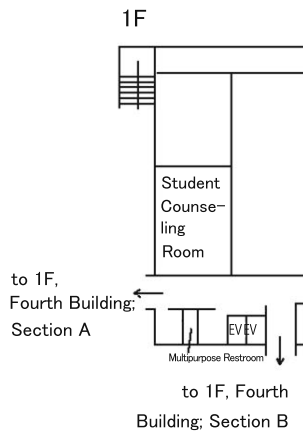
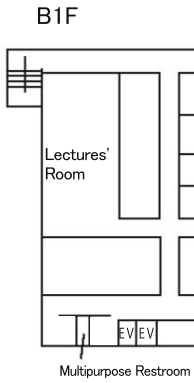
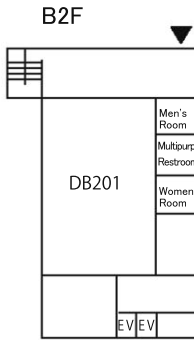
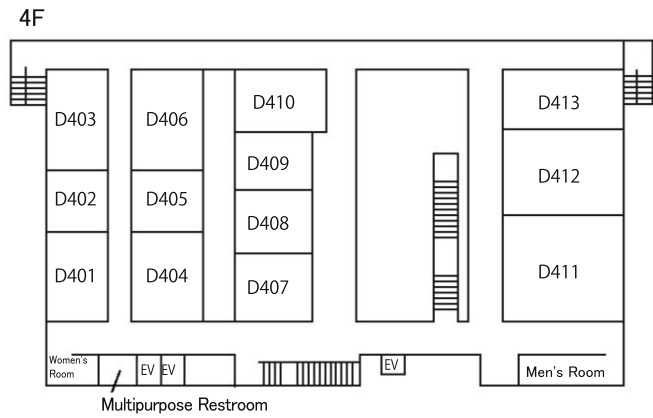
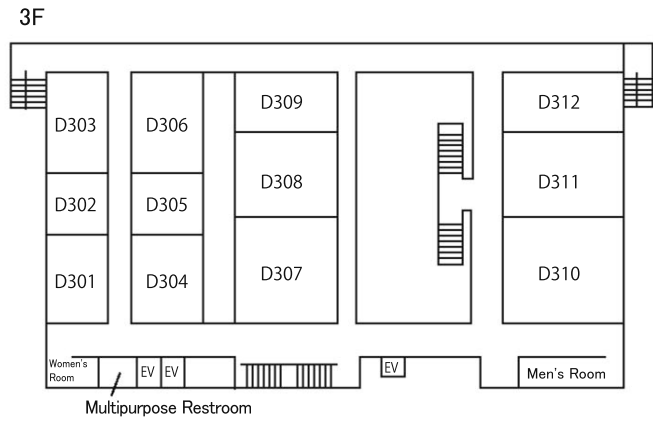

【Fourth Building General View】

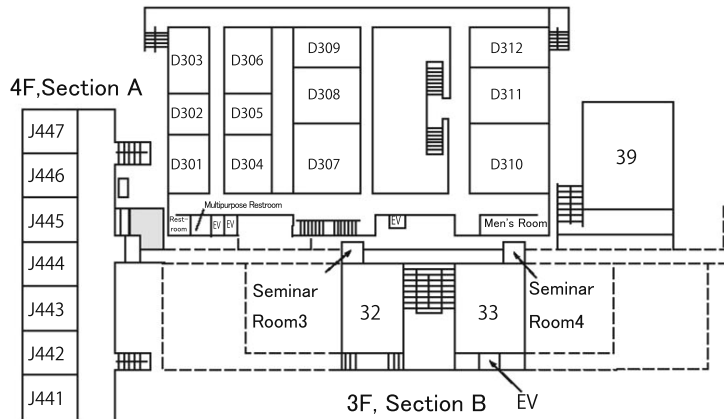
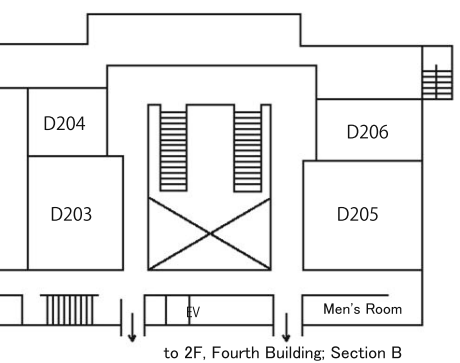
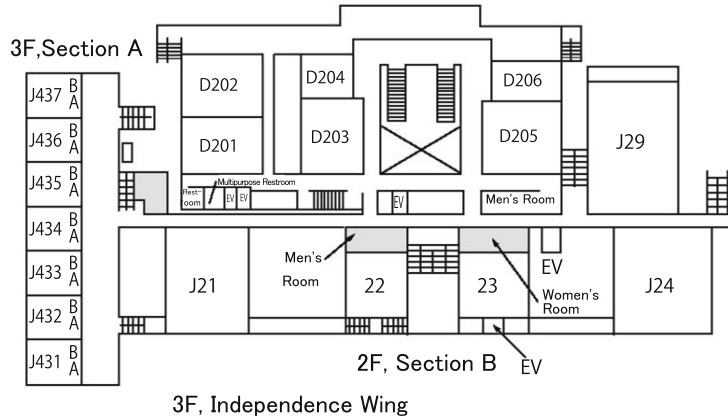
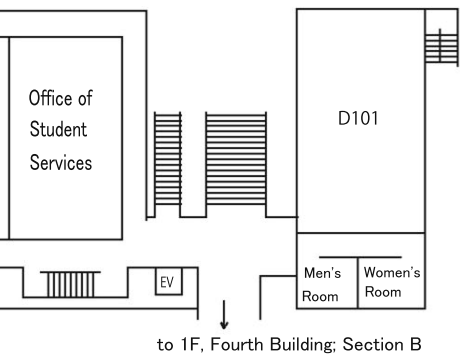
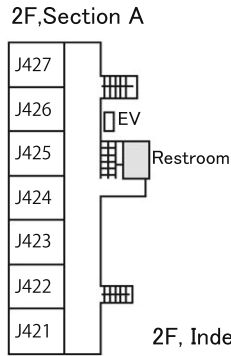
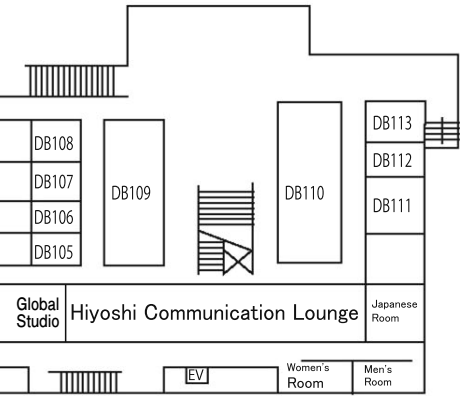
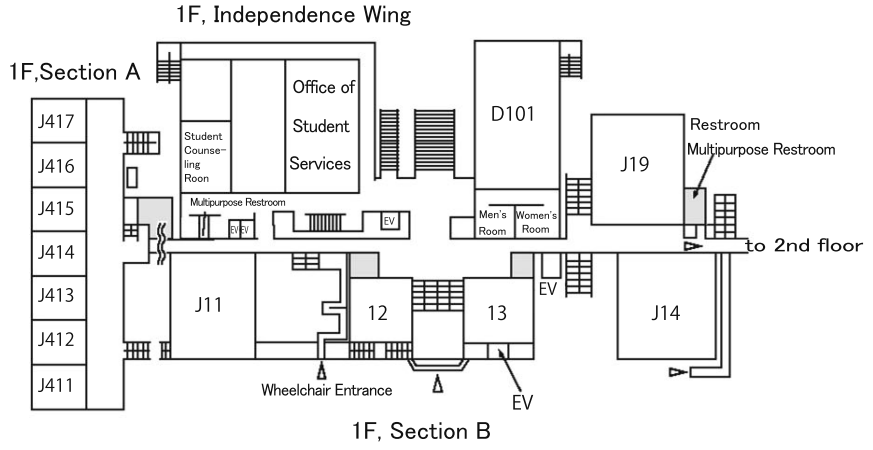
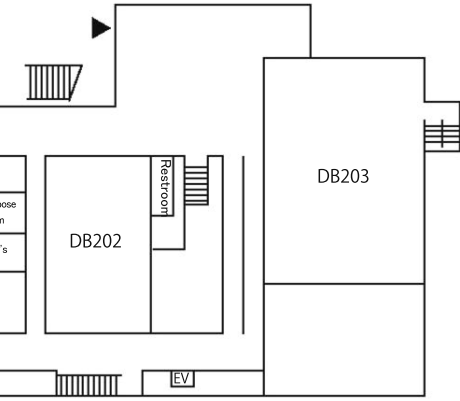

【Eighth Building】

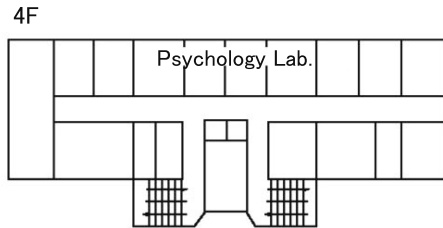
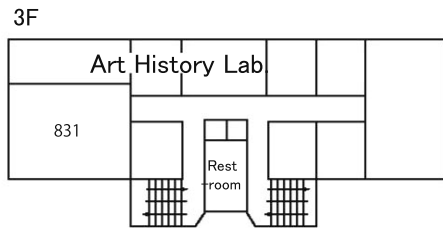
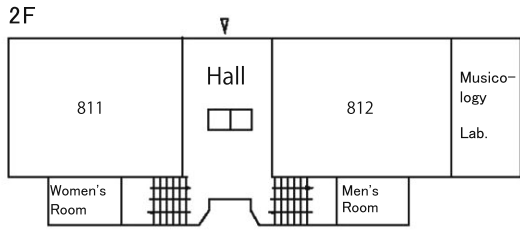

【Seventh Building】

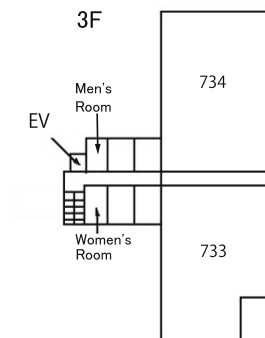
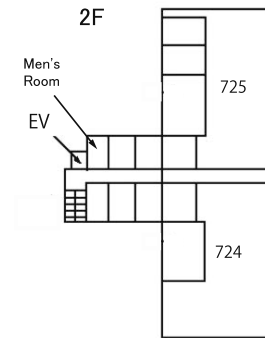
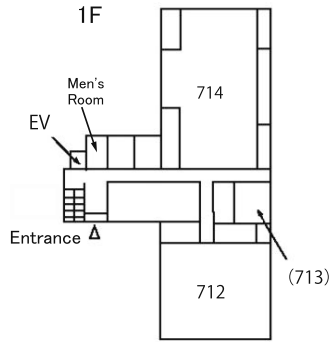
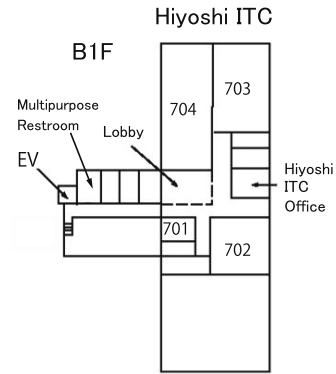

【Sixth Building】

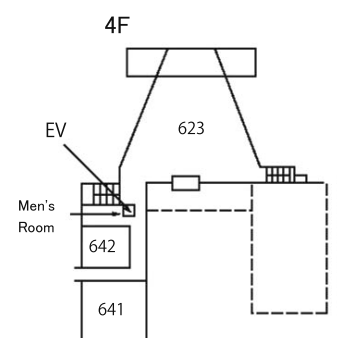
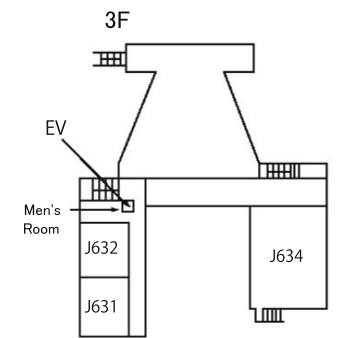
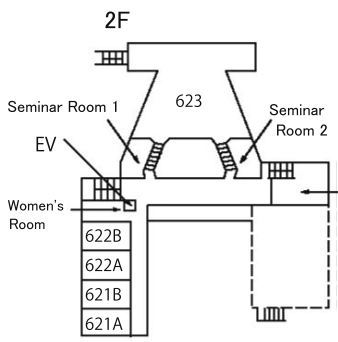
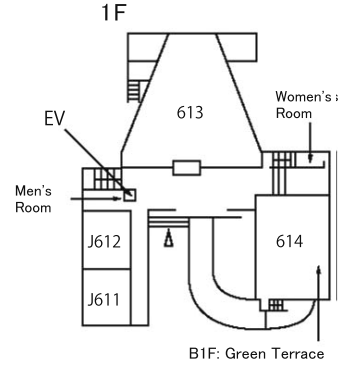

【Third Building】

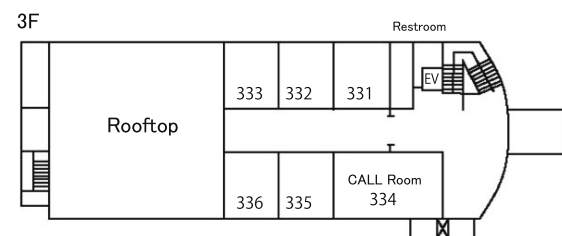
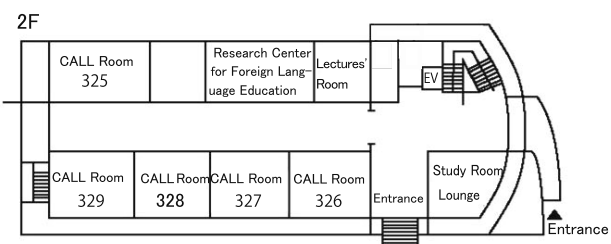
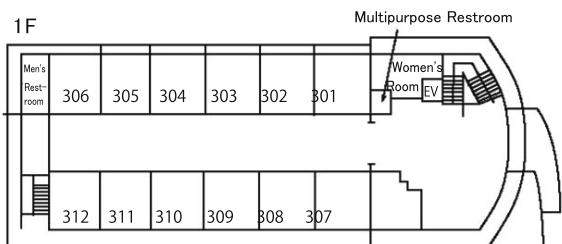

【Second Building】

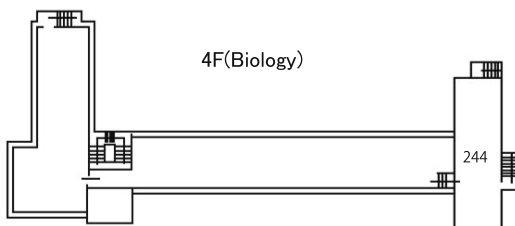
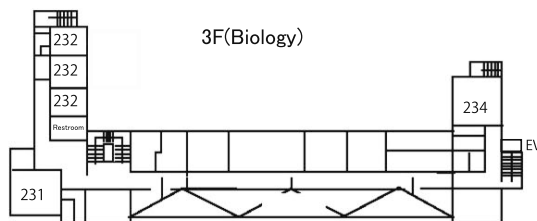
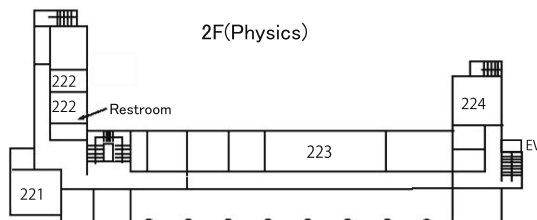
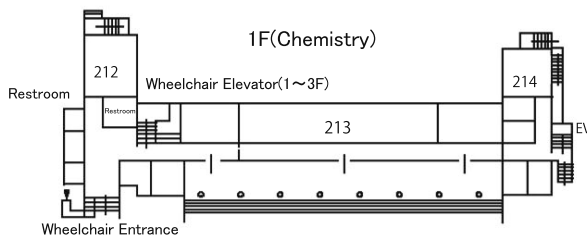

[Hiyoshi Campus Map]

