

# **FALL 2021**

## **FACULTY OF ECONOMICS PEARL**

### **TIMETABLE**

### **SECOND YEAR**

#### **Notes**

1. Please pay attention and do not confuse course registration numbers with classroom numbers.
2. Half-year intensive courses have two classes per week, for example, English Academic Skills. For these courses, the same course registration number is printed for both classes.  
For intensive course registration, if you enter the registration number, you will be registered for both classes automatically.
3. Important announcements from the university will be posted on the Keio University Student Website or "News" on keio.jp. Also, there will be notices posted at these locations if there are any classroom changes in the middle of the semester or temporary classroom changes. It is your responsibility to check the website regularly so as not to miss notices.
4. Any results in courses you have not registered for will be invalid, even if you take the exams or submit assignments.

#### **\* URL for Course Registration**

**<http://keio.jp/> > Class > Course Registration**

		1 : 9 : 00 ~ 10 : 30					2 : 10 : 45 ~ 12 : 15				
		Lecturer	Cls	Reg. No.	Courses	Room	Lecturer	Cls	Reg. No.	Courses	Room
Mon	FOREIGN LANGUAGES										
	FOUNDATION ELECTIVE GENERAL EDUCATION (CATEGORY I)						OLEONIMIDES, CATHERINE		97853	【Fa】 CALCULUS	1 2
	GENERAL EDUCATION (CATEGORY II)	KIBATA, MIO		02524	【Fa】 HEALTH AND HUMAN PERFORMANCE 1 (GIC-certified courses)		SASAKI, YUMI BATTY, ROGER M.		07033 43477	【FaIn】 INTERCULTURAL COMMUNICATION 【FaIn】 HISTORY OF WESTERN ART AND FASHION 1	
	GENERAL EDUCATION (CATEGORY III)										
Tue	MAJOR SUBJECTS										
	GENERAL EDUCATION (CATEGORY I)	HAYASHI, YOSHINOBU		07401	【Fa】 LIFE SCIENCE - CURRENT STATUS AND PERSPECTIVES (GIC-certified courses)						
	GENERAL EDUCATION (CATEGORY II)	TOMINAGA, HIROSHI FUSE, TSUTOMU		02338 99454	【Fa】 TOPICS IN CONTEMPORARY BUSINESS 2 (GIC-certified courses) 【Fa】 HEALTH AND HUMAN PERFORMANCE 1 (GIC-certified courses)						
Wed	FOREIGN LANGUAGES										
	GENERAL EDUCATION (CATEGORY I)						FLACHI, ANTONINO		93403	【Fa】 SCIENCE AND THE ENVIRONMENT 2 (GIC-certified courses)	
	GENERAL EDUCATION (CATEGORY II)						SASAKI, YUMI SUZUKI, RYOKO BOUZI, ALAVA R.		07033 01198 92775	【FaIn】 INTERCULTURAL COMMUNICATION 【FaIn】 LINGUISTICS 【Fa】 CORPORATE SOCIAL RESPONSIBILITY AND ETHICS 1	1 3
Thu	MAJOR SUBJECTS	HOKARI, TORU	P	96790	【Fa】 INTRODUCTION TO MICROECONOMICS 1		YAGU, TOMOKO	P	96804	【Fa】 ELEMENTARY ECONOMIC HISTORY 1	
	GENERAL EDUCATION (CATEGORY I)						KAJIMURA, MAYUMI		43333	【Fa】 LIFE SCIENCE - CURRENT STATUS AND PERSPECTIVES (GIC-certified courses)	2 3 4
	GENERAL EDUCATION (CATEGORY II)	KITAHARA, HISATSUGU		99473	【Fa】 LINGUISTIC SCIENCE 2 (GIC-certified courses)						
Fri	FOREIGN LANGUAGES										
	GENERAL EDUCATION (CATEGORY II)						ERTL, WOLFGANG SUZUKI, RYOKO LIM, YOUNGHI		02744 01198 06314	【Fa】 ETHICS 2 (GIC-certified courses) 【FaIn】 LINGUISTICS 【Fa】 SOCIOLOGY 1	1 2
Sat	GENERAL EDUCATION (CATEGORY I)										
	GENERAL EDUCATION (CATEGORY II)						NAKAYAMA, KOICHI		01987	【Fa】 TOPICS IN CONTEMPORARY BUSINESS 1 (GIC-certified courses)	D 2 0 5

**[Notes]:**

**【Fa】** : course offered in the Fall Semester

**【FaIn】**: intensive course offered in the Fall Semester

→ : courses offered from preceding period

(GIC-certified courses): course not only for PEARL students whose main language of instruction is English, but also for students who take mainly courses with Japanese as the main language of instruction

•If you've got a credit from "INTRODUCTION TO JAPANESE ARTS AND CULTURE" in your previous year, "THEORY OF ARTS AND CULTURE 2" is not available since their contents are same.

3 : 13 : 00 ~ 14 : 30					4 : 14 : 45 ~ 16 : 15					5 : 16 : 30 ~ 18 : 00				
Lecturer	Cls	Reg.No.	Courses	Room	Lecturer	Cls	Reg.No.	Courses	Room	Lecturer	Cls	Reg.No.	Courses	Room
ISHIZUKA, KYOKO		99693	【Fa】 INTENSIVE JAPANESE 7A		MCCOY, DAVIDH LEBOIS, JEROME LI, JINJIA MATSUKAWA, KOSUKE ONO, NAOMI ISHIZUKA, KYOKO		12980 12994 13015 13020 13732 99708	【FaIn】 GERMAN 4A 【FaIn】 FRENCH 4A 【FaIn】 CHINESE 4A 【FaIn】 SPANISH 4A 【FaIn】 JAPANESE 4A 【Fa】 INTENSIVE JAPANESE 10A	325					
AOKI, KENICHIRO		43462	【Fa】 NATURAL SCIENCES 2	224						OBATA, RIKI		93456	【Fa】 SCIENCE AND THE ENVIRONMENT1 (GIC-certified courses)	
										TINO, YURIKO		07837	【Fa】 GENDER STUDIES 2(GIC-certified courses)	
										TSUCHIDA, HARUNOBU		93642	【Fa】 MUSIC1(GIC-certified courses)	623
TSUDA, MAYUMI BJOERK, TOVE		37920	【Fa】 THEORY OF ARTS AND CULTURE 2 (GIC-certified courses)	22										
					MCKENZIE, COLIN R OHNISHI, HIROSHI		96751 96929	【Fa】 INTRODUCTION TO ECONOMETRICS 【Fa】 MARXIAN ECONOMICS 1	641	IKEDA, YUKIHIRO SASAHARA, AKIRA		96531 37346	【Fa】 INTRODUCTION TO THE HISTORY OF ECONOMIC THOUGHT 1 【Fa】 ECONOMIES AND SOCIETIES IN GLOBALIZATION	23 13
					INOUE, SATOSHI HAYASHI, HIDEKI		93657 43242	【Fa】 MUSIC2(GIC-certified courses) 【Fa】 TOPICS IN CONTEMPORARY BUSINESS 1(GIC-certified courses)	623	HAYASHI, HIDEKI YAMAMOTO, YUKI		06534 99234	【Fa】 TOPICS IN CONTEMPORARY BUSINESS 2(GIC-certified courses) 【Fa】 SOCIOLOGY 1(GIC-certified courses)	
					MCCOY, DAVIDH SAUVEGRAIN, SYLVAIN LI, JINJIA MATSUKAWA, KOSUKE KASHIKURA, HIROMI MIYAMOTO, HANAE		12980 12994 13015 13020 13732 00058	【FaIn】 GERMAN 4B 【FaIn】 FRENCH 4B 【FaIn】 CHINESE 4B 【FaIn】 SPANISH 4B 【FaIn】 JAPANESE 4B 【Fa】 INTENSIVE JAPANESE 8A	325 D303	MIYAMOTO, HANAE		00388	【Fa】 INTENSIVE JAPANESE 11A	
FLACHI, ANTONINO		37862	【Fa】 SCIENCE AND COOKING2											
SAKO, KATSURA		93752	【Fa】 LITERATURE 2(GIC-certified courses)	13										
					KAWASHITA, MASAKAZU MARUYA, KAZUSHI		92794 06663	【Fa】 SCIENCE AND THE ENVIRONMENT2 【Fa】 PSYCHOLOGY 1		KAWASHITA, MASAKAZU		93480	【Fa】 SCIENCE AND THE ENVIRONMENT2 (GIC-certified courses)	
										NAKAYAMA, KOICHI		99143	【Fa】 TOPICS IN CONTEMPORARY BUSINESS 2(GIC-certified courses)	D205
AKISADA, MIHO		00134	【Fa】 INTENSIVE JAPANESE 9A		AKISADA, MIHO TAKAHASHI, KEIKO		00149 00024	【Fa】 INTENSIVE JAPANESE 12A 【Fa】 JAPANESE 5A						
					BATTY, ROGER M. BAI, YINGJIU		43477 42050	【FaIn】 HISTORY OF WESTERN ART AND FASHION 1 【Fa】 GEOGRAPHY2(GIC-certified courses)		GORSHKOV, VICTOR BENNETT, ALEXANDER C.		02319 93236	【Fa】 TOPICS IN CONTEMPORARY BUSINESS 1(GIC-certified courses) 【Fa】 AREA STUDIES ON CULTURE 1(GIC-certified courses)	D308
TOYODA, KENSUKE		93475	【Fa】 SCIENCE AND THE ENVIRONMENT2 (GIC-certified courses)											
OMAE, KEIICHIRO		02357	【Fa】 TOPICS IN CONTEMPORARY BUSINESS 2(GIC-certified courses)	D205										
TOMIDA, HIROKO		93881	【Fa】 SEX ROLES AND STATUS (GIC-certified courses)											

▪In order to register courses listed in the above timetable, please register through the Course Registration System and select column A.

▪If you wish to register courses for type A/B students instructed in Japanese excluding courses offered by various research institutes and other faculties, please consult with the Office of Student Services during the Course Registration Period with extra time. It is not possible to register these courses through the Course Registration System. Dates and periods of those courses can be found on the timetable for type AB students. These credits are counted as Optional Subjects.

▪Adjustments will be made to a course if there are a particularly large number of students registering for it. (Highly possible for General Education Courses, especially Intensive Courses marked as 【FaIn】.)

▪Please check the Keio University Student Website and keio.jp portal regularly as changes may be made to the class formats depending on the future situation.

# Course Timetable for the Various Research Centers and Institutes at Hiyoshi

There are different course registration procedures for the various research centers and institutes. Carefully read the course descriptions, syllabi online and relative documents.

## 1. Credits for these courses are counted as Electives (Non-specific) credits.

### • Elective (Non-specific) courses offered by the GIC Center

When course names are the same, students are only able to take one of the courses even if taught by different lecturers. In order to register for the following courses, please select column A.

Course	Lecturer	Semester	Day/Period	Registration No.	Classroom
TOPICS IN CONTEMPORARY BUSINESS 2	ISHIBASHI, MITSURU	Fall	Mon/5	91692	Online
TOPICS IN CONTEMPORARY BUSINESS 2	ISHIBASHI, MITSURU	Fall	Fri/ 5	92024	Online

### • Courses offered by the Global Research Institute

When course names are the same, students are only able to take one of the courses even if taught by different lecturers. In order to register for the following courses, please select column A.

Course	Lecturer	Semester	Day/Period	Registration No.	Classroom
EMERGING CYBER TECHNOLOGIES IMPLICATIONS AND CONSEQUENCES	FARBER,DAVID BURGERS,TOBIAS J.	Fall	Wed/5	43788	J413

### • Courses offered by the Institute of Physical Education

It is possible to take the same course (sport) multiple times.

In order to register for the following courses, please select column A.

For procedures to course registration, please refer to the "News" on keio.jp.

Course	Lecturer	Semester	Day/Period	Registration No.	Classroom
PHYSICAL ACTIVITY A (TENNIS)	SAKAI, TOSHIAKI	Fall	Wed/2	39393	Tennis Court(Mamushi Valley)
PHYSICAL ACTIVITY A (SWIMMING)	TORIUMI, TAKASHI	Fall	Thu/3	09552	Kyoseikan Swimming Pool

### • Courses offered by the International Center

Courses offered by the International Center are held at Mita Campus.

When course names are the same, students are able to take only one of them even though they are taught by different lecturers. In order to register for the following courses, please select column A.

For procedures to course registration and the results of course registration adjustment, please refer to the website:  
<http://www.ic.keio.ac.jp/en/aboutic/aboutcourse/>

## 2. Credits for these courses are counted as Optional credits.

### • Courses offered by the Keio Research Center for Foreign Language Education

Courses offered by the Keio Research Center for Foreign Language Education are normally taught in Japanese.

In order to register for the following courses, please select column A.

For procedures to course registration and the results of course registration adjustment, please refer to the website:  
<http://www.flang.keio.ac.jp/en/>

# Timetable of Mandatory Subjects and Foundation Subjects(Elective subjects) for First-Year Students

Students who have not taken all of the mandatory subjects for the Fall Semester of the first year should check the timetable below and carry out the course registrations.

The office will inform via "Message" on keio.jp students who have not completed “English Academic Skills 1” of which class to take to re-register for the course.

Course	Lecturer	Semester	Day/Period	Registration No.
ENGLISH ACADEMIC SKILLS 1	KAZ, DIANA M.	Fall	Wed/1,Fri/1	89457
ENGLISH ACADEMIC SKILLS 1	NAKATSUGAWA, MIYUKI	Fall	Wed/1,Fri/1	90495
ENGLISH ACADEMIC SKILLS 1	NOBUOKA, MARY	Fall	Wed/1,Fri/1	90476
ENGLISH ACADEMIC SKILLS 1	MURPHY, KEVIN	Fall	Wed/1,Fri/1	95831
ENGLISH ACADEMIC SKILLS 1	RAINE, PAUL	Fall	Wed/1,Fri/1	90500
GERMAN 1A	MCCOY, DAVID H.	Fall	Mon/5	90514
GERMAN 2A	MCCOY, DAVID H.	Fall	Wed/5	90529
GERMAN 3A	DEGEN, RALPH	Fall	Fri/5	90533
FRENCH 1A	HAYASHIDA, AI	Fall	Fri/5	90548
FRENCH 2A	SAUVEGRAIN., SYLVAIN	Fall	Wed/5	90552
FRENCH 3A	BREFUEL, ROMUALD	Fall	Mon/5	90567
CHINESE 1A	LIAN, SHU	Fall	Fri/5	90897
CHINESE 2A	MATSUKAWA, IKUYO	Fall	Mon/5	90901
CHINESE 3A	ZHOU, YUAN	Fall	Wed/5	90916
SPANISH 1A	MATSUKAWA, KOSUKE	Fall	Mon/5	90610
SPANISH 2A	MATSUKAWA, KOSUKE	Fall	Wed/5	90624
SPANISH 3A	MARTA, SANCHEZ BARRERA	Fall	Fri/5	91066
JAPANESE 1A	ONO, NAOMI	Fall	Mon/5	03793
JAPANESE 2A	AIGA, AYUMI	Fall	Fri/5	03808
JAPANESE 3A	AKISADA, MIHO	Fall	Wed/5	03812
ELEMENTARY MACROECONOMICS 1	FUJIWARA, IPPEI	Fall	Tue/2	91085
INTRODUCTION TO THE JAPANESE ECONOMY	SHIRATSUKA, SHIGENORI	Fall	Tue/1	90457
STATISTICS 1	NAGAKURA, DAISUKE etc	Fall	Tue/3	90404

## First Year Foundation Subjects (Elective subjects)

Although the course listed below is for the first year students, it is available for the second year students to take.

Course	Lecturer	Semester	Day/Period	Registration No.
LINEAR ALGEBRA	OIKONOMIDES, CATHERINE	Fall	Mon/1	90442

		1st period	2nd period	3rd period	4th period	5th period
Mon.	Reg. No					
	Course Name					
	Lecturer					
	Room					
	Credits					
	Field					
Tues.	Reg. No					
	Course Name					
	Lecturer					
	Room					
	Credits					
	Field					
Wed.	Reg. No					
	Course Name					
	Lecturer					
	Room					
	Credits					
	Field					
Thurs.	Reg. No					
	Course Name					
	Lecturer					
	Room					
	Credits					
	Field					
Fri.	Reg. No					
	Course Name					
	Lecturer					
	Room					
	Credits					
	Field					
Sat.	Reg. No					
	Course Name					
	Lecturer					
	Room					
	Credits					
	Field					

**Number of Credits for the Fall Semester**  
 \_\_\_\_\_ credits in total  
 Max credits for a full year  
 (2021 Fall Sem. + 2022 Spring Sem.): 48  
 credits

**MEMO**

# Classroom Map

【Fujiyama Memorial Hall】

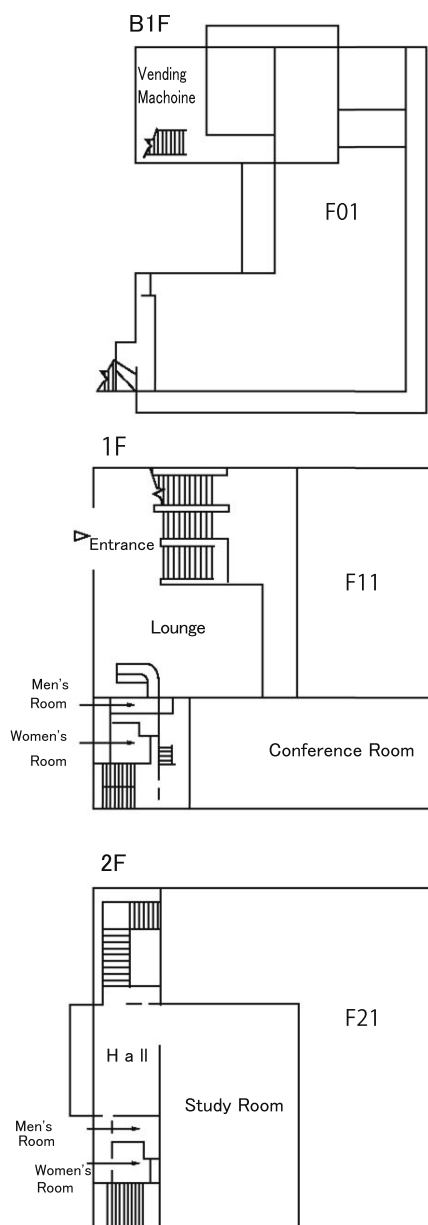

【Fourth Building Independence Wing】

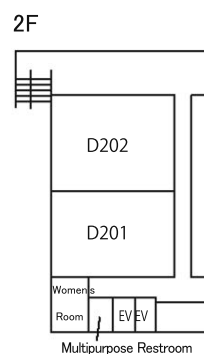
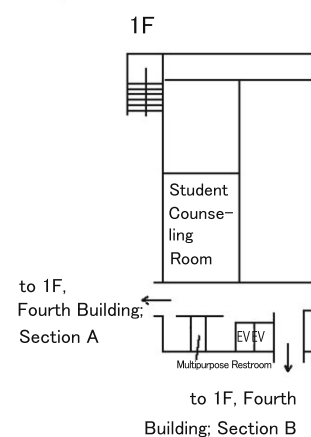
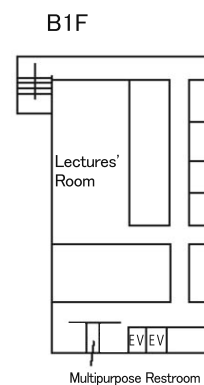
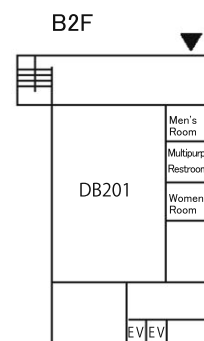
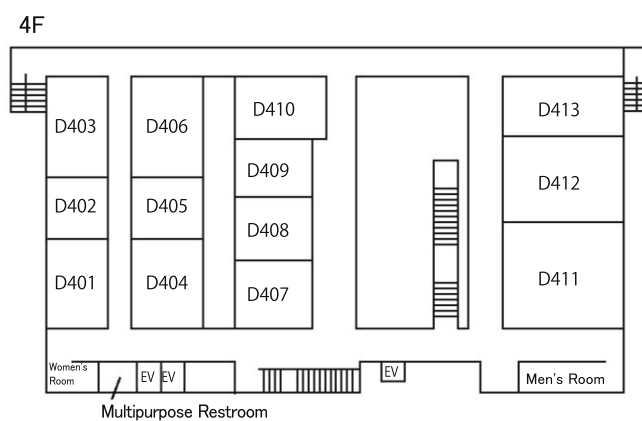
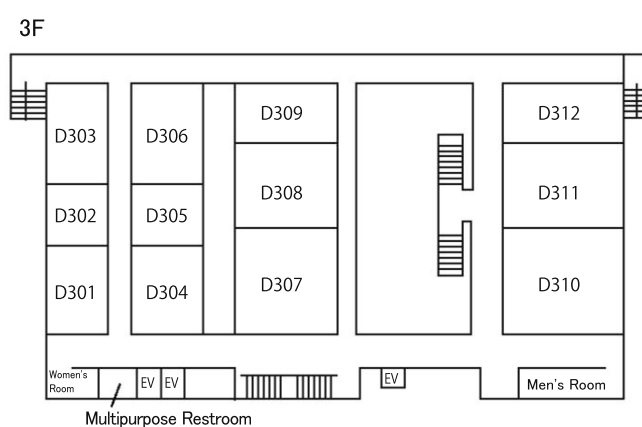



## 【Fourth Building General View】

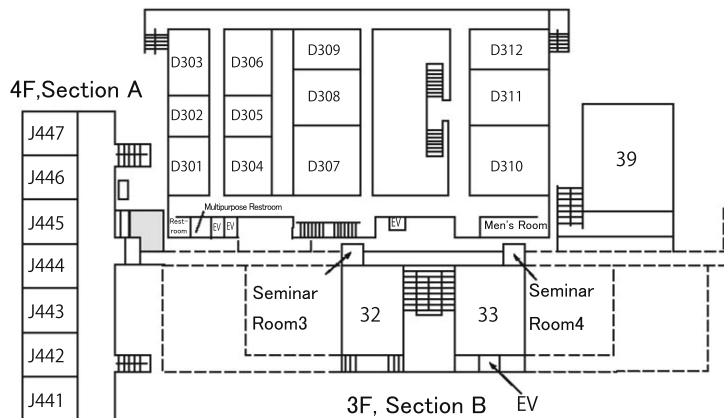
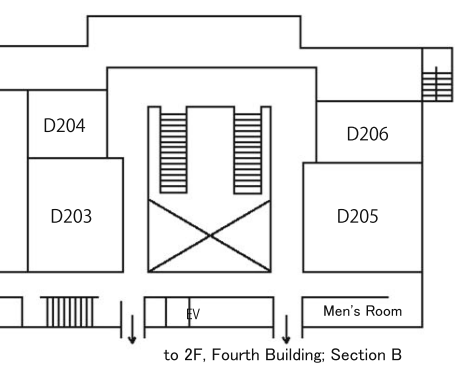
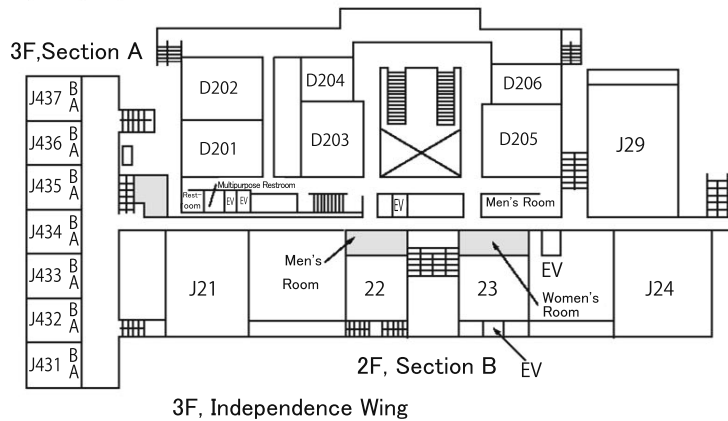
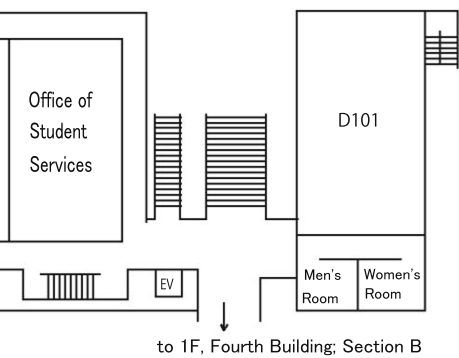
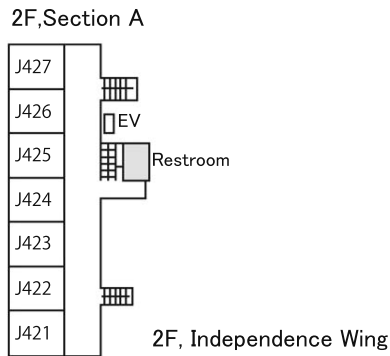
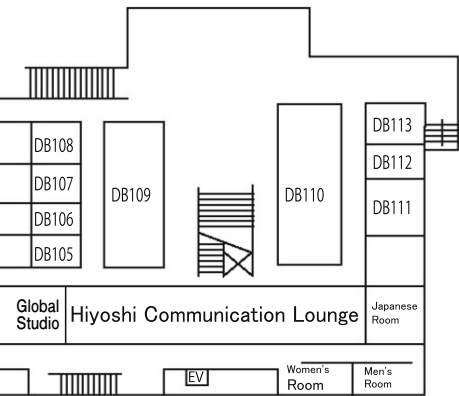
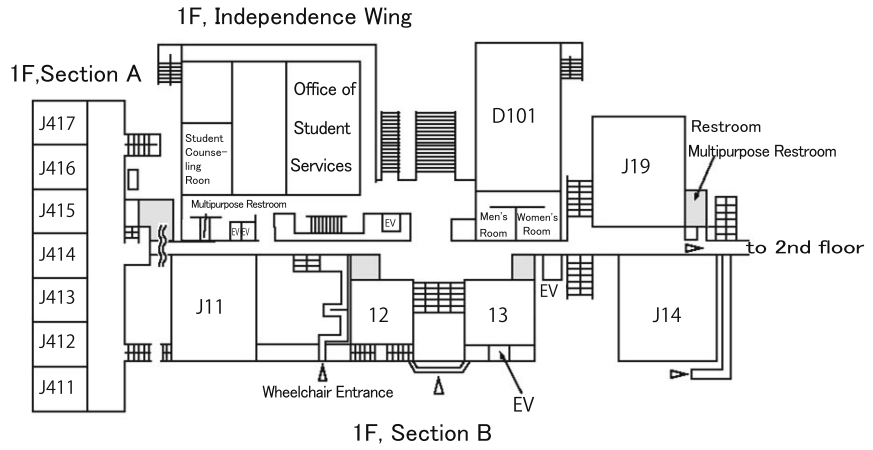
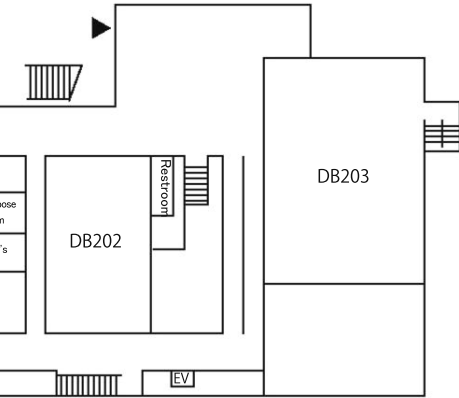

### 【Eighth Building】

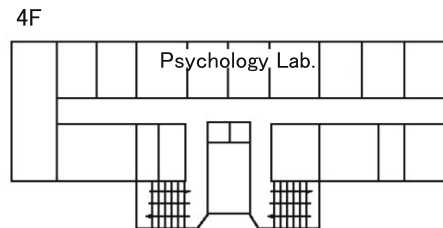
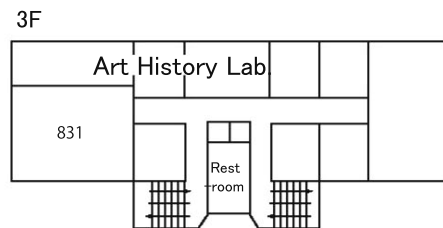
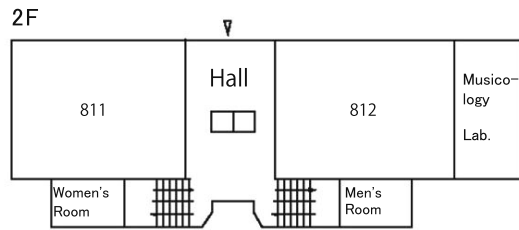

### 【Seventh Building】

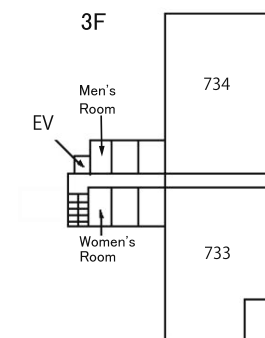
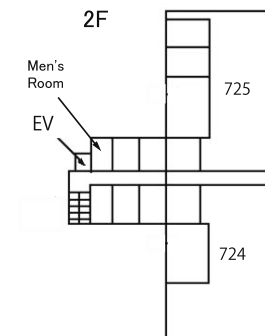
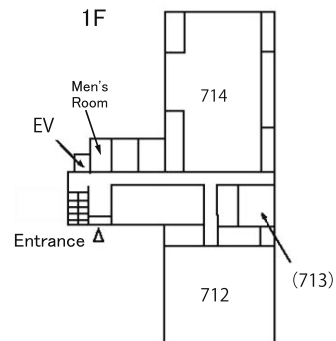
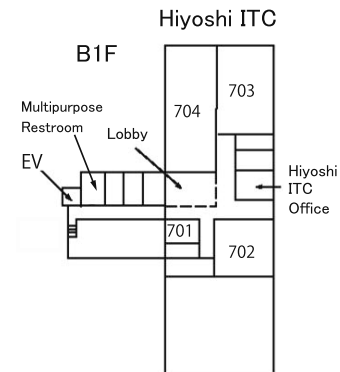

### 【Sixth Building】

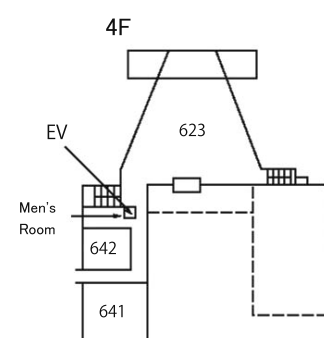
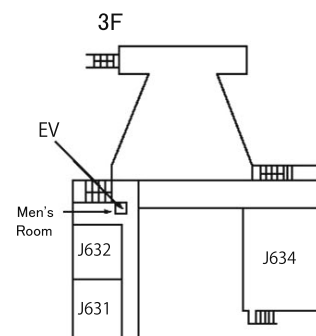
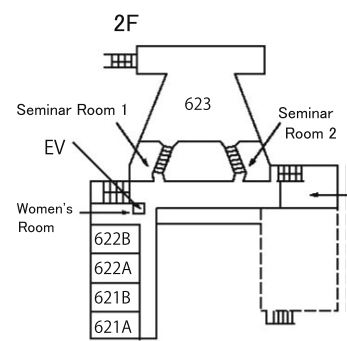
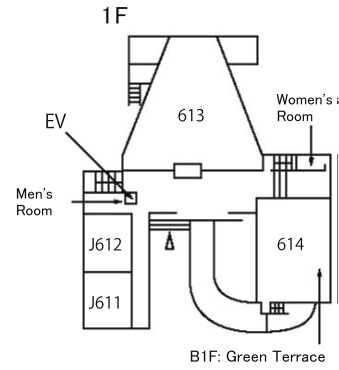

### 【Third Building】

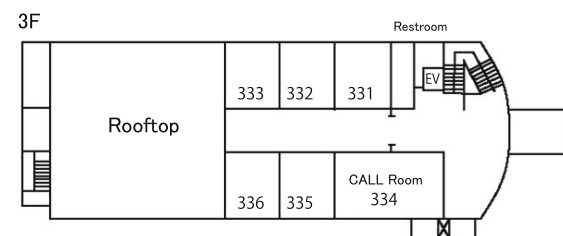
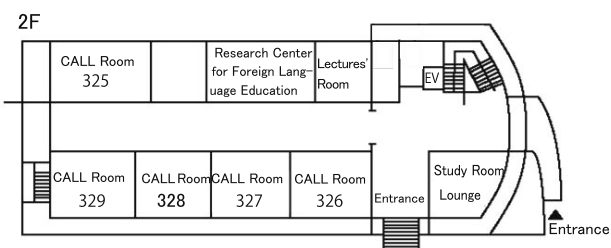
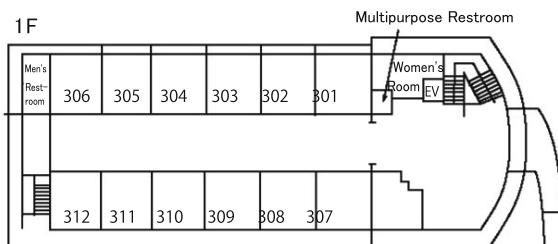

### 【Second Building】

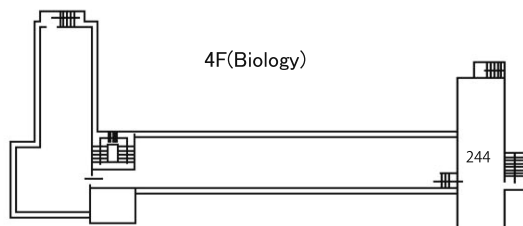
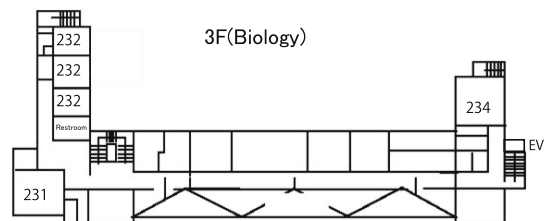
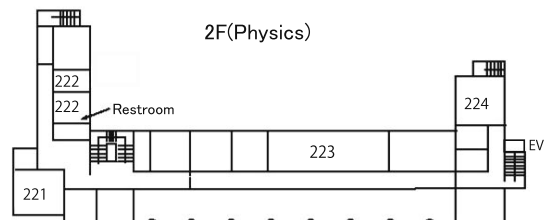
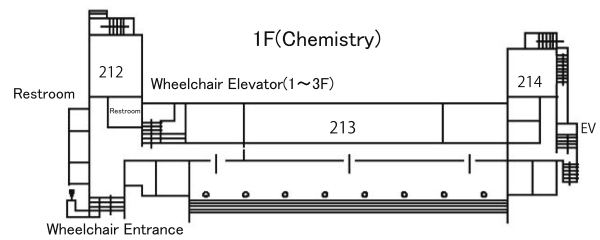

[Hiyoshi Campus Map]

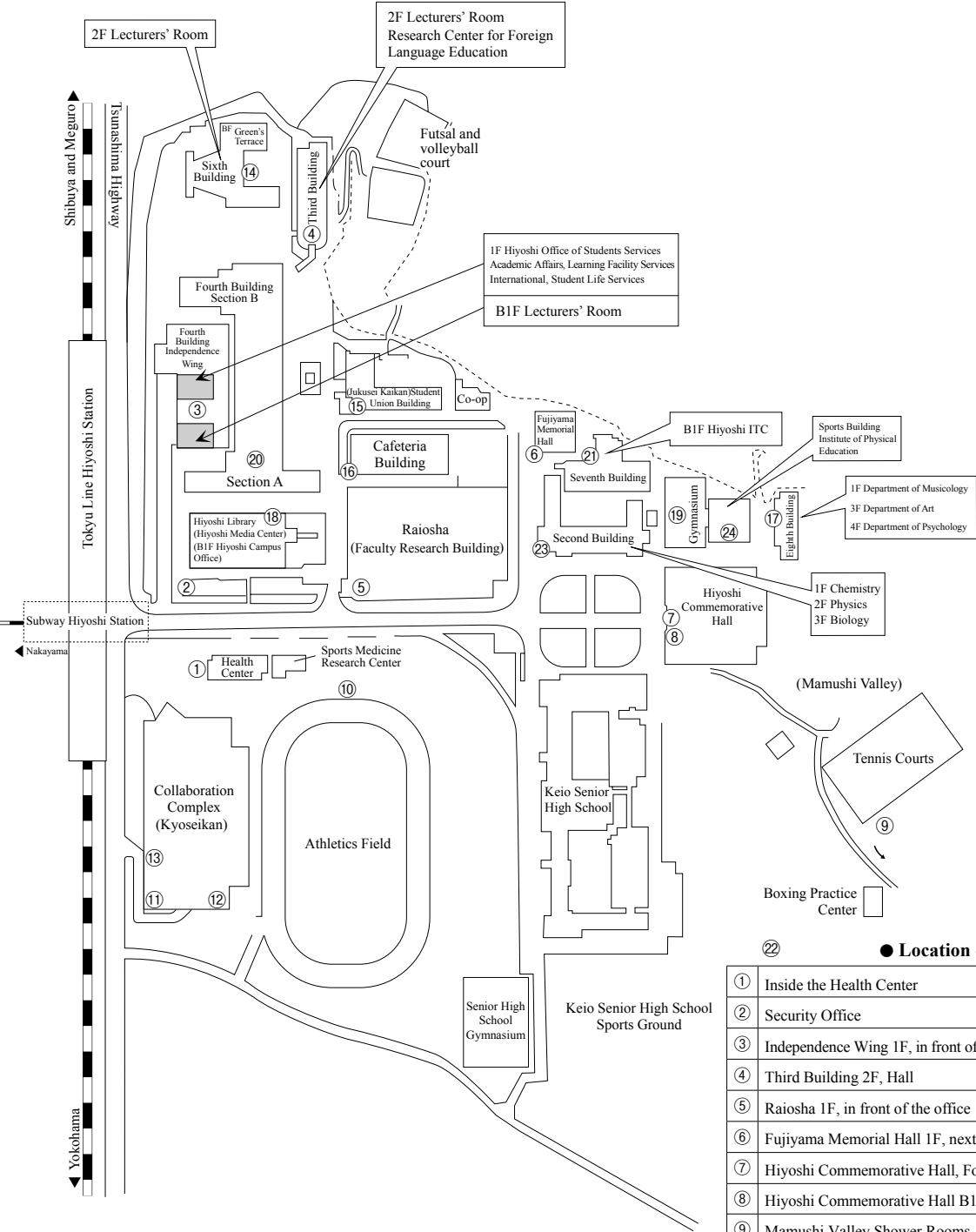

● Location of AEDs	
①	Inside the Health Center
②	Security Office
③	Independence Wing 1F, in front of the Office of Student Services
④	Third Building 2F, Hall
⑤	Raiosha 1F, in front of the office
⑥	Fujiyama Memorial Hall 1F, next to the stairs
⑦	Hiyoshi Commemorative Hall, Foyer
⑧	Hiyoshi Commemorative Hall B1, Arena
⑨	Mamushi Valley Shower Rooms, in front of the men's showers
⑩	Athletics Field facility building 1F
⑪	Collaboration Complex (Kyoseikan) 1F Security Center
⑫	Collaboration Complex (Kyoseikan), underground university fitness facility entrance
⑬	Collaboration Complex (Kyoseikan) 7F, Hall in front of the elevator
⑭	Sixth Building 1F, entrance hall
⑮	Jukusei Kaikan Student Union Building 1F (Extracurricular facilities building)
⑯	Cafeteria Building student plaza (inner courtyard), side entrance
⑰	Eighth Building 1F, glass entrance
⑱	Library (Media Center) 1F, reception counter
⑲	Gymnasium (Judo hall), Hiyoshi Commemorative Hall , annex entrance
⑳	Fourth Building Section A 1F, entrance hall
㉑	Seventh Building 1F, front entrance
㉒	Mamushi Valley Gymnasium, entrance hall
㉓	Second Building 1F, glass entrance
㉔	Sports Building, entrance

As of April 2021