

FALL 2022

FACULTY OF ECONOMICS PEARL

TIMETABLE

FIRST YEAR

Notes

1. Please pay attention and do not confuse course registration numbers with classroom numbers.
2. Half-year intensive courses have two classes per week, for example, English Academic Skills. For these courses, the same course registration number is printed for both classes.
For intensive course registration, if you enter the registration number, you will be registered for both classes automatically.
3. Important announcements from the university will be posted on the Keio University Student Website or "News" on keio.jp. Also, there will be notices posted at these locations if there are any classroom changes in the middle of the semester or temporary classroom changes. It is your responsibility to check the website regularly so as not to miss notices.
4. Any results in courses you have not registered for will be invalid, even if you take the exams or submit assignments.

* **Course Registration**

<http://keio.jp/> > **Class** > **Course Registration**

* **Keio University Syllabus and Timetable**

<https://gslbs.keio.jp/syllabus/login>

* **Keio University Student Website**

<https://www.students.keio.ac.jp/>

		1 : 9 : 0 0 ~ 1 0 : 3 0				2 : 1 0 : 4 5 ~ 1 2 : 1 5					
		Lecturer	Cl's	Reg.No.	Courses	Room	Lecturer	Cl's	Reg.No.	Courses	Room
Mon	FOREIGN LANGUAGES										
	FOUNDATION ELECTIVE	AKOROMIDES, CATHERINE		89500	[Fa] LINEAR ALGEBRA	1 2					
	GENERAL EDUCATION (CATEGORY I)										
	GENERAL EDUCATION (CATEGORY II)	KIBATA, MIO		01528	[Fa] HEALTH AND HUMAN PERFORMANCE 1 (GIC-certified courses)	D 3 0 4	BATTY, ROGER M. KAMADA, YUMIKO		41379 96020	[FaIn] HISTORY OF WESTERN ART AND FASHION 1 [FaIn] FINE ARTS	D 4 0 2 D 4 1 0
Tue	FOUNDATION	SHIRATSUKA, SHIGENO	p	89514	[Fa] INTRODUCTION TO THE JAPANESE ECONOMY	D 2 0 3					
	MAJOR SUBJECTS						FUJIWARA, IPPEI	p	90131	[Fa] ELEMENTARY MACROECONOMICS 1	D 2 0 3
	GENERAL EDUCATION (CATEGORY I)										
	GENERAL EDUCATION (CATEGORY II)	TOMINAGA, HIROSHI FUSE, TSUTOMU		01001 98481	[Fa] TOPICS IN CONTEMPORARY BUSINESS 2 (GIC-certified courses) [Fa] HEALTH AND HUMAN PERFORMANCE 1 (GIC-certified courses)	D 2 0 6					
Wed	FOREIGN LANGUAGES	KAZ, DIANA M. NAKATSUGAWA, MIYUKI NOBUOKA, MARY MURPHY, KEVIN RAINE, PAUL		88518 89218 89533 94539 89222	[FaIn] ENGLISH ACADEMIC SKILLS 1 [FaIn] ENGLISH ACADEMIC SKILLS 1 [FaIn] ENGLISH ACADEMIC SKILLS 1 [FaIn] ENGLISH ACADEMIC SKILLS 1 [FaIn] ENGLISH ACADEMIC SKILLS 1	D 2 0 4 D 4 0 3 J 4 2 1 D 4 0 9 J 4 1 1					
	GENERAL EDUCATION						SASAKI, YUMI BONZI, ALANA R.		05959 91821	[FaIn] INTERCULTURAL COMMUNICATION [Fa] CORPORATE SOCIAL RESPONSIBILITY AND ETHICS 1	J 4 4 5 6 4 1
	GENERAL EDUCATION (CATEGORY I)										
	GENERAL EDUCATION (CATEGORY II)	GORSHKOV, VICTOR		00976	[Fa] TOPICS IN CONTEMPORARY BUSINESS 1 (GIC-certified courses)	D 3 1 2					
Fri	FOREIGN LANGUAGES	KAZ, DIANA M. NAKATSUGAWA, MIYUKI NOBUOKA, MARY MURPHY, KEVIN RAINE, PAUL		88518 89218 89533 94539 89222	[FaIn] ENGLISH ACADEMIC SKILLS 1 [FaIn] ENGLISH ACADEMIC SKILLS 1 [FaIn] ENGLISH ACADEMIC SKILLS 1 [FaIn] ENGLISH ACADEMIC SKILLS 1 [FaIn] ENGLISH ACADEMIC SKILLS 1	D 2 0 6 J 4 4 7 D 3 0 6 D 3 0 1 J 4 2 6					
	GENERAL EDUCATION (CATEGORY I)										
	GENERAL EDUCATION (CATEGORY II)										
Sat	GENERAL EDUCATION (CATEGORY I)										
	GENERAL EDUCATION (CATEGORY II)						NAKAYAMA, KOICHI		00646	[Fa] TOPICS IN CONTEMPORARY BUSINESS 1 (GIC-certified courses)	D 2 0 3

[Notes]:

【Fa】 : course offered in the Fall Semester

【FaIn】 : intensive course offered in the Fall Semester

→ : courses offered from preceding period

(GIC-certified courses): course not only for PEARL students whose main language of instruction is English, but also for students who take mainly courses with Japanese as the main language of instruction

* INTENSIVE JAPANESE classes are offered at Mita Campus.

* Courses without classroom numbers listed will be offered online.

* Adjustments will be made to a course if there are a particularly large number of students registering for it. (Highly possible for General Education Courses, especially for Intensive Courses marked as 【FaIn】 .)

3 : 13:00 ~ 14:30				4 : 14:45 ~ 16:15				5 : 16:30 ~ 18:00						
Lecturer	Cls	Reg.No.	Courses	Room	Lecturer	Cls	Reg.No.	Courses	Room	Lecturer	Cls	Reg.No.	Courses	Room
IKEDA, YUKIHIRO		83360	[Fa] INTENSIVE JAPANESE 1A (offered at Mita Campus)	542	IKEDA, YUKIHIRO		83374	[Fa] INTENSIVE JAPANESE 4A (offered at Mita Campus)	542	MCCOY, DAVIDH		89237	[Fa] GERMAN 1A	325
										BREFUEL, ROMUALD		89294	[Fa] FRENCH 3A	D304
										MATSUKAWA, IKUYO		89643	[Fa] CHINESE 3A	D303
										MATSUKAWA, KOSUKE		89662	[Fa] SPANISH 1A	D206
										SANAI, KAORU		02744	[Fa] JAPANESE 1A	J447
AOKI, KENICHIRO		35764	[Fa] NATURAL SCIENCES 1	224										
SASAKI, YUMI		05959	[FaIn] INTERCULTURAL COMMUNICATION	J411						IIDA, MAYU		06410	[Fa] GENDER STUDIES 2 (GIC-certified courses)	D311
				D410						TSUCHIDA, HARUNOBU		92699	[Fa] MUSIC1 (GIC-certified courses)	AV Hall
OKIMOTO, TATSUYOSHI	P	89457	[Fa] STATISTICS 1	D205										
										KAJIMURA, MAYUMI		41235	[Fa] LIFE SCIENCE - CURRENT STATUS AND PERSPECTIVES (GIC-certified courses)	23
					INOUE, SATOSHI		92703	[Fa] MUSIC2 (GIC-certified courses)	AV Hall	HAYASHI, HIDEKI		05136	[Fa] TOPICS IN CONTEMPORARY BUSINESS 2 (GIC-certified courses)	325
										YAMAMOTO, YUKI		98261	[Fa] SOCIOLOGY 1 (GIC-certified courses)	D406
MURAKAMI, AYANO		82306	[Fa] INTENSIVE JAPANESE 2A (offered at Mita Campus)	544	MURAKAMI, AYANO		83393	[Fa] INTENSIVE JAPANESE 5A (offered at Mita Campus)	544	MCCOY, DAVIDH		89241	[Fa] GERMAN 2A	325
										SAUVEGRAIN, SYLVAIN		89280	[Fa] FRENCH 2A	D303
										WU, MAOSONG		89624	[Fa] CHINESE 1A	J444
										MATSUKAWA, KOSUKE		89677	[Fa] SPANISH 2A	D407
										AKISADA, MIHO		02763	[Fa] JAPANESE 3A	D406
										VOGL, WALTER		94907	[Fa] LITERATURE 2 (GIC-certified courses)	J417
					KAWASHITA, MASAKAZU		91525	[Fa] SCIENCE AND THE ENVIRONMENT2	D311	KAWASHITA, MASAKAZU		92191	[Fa] SCIENCE AND THE ENVIRONMENT2 (GIC-certified courses)	D311
										FLACHI, ANTONINO		36043	[Fa] SCIENCE AND COOKING2	
										NAKAYAMA, KOICHI		98185	[Fa] TOPICS IN CONTEMPORARY BUSINESS 2 (GIC-certified courses)	23
										LIAN, SHU		44488	[Fa] AREA STUDIES-CONTEMPORARY STATE OF AFFAIRS IN CHINA 2	D309
ONO, NAOMI		83408	[Fa] INTENSIVE JAPANESE 3A (offered at Mita Campus)	103	ONO, NAOMI		83412	[Fa] INTENSIVE JAPANESE 6A (offered at Mita Campus)	103	DEGEN, RALPH		89256	[Fa] GERMAN 3A	D404
					TAKAHASHI, KEIHO		98697	[Fa] JAPANESE 5A	D302	SOTTILE, MARCO		89275	[Fa] FRENCH 1A	D303
										WU, MAOSONG		89639	[Fa] CHINESE 2A	J426
FLACHI, ANTONINO		92450	[Fa] SCIENCE AND THE ENVIRONMENT2 (GIC-certified courses)	224						SANCHEZ BARRERA, MIREIA		90127	[Fa] SPANISH 3A	J441
MARUYA, KAZUSHI		05270	[Fa] PSYCHOLOGY 1	D205						MIYAMOTO, HANAE		02759	[Fa] JAPANESE 2A	D304
SAKO, KATSURA		92809	[Fa] LITERATURE 2 (GIC-certified courses)	D306	BAI, YINGJIU		40186	[Fa] GEOGRAPHY2 (GIC-certified courses)	D203	BERNETT, ALEXANDER C.		92282	[Fa] AREA STUDIES ON CULTURE 1 (GIC-certified courses)	
LIM, YOUNGMI		04914	[Fa] SOCIOLOGY 1	D413	BATTY, ROGER M.		41379	[FaIn] HISTORY OF WESTERN ART AND FASHION 1	D405					
TOYODA, KENSUKE		92187	[Fa] SCIENCE AND THE ENVIRONMENT2 (GIC-certified courses)	D307										
OMAE, KEIICHIRO		01035	[Fa] TOPICS IN CONTEMPORARY BUSINESS 2 (GIC-certified courses)	D412										

• In order to register courses listed in the above timetable, please register through the Course Registration System and select column A.

• In order to register courses for type A/B students instructed in Japanese excluding courses offered by various research institutes and other faculties, please consult with the Office of Student Services during the Course Registration Period with extra time. It is not possible to register these courses through the Course Registration System. Dates and periods of those courses can be found on the timetable for type AB students. These credits are counted as Optional Subjects.

• The office will inform students who have not completed "English Academic Skills 1" of which class to take to re-register for the course. Applicable students should check "Message" on keio.jp.

Course Timetable for the Various Research Centers and Institutes at Hiyoshi

There are different course registration procedures for the various research centers and institutes. Carefully read the course descriptions, syllabi online and relative documents.

1. Credits for these courses are counted as Electives (Non-specific) credits.

• Elective (Non-specific) courses offered by the GIC Center

When course names are the same, students are only able to take one of the courses even if taught by different lecturers.
In order to register for the following courses, please select column A.

Course	Lecturer	Semester	Day/Period	Registration No.	Classroom
TOPICS IN CONTEMPORARY BUSINESS 2	ISHIBASHI, MITSURU	Fall	Mon/5	90753	D305
TOPICS IN CONTEMPORARY BUSINESS 2	ISHIBASHI, MITSURU	Fall	Fri/ 5	91085	D305

• Courses offered by the Institute of Physical Education

It is possible to take the same course (sport) multiple times.
In order to register for the following courses, please select column A.

Course	Lecturer	Semester	Day/Period	Registration No.	Classroom
PHYSICAL ACTIVITY A (TENNIS)	SAKAI, TOSHIAKI	Fall	Thu/3	38985	Tennis Court(Mamushi Valley)
PHYSICAL ACTIVITY A (SWIMMING)	TORIUMI, TAKASHI	Fall	Thu/3	08101	Kyoseikan Swimming Pool

2. Credits for these courses are counted as Optional credits.

• Courses offered by the Keio Research Center for Foreign Language Education

Courses offered by the Keio Research Center for Foreign Language Education are normally taught in Japanese.
In order to register for the following courses, please select column A.

For procedures to course registration and the results of course registration adjustment, please refer to the website:
<http://www.flang.keio.ac.jp/en/>

		1st period	2nd period	3rd period	4th period	5th period
Mon.	Reg. No					
	Course Name					
	Lecturer					
	Room					
	Credits					
	Field					
Tues.	Reg. No					
	Course Name					
	Lecturer					
	Room					
	Credits					
	Field					
Wed.	Reg. No					
	Course Name					
	Lecturer					
	Room					
	Credits					
	Field					
Thurs.	Reg. No					
	Course Name					
	Lecturer					
	Room					
	Credits					
	Field					
Fri.	Reg. No					
	Course Name					
	Lecturer					
	Room					
	Credits					
	Field					
Sat.	Reg. No					
	Course Name					
	Lecturer					
	Room					
	Credits					
	Field					

Number of Credits for the Fall Semester
 _____ credits in total
 Max credits for a full year
 (2022 Fall Sem. + 2023 Spring Sem.):
 48 credits

MEMO

MEMO

Classroom Map

【Fujiyama Memorial Hall】

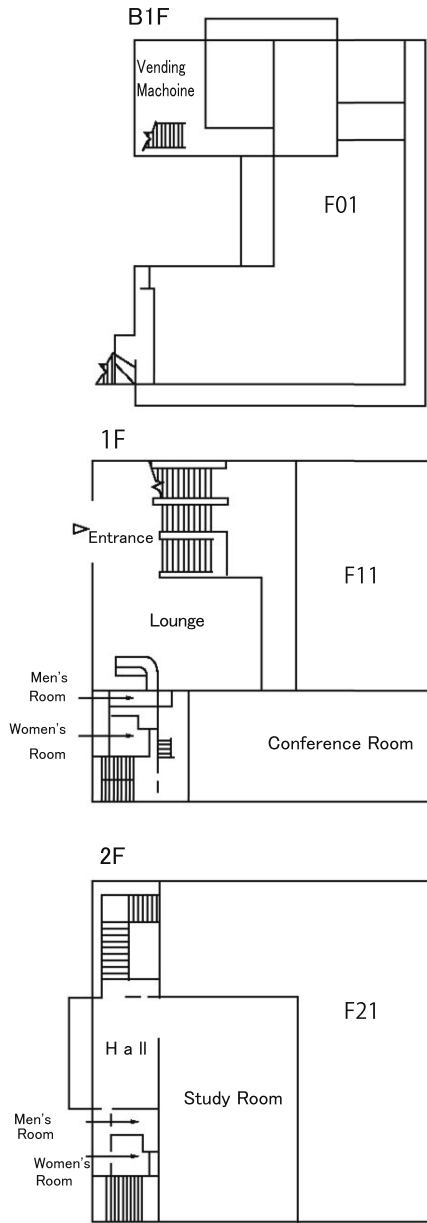

【Fourth Building Independence Wing】

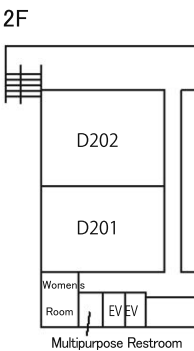
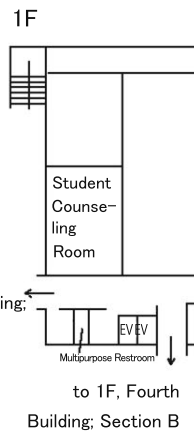
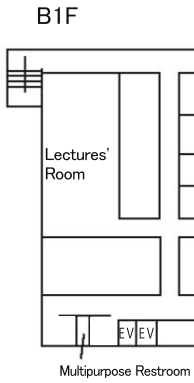
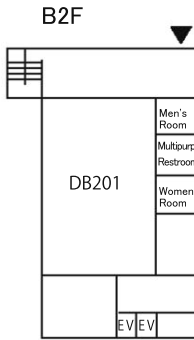
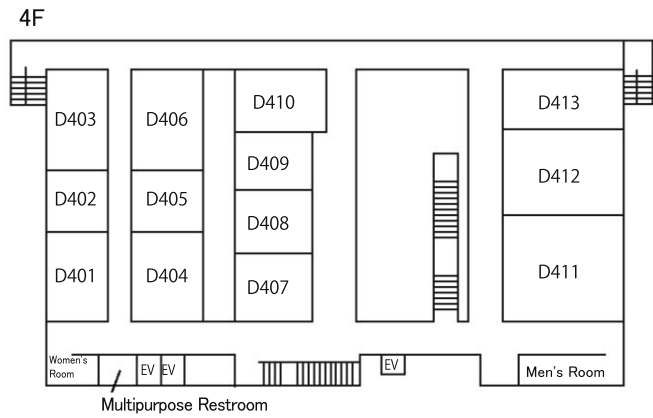
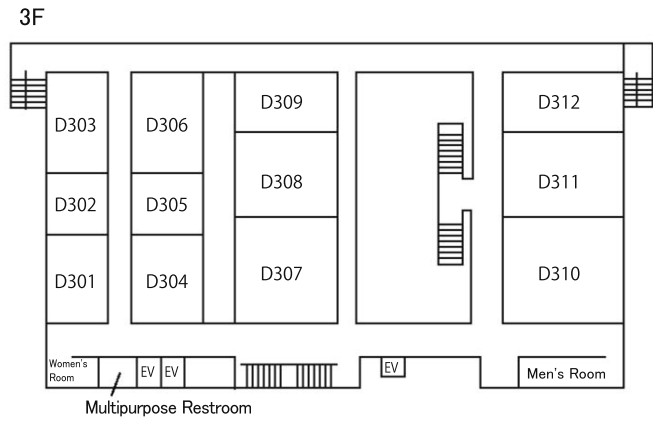

【Fourth Building General View】

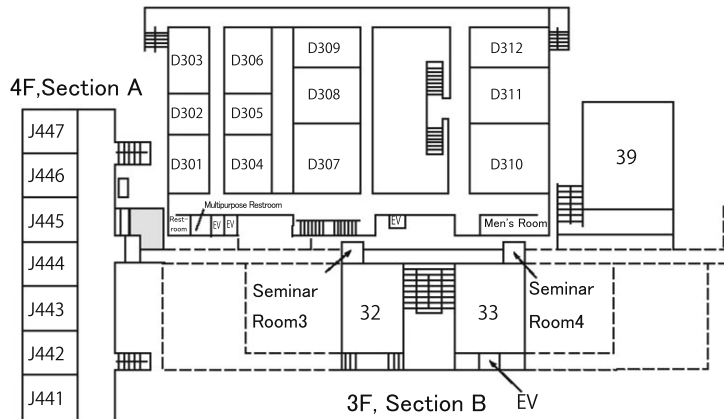
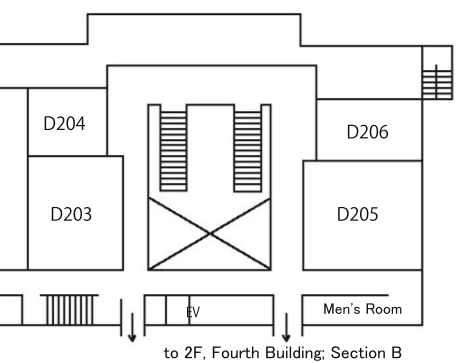
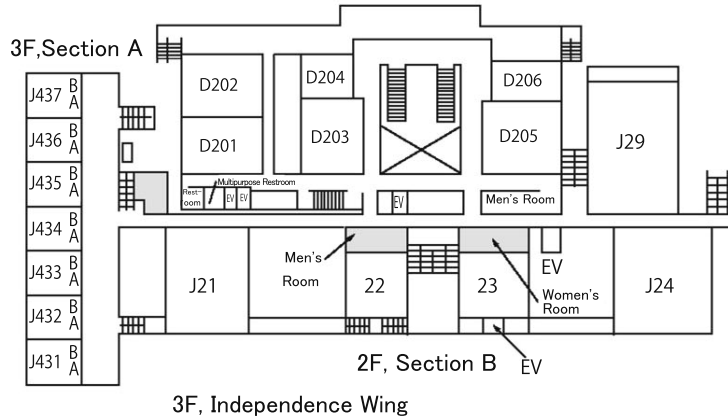
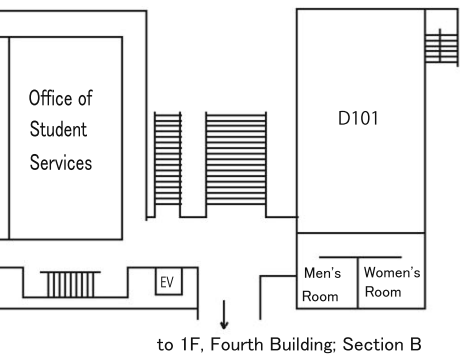
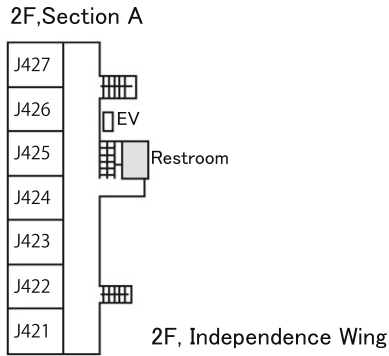
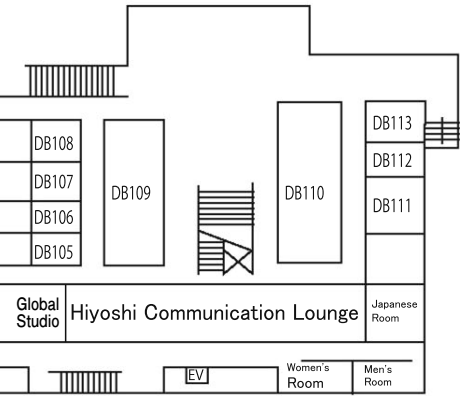
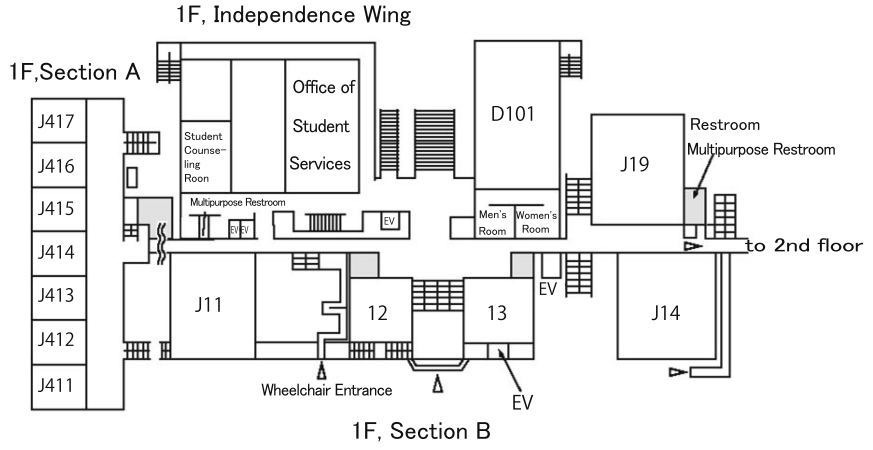
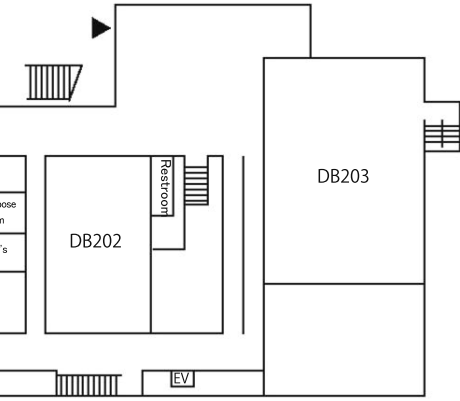

【Eighth Building】

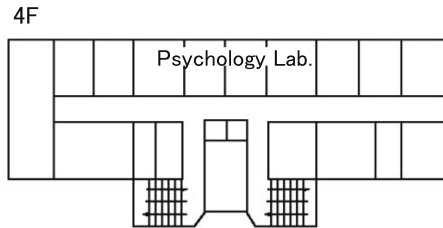
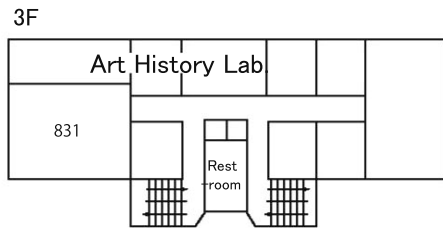
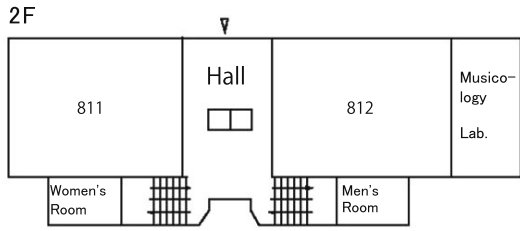

【Seventh Building】

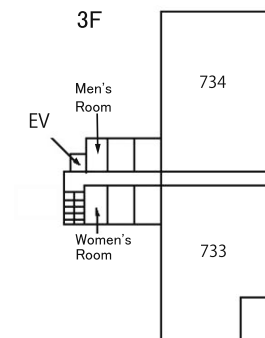
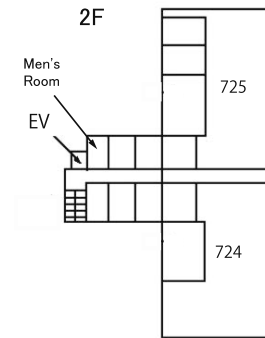
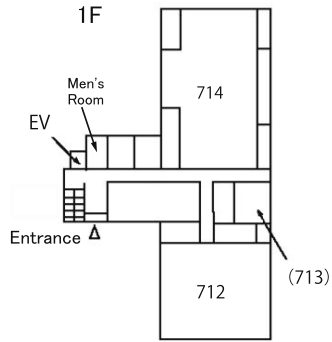
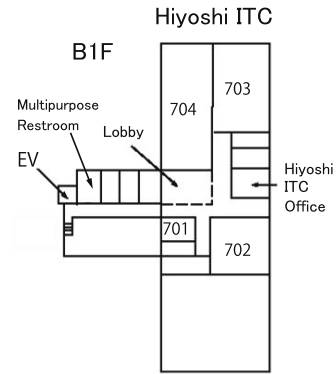

【Sixth Building】

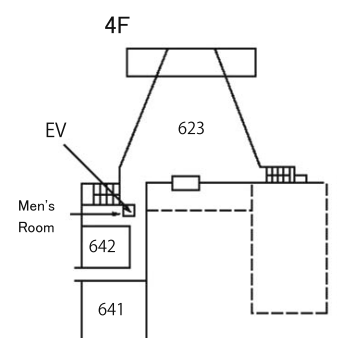
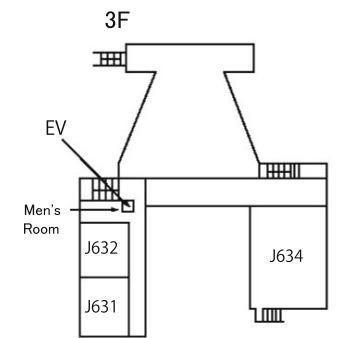
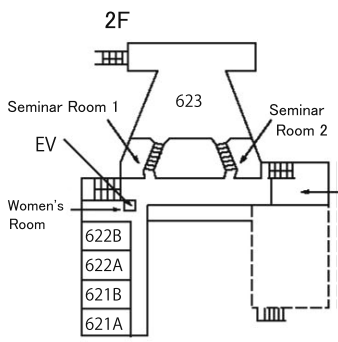
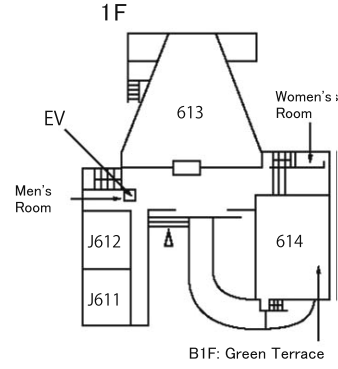

【Third Building】

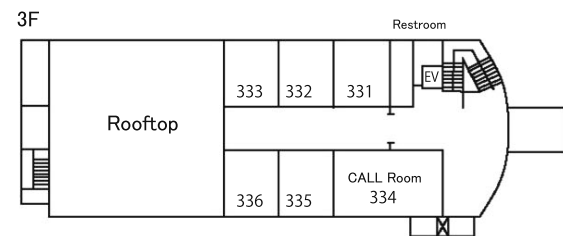
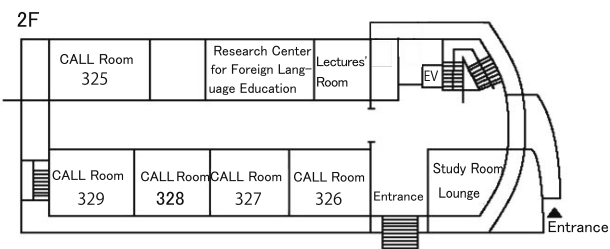
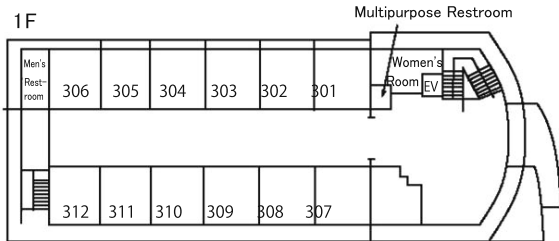

【Second Building】

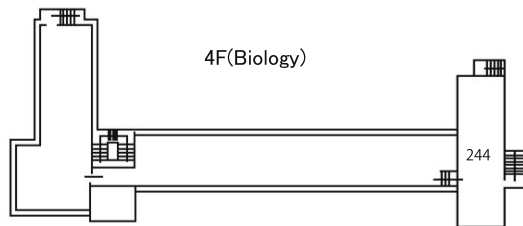
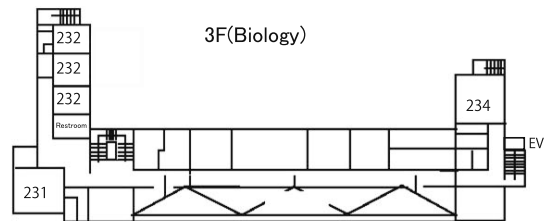
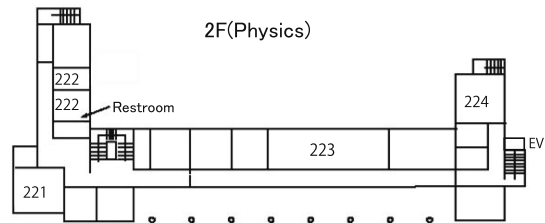
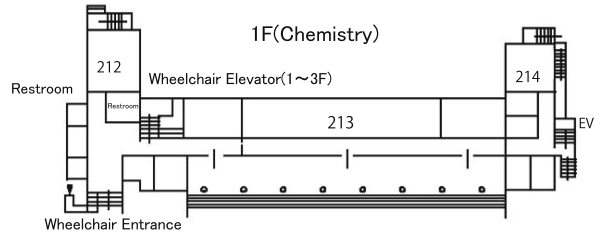

[Hiyoshi Campus Map]

