

FALL 2022
FACULTY OF ECONOMICS PEARL
TIMETABLE
SECOND YEAR

Notes

1. Please pay attention and do not confuse course registration numbers with classroom numbers.
2. Half-year intensive courses have two classes per week, for example, English Academic Skills. For these courses, the same course registration number is printed for both classes.
For intensive course registration, if you enter the registration number, you will be registered for both classes automatically.
3. Important announcements from the university will be posted on the Keio University Student Website or "News" on keio.jp. Also, there will be notices posted at these locations if there are any classroom changes in the middle of the semester or temporary classroom changes. It is your responsibility to check the website regularly so as not to miss notices.
4. Any results in courses you have not registered for will be invalid, even if you take the exams or submit assignments.

*** Course Registration**

<http://keio.jp/> > **Class > **Course Registration****

*** Keio University Syllabus and Timetable**

<https://gslbs.keio.jp/syllabus/login>

*** Keio University Student Website**

<https://www.students.keio.ac.jp/>

		1 : 9 : 00 ~ 10 : 30					2 : 10 : 45 ~ 12 : 15				
		Lecturer	Cl#	Reg.No.	Courses	Room	Lecturer	Cl#	Reg.No.	Courses	Room
Mon	FOREIGN LANGUAGES										
	FOUNDATION ELECTIVE						OLIGONOMIDES, CATHER		96895	[Fa] CALCULUS	1 2
	GENERAL EDUCATION (CATEGORY I)										
	GENERAL EDUCATION (CATEGORY II)	KIBATA, MIO		01528	[Fa] HEALTH AND HUMAN PERFORMANCE 1 (GIC-certified courses)	D 3 0 4	BATTY, ROGER M. KAMADA, YUMIKO		41379 96020	[FaIn] HISTORY OF WESTERN ART AND FASHION 1 [FaIn] FINE ARTS	D 4 0 2 D 4 1 0
Tue	MAJOR SUBJECTS										
	GENERAL EDUCATION (CATEGORY I)										
	GENERAL EDUCATION (CATEGORY II)	TOMINAGA, HIROSHI		01001	[Fa] TOPICS IN CONTEMPORARY BUSINESS 2 (GIC-certified courses)	D 2 0 6					
	GENERAL EDUCATION (CATEGORY III)	FUSE, TSUTOMU		98481	[Fa] HEALTH AND HUMAN PERFORMANCE 1 (GIC-certified courses)						
Wed	FOREIGN LANGUAGES										
	GENERAL EDUCATION (CATEGORY II)						SASAKI, YUMI BONZI, ALANA R.		05959 91821	[FaIn] INTERCULTURAL COMMUNICATION [Fa] CORPORATE SOCIAL RESPONSIBILITY AND ETHICS 1	J 4 4 5 6 4 1
	GENERAL EDUCATION (CATEGORY II)										
Thu	MAJOR SUBJECTS	KAWAI, KEIICHI	P	95679	[Fa] INTRODUCTION TO MICROECONOMICS 1	D 2 0 3	YAGU, TOMOKO	P	95683	[Fa] ELEMENTARY ECONOMIC HISTORY 1	1 2
	GENERAL EDUCATION (CATEGORY I)										
	GENERAL EDUCATION (CATEGORY II)	GORSHKOV, VICTOR		00976	[Fa] TOPICS IN CONTEMPORARY BUSINESS 1 (GIC-certified courses)	D 3 1 2					
Fri	FOREIGN LANGUAGES										
	MAJOR SUBJECTS	SUSATO, RYU		95406	[Fa] INTRODUCTION TO THE HISTORY OF ECONOMIC THOUGHT 1	D 2 0 5					
	GENERAL EDUCATION (CATEGORY I)										
	GENERAL EDUCATION (CATEGORY II)										
Sat	GENERAL EDUCATION (CATEGORY I)										
	GENERAL EDUCATION (CATEGORY II)						NAKAYAMA, KOICHI		00646	[Fa] TOPICS IN CONTEMPORARY BUSINESS 1 (GIC-certified courses)	D 2 0 3

[Notes]:

【Fa】 : course offered in the Fall Semester

【FaIn】 : intensive course offered in the Fall Semester

→ : courses offered from preceding period

(GIC-certified courses): course not only for PEARL students whose main language of instruction is English, but also for students who take mainly courses with Japanese as the main language of instruction

(*) : Two-semester pair course

*Courses without classroom numbers listed will be offered online.

*Adjustments will be made to a course if there are a particularly large number of students registering for it. (Highly possible for General Education Courses, especially for Intensive Courses marked as 【FaIn】 .)

3 : 13:00 ~ 14:30					4 : 14:45 ~ 16:15					5 : 16:30 ~ 18:00				
Lecturer	Cl	Reg.No.	Courses	Room	Lecturer	Cl	Reg.No.	Courses	Room	Lecturer	Cl	Reg.No.	Courses	Room
ISHIZUKA, KYOKO		98405	[Fa] INTENSIVE JAPANESE 7A	D304	MCCOY, DAVIDH LEBOIS, JEROME LI, JINJIA MATSUKAWA, KOSUKE SANAL, KAORU ISHIZUKA, KYOKO		12406 12425 12430 12444 13144 98410	[FaIn] GERMAN 4A [FaIn] FRENCH 4A [FaIn] CHINESE 4A [FaIn] SPANISH 4A [FaIn] JAPANESE 4A [Fa] INTENSIVE JAPANESE 10A	325 D409 D305 D206 J447 D304					
AOKI, KENICHIRO SASAKI, YUMI		35764 05959	[Fa] NATURAL SCIENCES 1 [FaIn] INTERCULTURAL COMMUNICATIO N	224 J411 D410						HIDA, MAYU TSUCHIDA, HARUNOBU		06410 92699	[Fa] GENDER STUDIES 2(GIC-certified courses) [Fa] MUSIC1(GIC-certified courses)	D311 Av Hall
					MCENZIE, COLIN R. OHNISHI, HIROSHI		95645 95812	[Fa] INTRODUCTION TO ECONOMETRICS [Fa] MARXIAN ECONOMICS 1	641	SASAHARA, AKIRA		35860	[Fa] ECONOMIES AND SOCIETIES IN G LOBALIZATION	D201
					INOUE, SATOSHI		92703	[Fa] MUSIC2(GIC-certified courses)	Av Hall	KAJIMURA, MAYUMI		41235	[Fa] LIFE SCIENCE - CURRENT STATU S AND PERSPECTIVES(GIC-certified c ourses)	23
					ERTL, JOHN J.		18351	[Fa] GENERAL EDUCATION SEMINAR B(G IC-certified courses) (*)	DB108	HAYASHI, HIDEKI YAMAMOTO, YUKI		05136 98261	[Fa] TOPICS IN CONTEMPORARY BUSIN ESS 2(GIC-certified courses) [Fa] SOCIOLOGY 1(GIC-certified co urses)	325 D406
					MCCOY, DAVIDH SAUVEGRAIN, SYLVAIN LI, JINJIA MATSUKAWA, KOSUKE KASHIKURA, HIROMI MIYAMOTO, HANAÉ		12406 12425 12430 12444 13144 98735	[FaIn] GERMAN 4B [FaIn] FRENCH 4B [FaIn] CHINESE 4B [FaIn] SPANISH 4B [FaIn] JAPANESE 4B [Fa] INTENSIVE JAPANESE 8A	325 D303 D304 D407 D406 D404	MIYAMOTO, HANAÉ		99052	[Fa] INTENSIVE JAPANESE 11A	D404
										VOGL, WALTER		94907	[Fa] LITERATURE 2(GIC-certified c ourses)	J417
					KAWASHITA, MASAKAZU		91525	[Fa] SCIENCE AND THE ENVIRONMENT2	D311	KAWASHITA, MASAKAZU		92191	[Fa] SCIENCE AND THE ENVIRONMENT2 (GIC-certified courses)	D311
										FLACHI, ANTONINO NAKAYAMA, KOICHI LIAN, SHU		36043 98185 44488	[Fa] SCIENCE AND COOKING2 [Fa] TOPICS IN CONTEMPORARY BUSIN ESS 2(GIC-certified courses) [Fa] AREA STUDIES-CONTEMPORARY ST ATE OF AFFAIRS IN CHINA 2	23 D309
AKISADA, MIHO		99124	[Fa] INTENSIVE JAPANESE 9A	D304	AKISADA, MIHO TAKAHASHI, KEIKO		99139 98697	[Fa] INTENSIVE JAPANESE 12A [Fa] JAPANESE 5A	D304 D302					
FLACHI, ANTONINO		92450	[Fa] SCIENCE AND THE ENVIRONMENT2 (GIC-certified courses)	224										
MARUYA, KAZUSHI		05270	[Fa] PSYCHOLOGY 1	D205										
SAKO, KATSURA		92809	[Fa] LITERATURE 2(GIC-certified c ourses)	D306	BAI, YINGJIU		40186	[Fa] GEOGRAPHY2(GIC-certified cou rses)	D203	BERNETT, ALEXANDER C.		92282	[Fa] AREA STUDIES ON CULTURE 1(GI C-certified courses)	
LIM, YOUNGMI		04914	[Fa] SOCIOLOGY 1	D413	BATTY, ROGER M.		41379	[FaIn] HISTORY OF WESTERN ART AND FASHION 1	D405					
TOYODA, KENSUKE		92187	[Fa] SCIENCE AND THE ENVIRONMENT2 (GIC-certified courses)	D307										
OMAE, KEIICHIRO		01035	[Fa] TOPICS IN CONTEMPORARY BUSIN ESS 2(GIC-certified courses)	D412										

• In order to register courses listed in the above timetable, please register through the Course Registration System and select column A.

• If you wish to register courses for type A/B students instructed in Japanese excluding courses offered by various research institutes and other faculties, please consult with the Office of Student Services during the Course Registration Period with extra time. It is not possible to register these courses through the Course Registration System. Dates and periods of those courses can be found on the timetable for type AB students. These credits are counted as Optional Subjects.

• Students who have not taken all of the mandatory subjects for the Fall Semester of the first year should check the timetable on page 5 and carry out the course registrations.

Course Timetable

for the Various Research Centers and Institutes at Hiyoshi

There are different course registration procedures for the various research centers and institutes. Carefully read the course descriptions, syllabi online and relative documents.

1. Credits for these courses are counted as Electives (Non-specific) credits.

• Elective (Non-specific) courses offered by the GIC Center

When course names are the same, students are only able to take one of the courses even if taught by different lecturers. In order to register for the following courses, please select column A.

Course	Lecturer	Semester	Day/Period	Registration No.	Classroom
TOPICS IN CONTEMPORARY BUSINESS 2	ISHIBASHI, MITSURU	Fall	Mon/5	90753	D305
TOPICS IN CONTEMPORARY BUSINESS 2	ISHIBASHI, MITSURU	Fall	Fri/ 5	91085	D305

• Courses offered by the Institute of Physical Education

It is possible to take the same course (sport) multiple times.

In order to register for the following courses, please select column A.

Course	Lecturer	Semester	Day/Period	Registration No.	Classroom
PHYSICAL ACTIVITY A (TENNIS)	SAKAI, TOSHIAKI	Fall	Thu/3	38985	Tennis Court(Mamushi Valley)
PHYSICAL ACTIVITY A (SWIMMING)	TORIUMI, TAKASHI	Fall	Thu/3	08101	Kyoseikan Swimming Pool

• Courses offered by the International Center

Courses offered by the International Center are held at **Mita Campus**.

When course names are the same, students are able to take only one of them even though they are taught by different lecturers. In order to register for the following courses, please select column A.

For procedures to course registration and the results of course registration adjustment, please refer to the website:
<https://www.ic.keio.ac.jp/en/aboutic/aboutcourse/>

2. Credits for these courses are counted as Optional credits.

• Courses offered by the Keio Research Center for Foreign Language Education

Courses offered by the Keio Research Center for Foreign Language Education are normally taught in Japanese.

In order to register for the following courses, please select column A.

For procedures to course registration and the results of course registration adjustment, please refer to the website:
<http://www.flang.keio.ac.jp/en/>

Timetable of Mandatory Subjects and Foundation Subjects(Elective subjects) for First-Year Students

Students who have not taken all of the mandatory subjects for the Fall Semester of the first year should check the timetable below and carry out the course registrations.

The office will inform via "Message" on keio.jp students who have not completed "English Academic Skills 1" of which class to take to re-register for the course.

Course	Lecturer	Semester	Day/Period	Registration No.	Classroom
ENGLISH ACADEMIC SKILLS 1	KAZ, DIANA M.	Fall	Wed/1,Fri/1	88518	D204, D206
ENGLISH ACADEMIC SKILLS 1	NAKATSUGAWA, MIYUKI	Fall	Wed/1,Fri/1	89218	D403, J447
ENGLISH ACADEMIC SKILLS 1	NOBUOKA, MARY	Fall	Wed/1,Fri/1	89533	J421, D306
ENGLISH ACADEMIC SKILLS 1	MURPHY, KEVIN	Fall	Wed/1,Fri/1	94539	D409, D301
ENGLISH ACADEMIC SKILLS 1	RAINE, PAUL	Fall	Wed/1,Fri/1	89222	J411, J426
GERMAN 1A	MCCOY, DAVID H.	Fall	Mon/5	89237	325
GERMAN 2A	MCCOY, DAVID H.	Fall	Wed/5	89241	325
GERMAN 3A	DEGEN, RALPH	Fall	Fri/5	89256	D404
FRENCH 1A	SOTTILE, MARCO	Fall	Fri/5	89275	D303
FRENCH 2A	SAUVEGRAIN., SYLVAIN	Fall	Wed/5	89280	D303
FRENCH 3A	BREFUEL, ROMUALD	Fall	Mon/5	89294	D304
CHINESE 1A	WU, MAOSONG	Fall	Wed/5	89624	J444
CHINESE 2A	WU, MAOSONG	Fall	Fri/5	89639	J426
CHINESE 3A	MATSUKAWA, IKUYO	Fall	Mon/5	89643	D303
SPANISH 1A	MATSUKAWA, KOSUKE	Fall	Mon/5	89662	D206
SPANISH 2A	MATSUKAWA, KOSUKE	Fall	Wed/5	89677	D407
SPANISH 3A	SANCHEZ BARRERA, MARTA	Fall	Fri/5	90127	J441
JAPANESE 1A	SANAI, KAORU	Fall	Mon/5	02744	J447
JAPANESE 2A	MIYAMOTO, HANAE	Fall	Fri/5	02759	D304
JAPANESE 3A	AKISADA, MIHO	Fall	Wed/5	02763	D406
ELEMENTARY MACROECONOMICS 1	FUJIWARA, IPPEI	Fall	Tue/2	90131	D203
INTRODUCTION TO THE JAPANESE ECONOMY	SHIRATSUKA, SHIGENORI	Fall	Tue/1	89514	D203
STATISTICS 1	OKIMOTO, TATSUYOSHI	Fall	Tue/3	89457	D205

First Year Foundation Subjects (Elective subjects)

Although the course listed below is for the first year students, it is available for the second year students to take.

Course	Lecturer	Semester	Day/Period	Registration No.	Classroom
LINEAR ALGEBRA	OIKONOMIDES, CATHERINE	Fall	Mon/1	89500	12

		1st period	2nd period	3rd period	4th period	5th period
Mon.	Reg. No					
	Course Name					
	Lecturer					
	Room					
	Credits					
	Field					
Tues.	Reg. No					
	Course Name					
	Lecturer					
	Room					
	Credits					
	Field					
Wed.	Reg. No					
	Course Name					
	Lecturer					
	Room					
	Credits					
	Field					
Thurs.	Reg. No					
	Course Name					
	Lecturer					
	Room					
	Credits					
	Field					
Fri.	Reg. No					
	Course Name					
	Lecturer					
	Room					
	Credits					
	Field					
Sat.	Reg. No					
	Course Name					
	Lecturer					
	Room					
	Credits					
	Field					

Number of Credits for the Fall Semester
 _____ **credits in total**
 Max credits for a full year
 (2022 Fall Sem. + 2023 Spring Sem.):
 48 credits

MEMO

Classroom Map

【Fujiyama Memorial Hall】

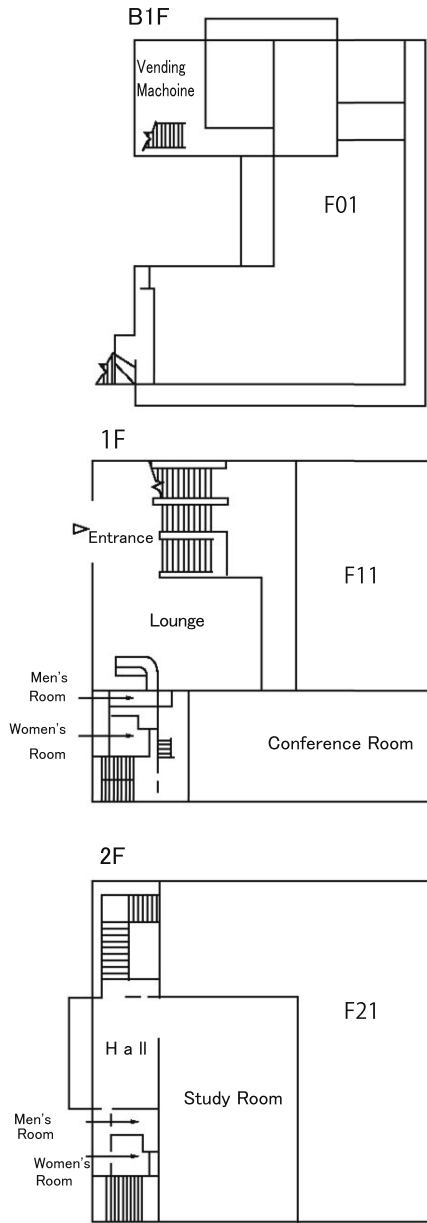

【Fourth Building Independence Wing】

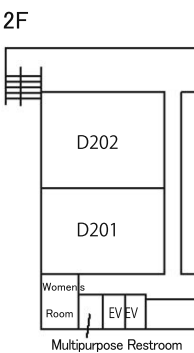
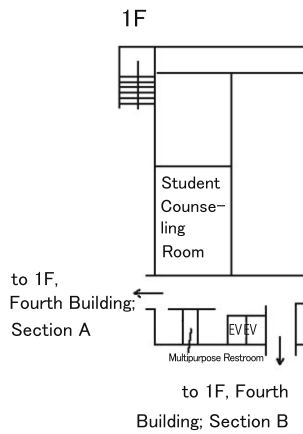
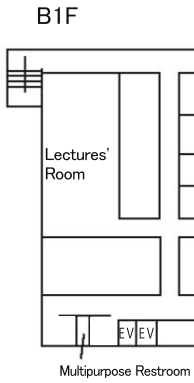
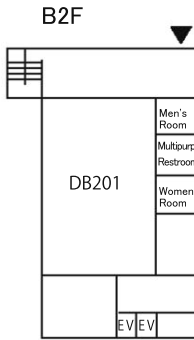
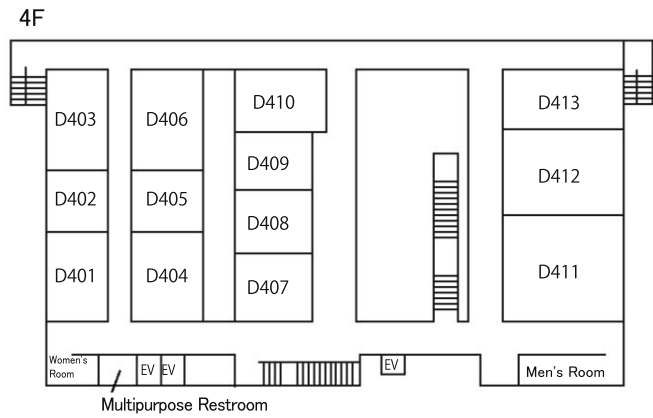
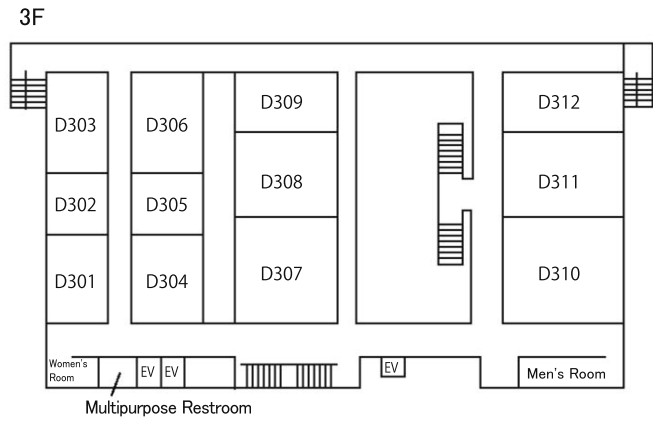

【Fourth Building General View】

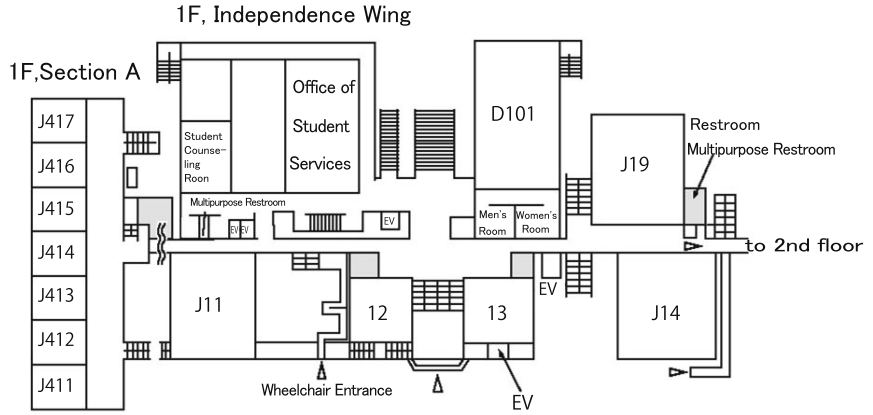
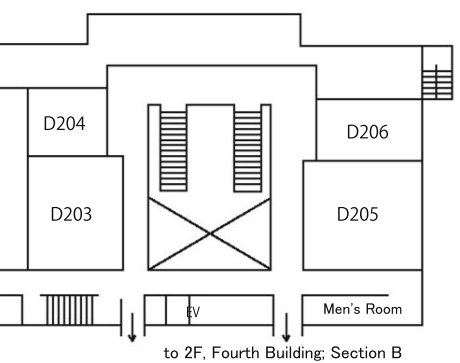
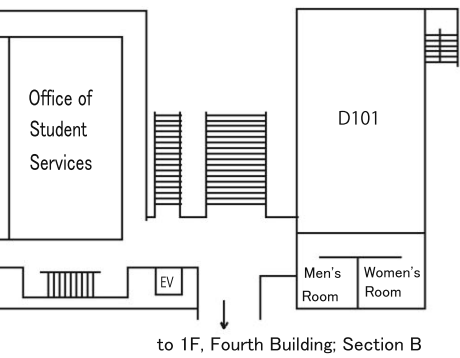
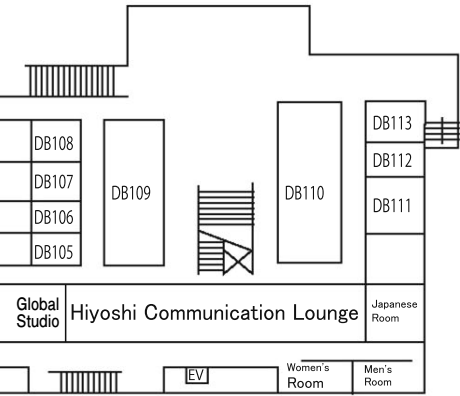
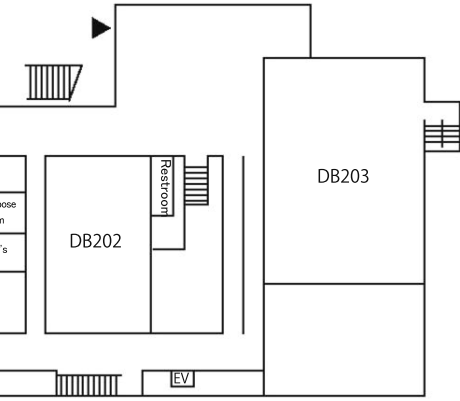

1F, Section B

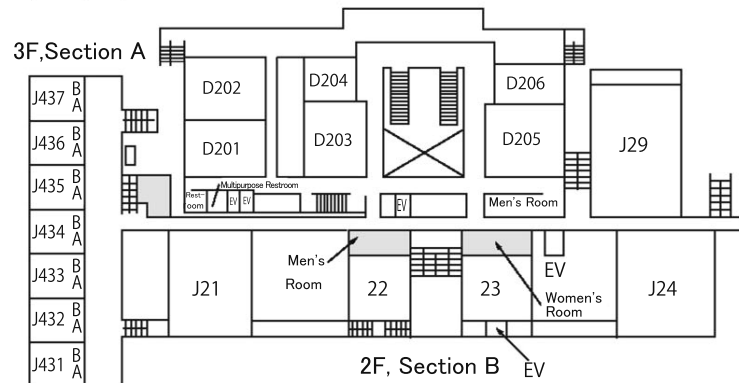
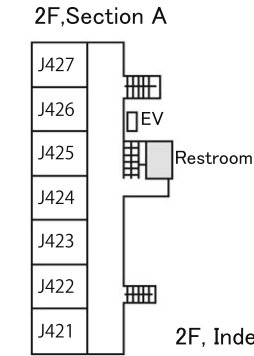

3F, Section B

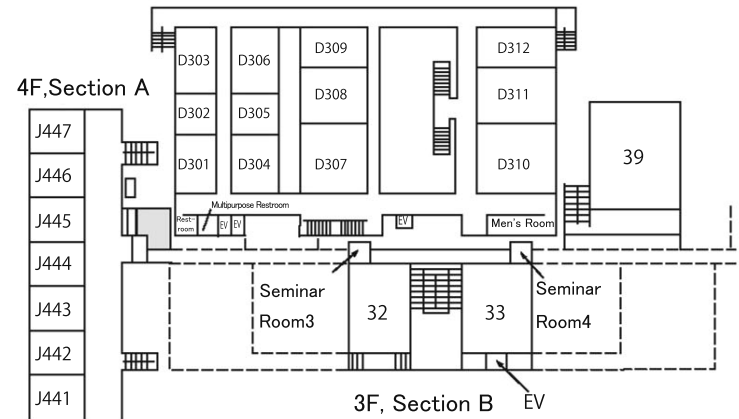

3F, Section B

【Eighth Building】

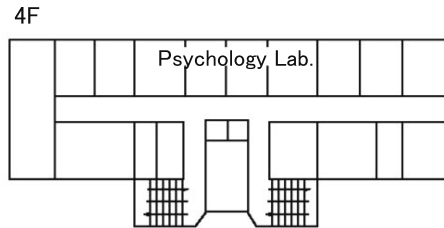
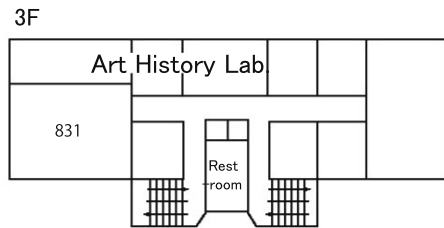
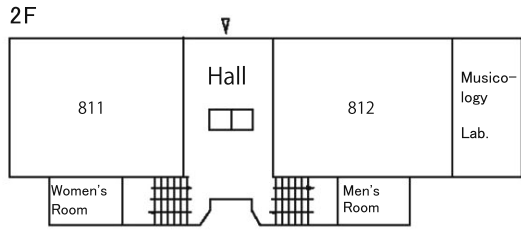

【Seventh Building】

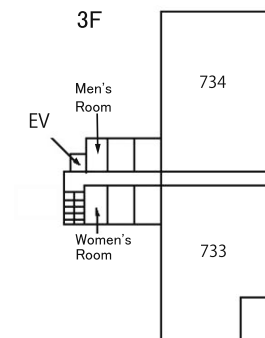
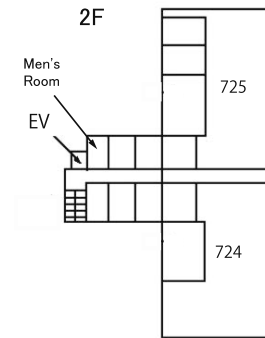
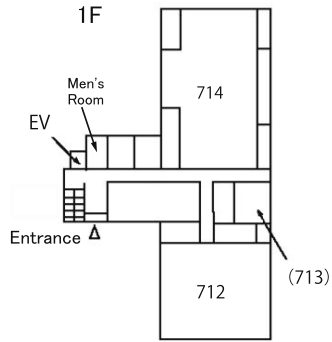
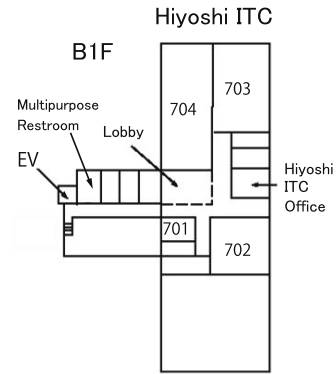

【Sixth Building】

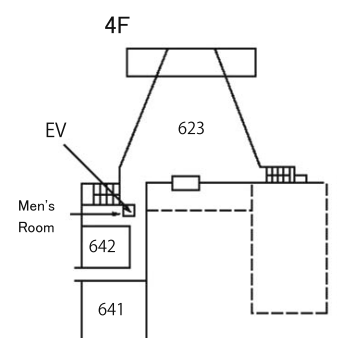
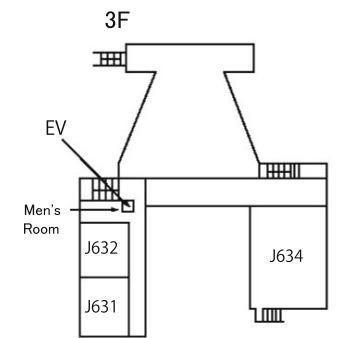
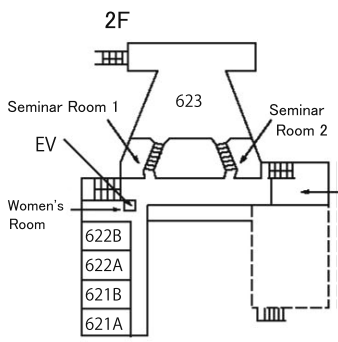
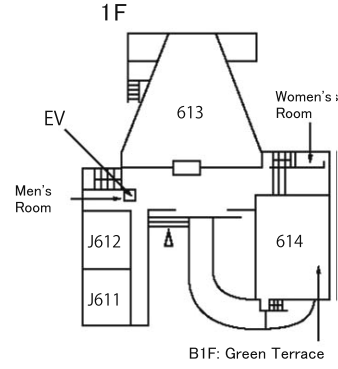

【Third Building】

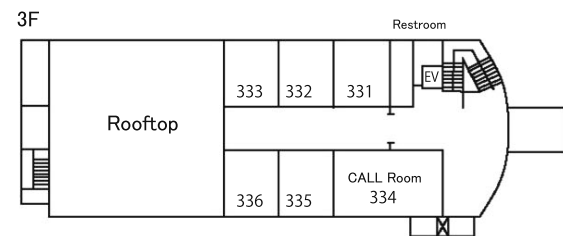
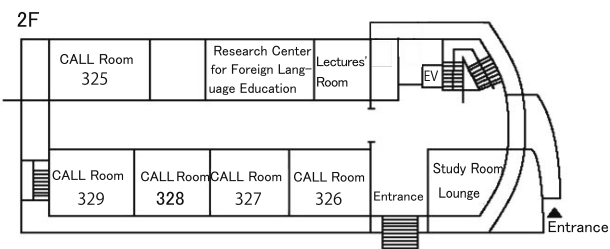
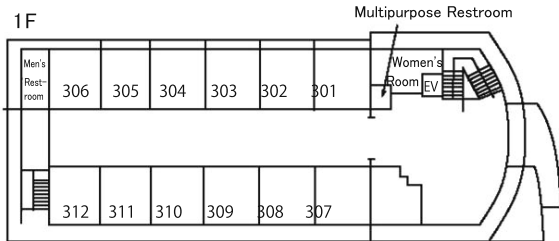

【Second Building】

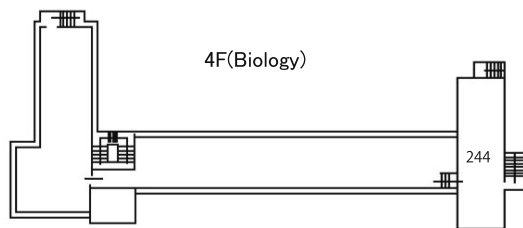
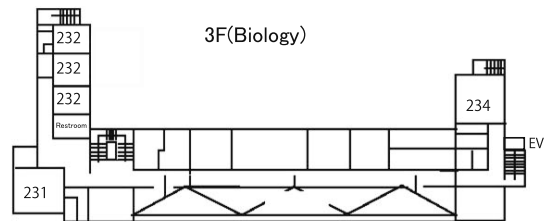
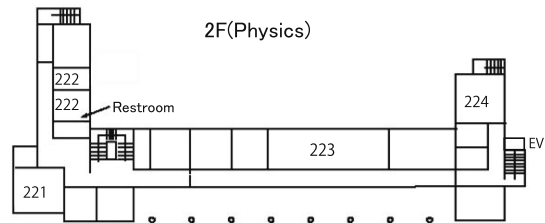
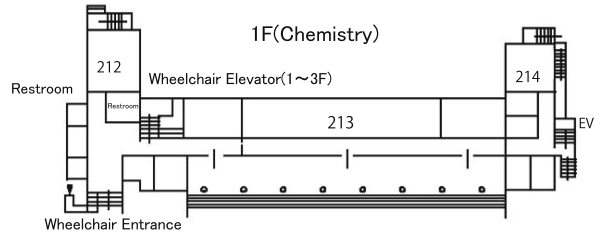

[Hiyoshi Campus Map]

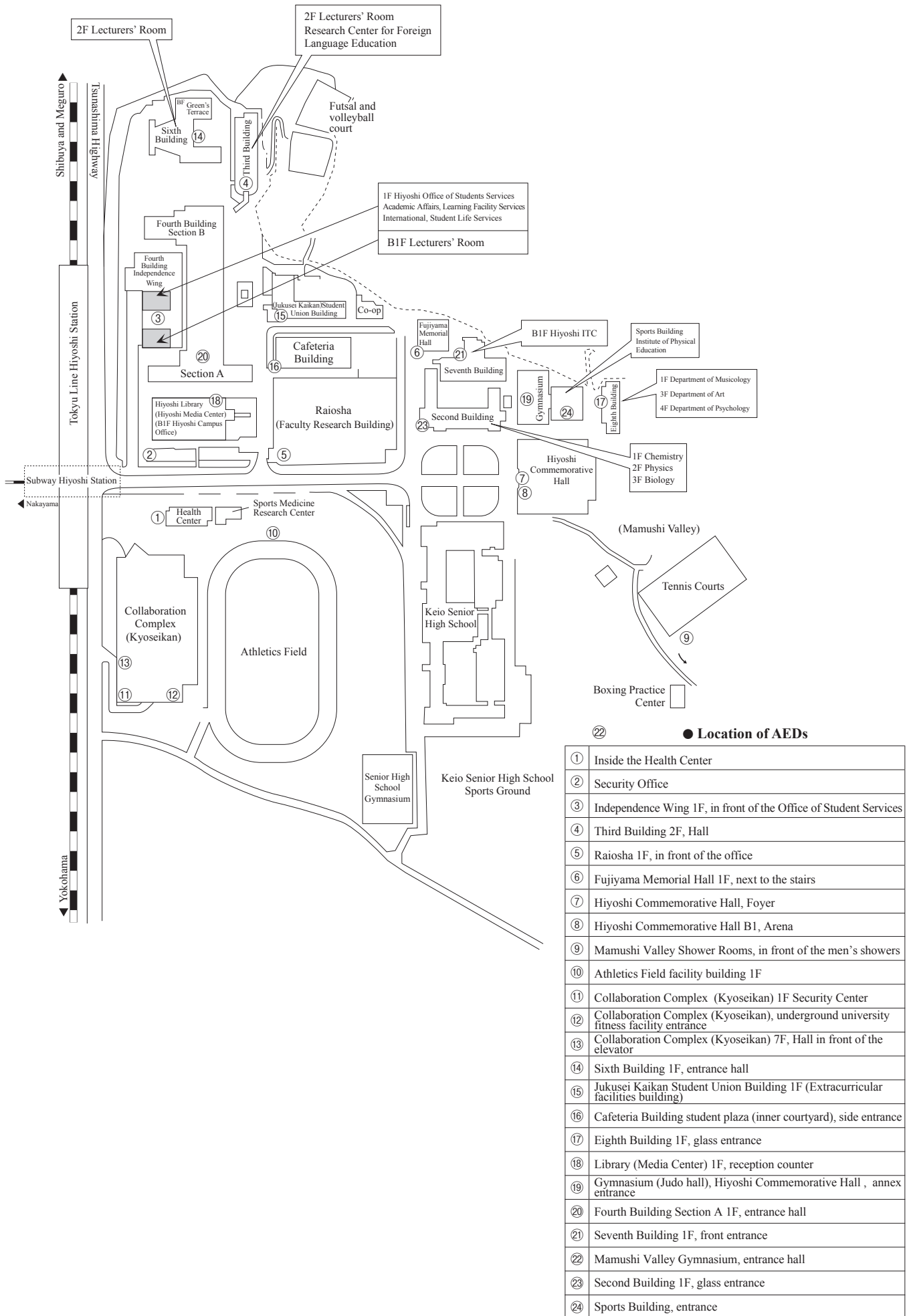

As of April 2022