

FALL 2023

FACULTY OF ECONOMICS PEARL

TIMETABLE

FIRST YEAR

Notes

1. Please pay attention and do not confuse course registration numbers with classroom numbers.
2. Half-year intensive courses have two classes per week, for example, English Academic Skills. For these courses, the same course registration number is printed for both classes.
For intensive course registration, if you enter the registration number, you will be registered for both classes automatically.
3. Important announcements from the university will be posted on the Keio University Student Website or "News" on keio.jp. Also, there will be notices posted at these locations if there are any classroom changes in the middle of the semester or temporary classroom changes. It is your responsibility to check the website regularly so as not to miss notices.
4. Any results in courses you have not registered for will be invalid, even if you take the exams or submit assignments.

*** Course Registration**

<http://keio.jp/> > Class > Course Registration

*** Keio University Syllabus and Timetable**

<https://gslbs.keio.jp/syllabus/login>

*** Keio University Student Website**

<https://www.students.keio.ac.jp/>

		1 : 9 : 0 0 ~ 1 0 : 3 0					2 : 1 0 : 4 5 ~ 1 2 : 1 5				
		Lecturer	CIs	Reg. No.	Courses	Room	Lecturer	CIs	Reg. No.	Courses	Room
Mon	FOREIGN LANGUAGES										
	FOUNDATION	OTOMONIDES, CATHERINE		89313	【Fa】 LINEAR ALGEBRA	1 2					
	GENERAL EDUCATION (CATEGORY I)										
	GENERAL EDUCATION (CATEGORY II)						YAGYU, TOMOKO		89309	【FaIn】 HISTORY	J 4 1 2
Tue	FOUNDATION	SHIRATSUKA, SHIGENOBU	P	89328	【Fa】 INTRODUCTION TO THE JAPANESE ECONOMY	D 2 0 3					
	MAJOR SUBJECTS						FUJIWARA, IPPEI	P	89954	【Fa】 ELEMENTARY MACROECONOMICS 1	D 2 0 3
	GENERAL EDUCATION (CATEGORY I)										
	GENERAL EDUCATION (CATEGORY II)	FUSE, TSUTOMU		98276	【Fa】 HEALTH AND HUMAN PERFORMANCE 1 (GIC-certified courses)						
Wed	FOREIGN LANGUAGES	WELCH, SHANNON KAZ, DIANA M. NAKATSUGAWA, MIYUKI NOBUOKA, MARY BOHME, STEVENA MURPHY, KEVIN		47229 88321 87894 89347 89366 94342	【FaIn】 ENGLISH ACADEMIC SKILLS 1 【FaIn】 ENGLISH ACADEMIC SKILLS 1 【FaIn】 ENGLISH ACADEMIC SKILLS 1 【FaIn】 ENGLISH ACADEMIC SKILLS 1 【FaIn】 ENGLISH ACADEMIC SKILLS 1 【FaIn】 ENGLISH ACADEMIC SKILLS 1	D 2 0 6 D 2 0 4 D 4 0 1 J 4 1 3 D 4 0 4 D 4 0 9					
	GENERAL EDUCATION (CATEGORY I)						BONZI, ALANA R.		91640	【Fa】 CORPORATE SOCIAL RESPONSIBILITY AND ETHICS 1	D B 1 1 0
	GENERAL EDUCATION (CATEGORY II)										
	GENERAL EDUCATION (CATEGORY III)										
Thu	GENERAL EDUCATION (CATEGORY I)										
	GENERAL EDUCATION (CATEGORY II)	GORSHKOV, VICTOR		00775	【Fa】 TOPICS IN CONTEMPORARY BUSINESS 1 (GIC-certified courses)	3 0 2					
Fri	FOREIGN LANGUAGES	WELCH, SHANNON KAZ, DIANA M. NAKATSUGAWA, MIYUKI NOBUOKA, MARY BOHME, STEVENA MURPHY, KEVIN		47229 88321 87894 89347 89366 94342	【FaIn】 ENGLISH ACADEMIC SKILLS 1 【FaIn】 ENGLISH ACADEMIC SKILLS 1 【FaIn】 ENGLISH ACADEMIC SKILLS 1 【FaIn】 ENGLISH ACADEMIC SKILLS 1 【FaIn】 ENGLISH ACADEMIC SKILLS 1 【FaIn】 ENGLISH ACADEMIC SKILLS 1	D 3 0 1 D 2 0 6 D 4 0 8 3 0 3 D 4 0 1 D 4 0 9					
	GENERAL EDUCATION (CATEGORY I)										
	GENERAL EDUCATION (CATEGORY II)						ERTL, WOLFGANG		46662	【Fa】 ETHICS 2 (GIC-certified courses)	D 2 0 5
	GENERAL EDUCATION (CATEGORY III)										
Sat	GENERAL EDUCATION (CATEGORY I)						SATOU, YUKIKO		91726	【Fa】 LIFE SCIENCE – CURRENT STATUS AND PERSPECTIVES (GIC-certified courses)	
	GENERAL EDUCATION (CATEGORY II)						KIBATA, MIO		01312	【Fa】 HEALTH AND HUMAN PERFORMANCE 1 (GIC-certified courses)	D 3 0 4

[Notes]:

【Fa】 : course offered in the Fall Semester

【FaIn】 : intensive course offered in the Fall Semester

→ : courses offered from preceding period

(GIC-certified courses): course not only for PEARL students whose main language of instruction is English, but also for students who take mainly courses with Japanese as the main language of instruction

* INTENSIVE JAPANESE classes are offered at Mita Campus.

* Courses without classroom numbers listed will be offered online.

* Adjustments will be made to a course if there are a particularly large number of students registering for it. (Highly possible for General Education Courses, especially for Intensive Courses marked as 【FaIn】.)

3 : 13 : 00 ~ 14 : 30					4 : 14 : 45 ~ 16 : 15					5 : 16 : 30 ~ 18 : 00				
Lecturer	Cls	Reg.No.	Courses	Room	Lecturer	Cls	Reg.No.	Courses	Room	Lecturer	Cls	Reg.No.	Courses	Room
IKEDA, YUKIHIRO		78508	[Fa] INTENSIVE JAPANESE 1A(offered at Mita Campus)	5 4 2	IKEDA, YUKIHIRO		78512	[Fa] INTENSIVE JAPANESE 4A(offered at Mita Campus)	5 4 2	MCCOY, DAVIDH		89055	[Fa] GERMAN 1A	3 2 5
										BREFUEL, ROMUALD		89108	[Fa] FRENCH 3A	3 0 9
										MATSUKAWA, IKUYO		89457	[Fa] CHINESE 3A	D 3 0 3
										MATSUKAWA, KOSUKE		89478	[Fa] SPANISH 1A	D 3 0 4
										ONO, NAOMI		02510	[Fa] JAPANESE 1A	J 4 2 7
										OBATA, RIKI		91999	[Fa] SCIENCE AND THE ENVIRONMENT1 (GIC-certified courses)	2 1 4
NAGAI, YOHKO		96751	[FaIn] LITERATURE	J 4 3 3 B						IIDA, MAYU		06041	[Fa] GENDER STUDIES 2 (GIC-certified courses)	D 3 1 1
										TSUCHIDA, HARUNOBU		92502	[Fa] MUSIC1 (GIC-certified courses)	AV Hall
TSUDA, MAYUMI		35563	[Fa] THEORY OF ARTS AND CULTURE 2 (GIC-certified courses)	1 2										
BJOERK, TOVE														
OKIMOTO, TATSUYOSHI	P	89275	[Fa] STATISTICS 1	3 3										
										KAJIMURA, MAYUMI		40611	[Fa] LIFE SCIENCE – CURRENT STATUS AND PERSPECTIVES (GIC-certified courses)	D 4 0 3
										HAYASHI, HIDEKI		04838	[Fa] TOPICS IN CONTEMPORARY BUSINESS 2 (GIC-certified courses)	3 2 5
					INOUE, SATOSHI		92517	[Fa] MUSIC2 (GIC-certified courses)	AV Hall	YAMAMOTO, YUKI		98056	[Fa] SOCIOLOGY 1 (GIC-certified courses)	D 3 0 2
ISHINO, YURIKO		77865	[Fa] INTENSIVE JAPANESE 2A(offered at Mita Campus)	5 4 4	ISHINO, YURIKO		78531	[Fa] INTENSIVE JAPANESE 5A(offered at Mita Campus)	5 4 4	MCCOY, DAVIDH		89060	[Fa] GERMAN 2A	3 2 5
										SAUVEGRAIN, SYLVAIN		89093	[Fa] FRENCH 2A	3 3 6
										WU, MAOSONG		89438	[Fa] CHINESE 1A	D 3 0 9
										MATSUKAWA, KOSUKE		89495	[Fa] SPANISH 2A	D 4 0 7
										AKISADA, MIHO		02539	[Fa] JAPANESE 3A	D 4 0 6
NAGAI, YOHKO		96751	[FaIn] LITERATURE	J 4 3 2 B						VOGL, WALTER		94725	[Fa] LITERATURE 2 (GIC-certified courses)	J 4 2 1
MIHARA, RYOTARO		91310	[FaIn] AREA STUDIES – CONTEMPORARY JAPAN	D 3 0 5										
YUKAWA, YAYOI		46203	[Fa] GENDER STUDIES 2 (GIC-certified courses)	3 3										
					KAWASHITA, MASAKAZU		91339	[Fa] SCIENCE AND THE ENVIRONMENT2	D 4 1 0	KAWASHITA, MASAKAZU		92010	[Fa] SCIENCE AND THE ENVIRONMENT2 (GIC-certified courses)	D 4 1 0
										FLACHI, ANTONINO		35506	[Fa] SCIENCE AND COOKING2 (GIC-certified courses)	
										LIAN, SHU		43439	[Fa] AREA STUDIES–CONTEMPORARY STATE OF AFFAIRS IN CHINA 2 (GIC-certified courses)	D 3 0 9
ISHINO, YURIKO		78546	[Fa] INTENSIVE JAPANESE 3A(offered at Mita Campus)	1 0 3	ISHINO, YURIKO		78565	[Fa] INTENSIVE JAPANESE 6A(offered at Mita Campus)	1 0 3	DEGEN, RALPH		89074	[Fa] GERMAN 3A	D 4 0 4
					TAKAHASHI, KEIKO		98481	[Fa] JAPANESE 5A	J 4 2 5	OSHIMA, ERIKO		89089	[Fa] FRENCH 1A	D 3 0 3
										WU, MAOSONG		89442	[Fa] CHINESE 2A	J 4 2 6
										SANCHEZ BARBERA, H		89940	[Fa] SPANISH 3A	J 4 1 3
										ARTA		02524	[Fa] JAPANESE 2A	J 4 3 7 B
MARUYA, KAZUSHI		04948	[Fa] PSYCHOLOGY 1	8 1 1	FLACHI, ANTONINO		92263	[Fa] SCIENCE AND THE ENVIRONMENT2 (GIC-certified courses)	2 2 4					
SAKO, KATSURA		92612	[Fa] LITERATURE 2 (GIC-certified courses)	J 4 2 3	TARUMI, YUKO		04622	[Fa] SOCIOLOGY 1	J 6 3 1	BENNETT, ALEXANDER C.		92096	[Fa] AREA STUDIES ON CULTURE 1 (GIC-certified courses)	
MIHARA, RYOTARO		91310	[FaIn] AREA STUDIES – CONTEMPORARY JAPAN	D 3 0 2	BAI, YINGJIU		39281	[Fa] GEOGRAPHY2 (GIC-certified courses)	1 2					
TOYODA, KENSUKE		92335	[Fa] SCIENCE AND THE ENVIRONMENT2 (GIC-certified courses)		YAGYU, TOMOKO		89309	[FaIn] HISTORY	J 4 3 1 A					
OMAE, KETICHIRO		00813	[Fa] TOPICS IN CONTEMPORARY BUSINESS 2 (GIC-certified courses)	D 2 0 1										

- In order to register courses listed in the above timetable, please register through the Course Registration System and select column A.
- In order to register courses for type A/B students instructed in Japanese excluding courses offered by various research institutes and other faculties, please consult with the Office of Student Services during the Course Registration Period with extra time. It is not possible to register these courses through the Course Registration System. Dates and periods of those courses can be found on the timetable for type AB students. These credits are counted as Optional Subjects.
- The office will inform students who have not completed “English Academic Skills 1” of which class to take to re-register for the course. Applicable students should check “Message” on keio.jp.

Course Timetable for the Various Research Centers and Institutes at Hiyoshi

There are different course registration procedures for the various research centers and institutes. Carefully read the course descriptions, syllabi online and relative documents.

1. Credits for these courses are counted as Electives (Non-specific) credits.

• Courses offered by the Institute of Physical Education

It is possible to take the same course (sport) multiple times.

In order to register for the following courses, please select column A.

Course	Lecturer	Semester	Day/Period	Registration No.	Classroom
PHYSICAL ACTIVITY A (TENNIS)	SAKAI, TOSHIKI	Fall	Mon/2	39059	Tennis Court (Mamushi Valley)
PHYSICAL ACTIVITY A (SWIMMING)	TORIUMI, TAKASHI	Fall	Thu/3	07746	Kyoseikan Swimming Pool

2. Credits for these courses are counted as Optional credits.

• Courses offered by the Keio Research Center for Foreign Language Education

Courses offered by the Keio Research Center for Foreign Language Education are normally taught in Japanese.

In order to register for the following courses, please select column A.

For procedures to course registration and the results of course registration adjustment, please refer to the website:
<http://www.flang.keio.ac.jp/en/>

		1st period	2nd period	3rd period	4th period	5th period
Mon.	Reg. No					
	Course Name					
	Lecturer					
	Room					
	Credits					
	Field					
Tues.	Reg. No					
	Course Name					
	Lecturer					
	Room					
	Credits					
	Field					
Wed.	Reg. No					
	Course Name					
	Lecturer					
	Room					
	Credits					
	Field					
Thurs.	Reg. No					
	Course Name					
	Lecturer					
	Room					
	Credits					
	Field					
Fri.	Reg. No					
	Course Name					
	Lecturer					
	Room					
	Credits					
	Field					
Sat.	Reg. No					
	Course Name					
	Lecturer					
	Room					
	Credits					
	Field					

Number of Credits for the Fall Semester
 _____ credits in total
 Max credits for a full year
 (2023 Fall Sem. + 2024 Spring Sem.):
 48 credits

MEMO

MEMO

Classroom Map

【Fujiyama Memorial Hall】

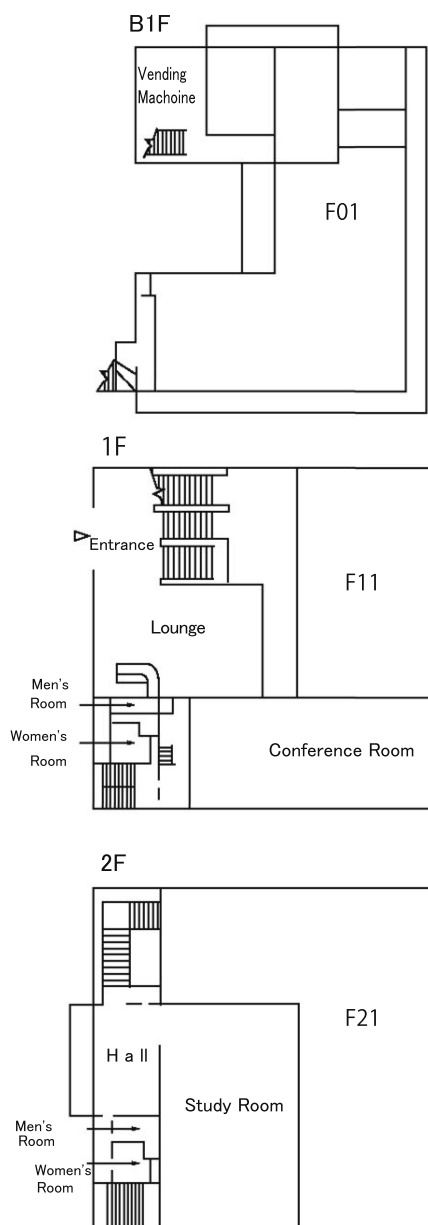

【Fourth Building Independence Wing】

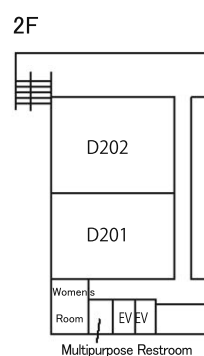
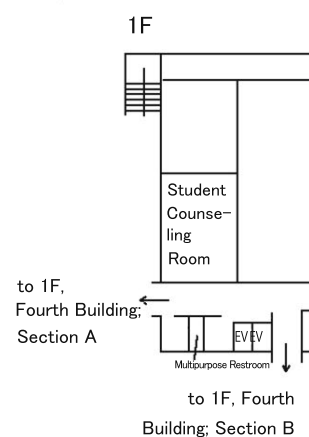
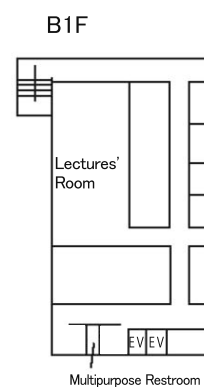
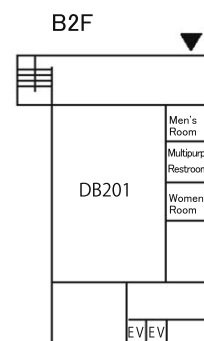
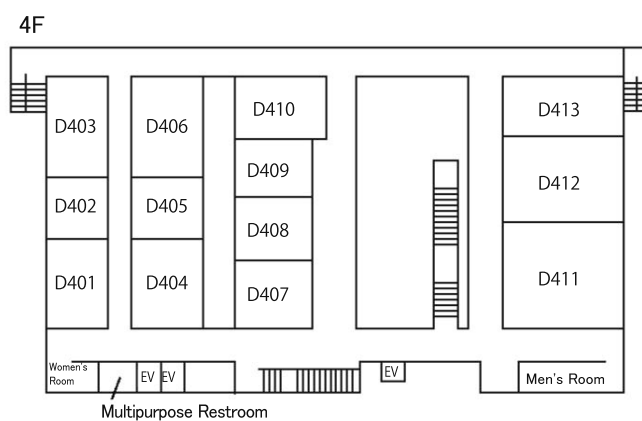
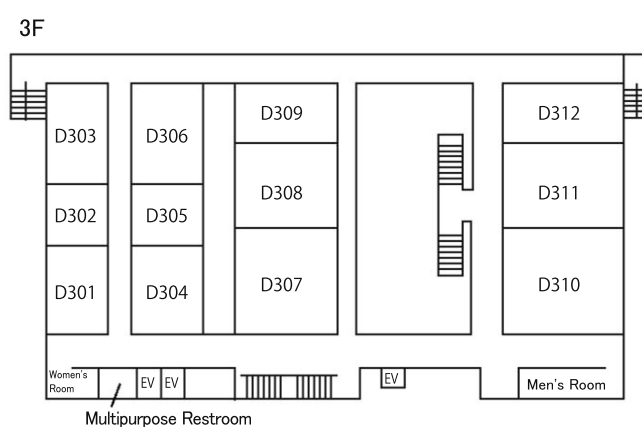

【Fourth Building General View】

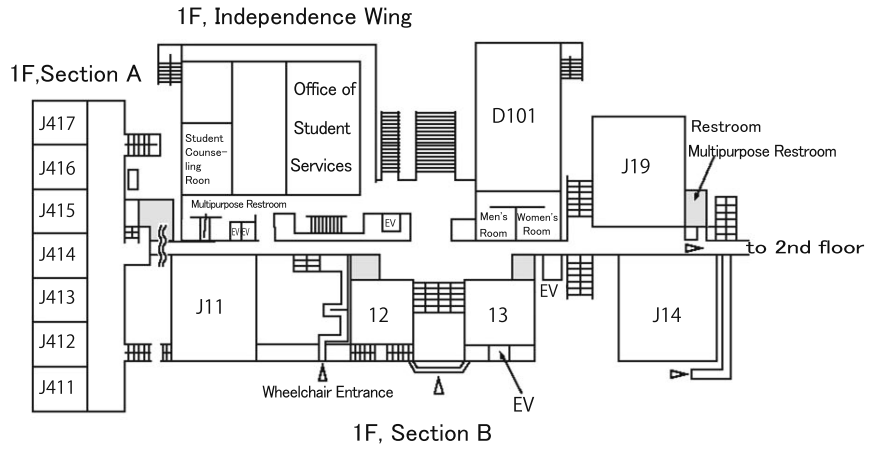
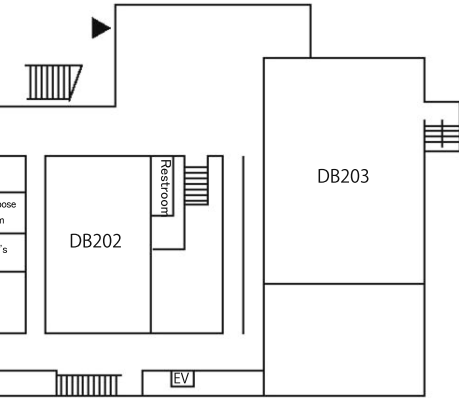

1F, Section B

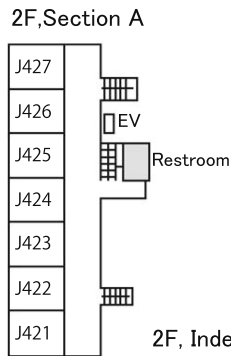
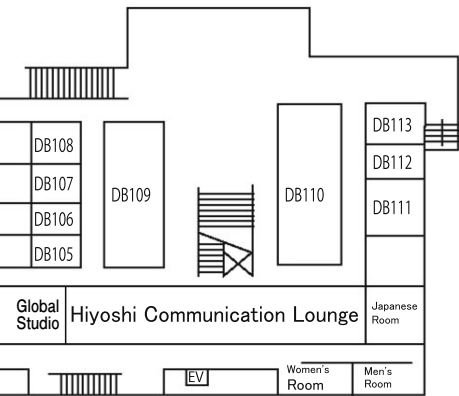

2F, Independence Wing

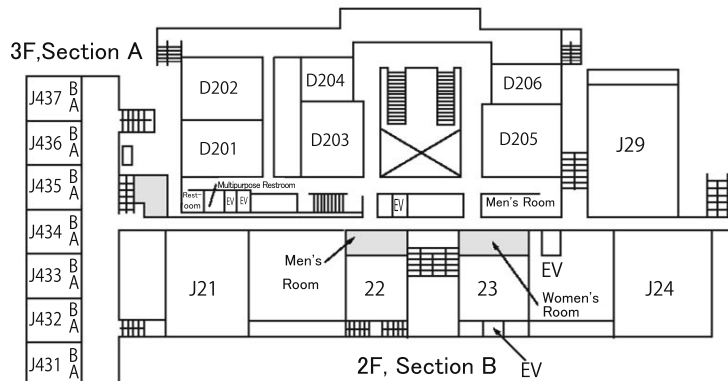
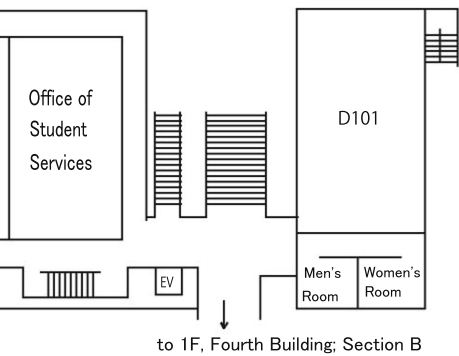

3F, Independence Wing

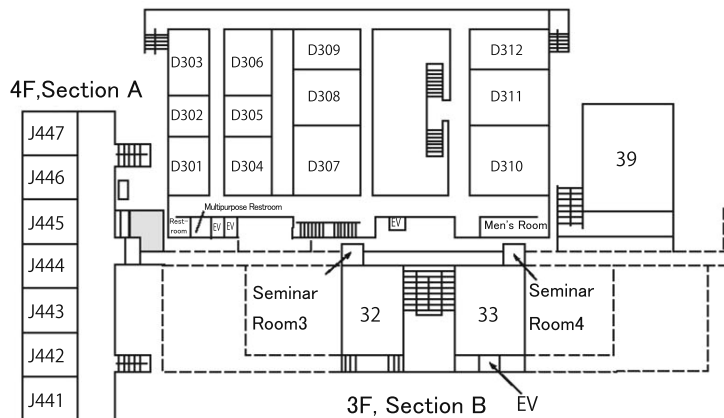
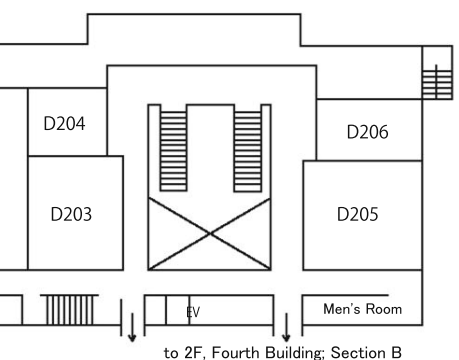

3F, Section B

【Eighth Building】

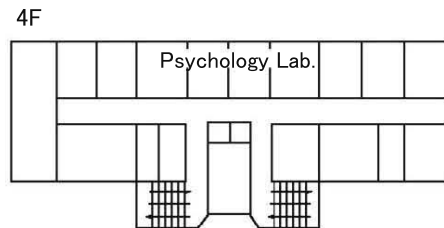
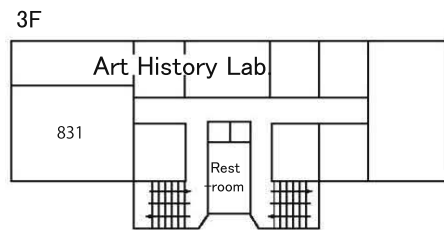
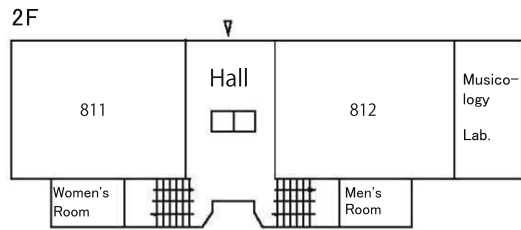

【Seventh Building】

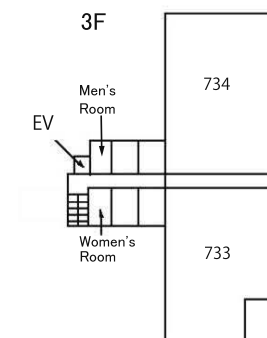
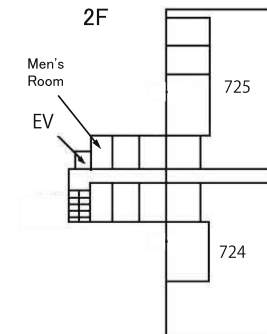
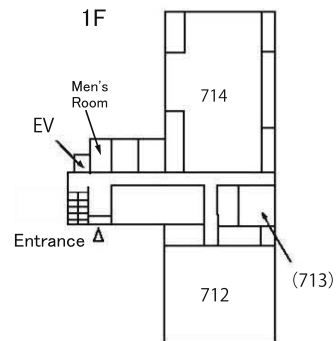
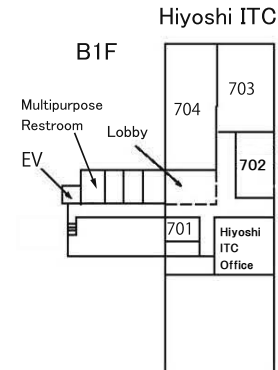

【Sixth Building】

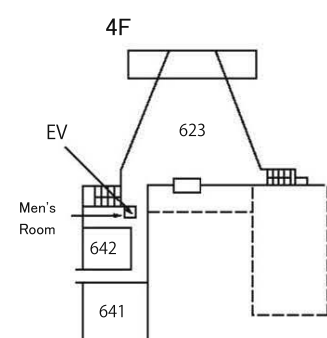
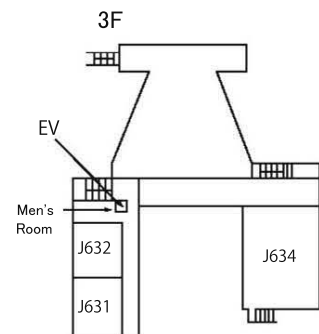
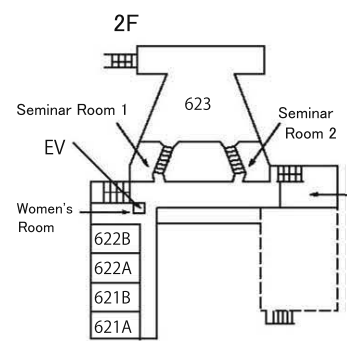
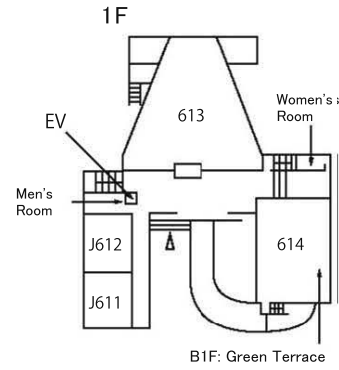

【Third Building】

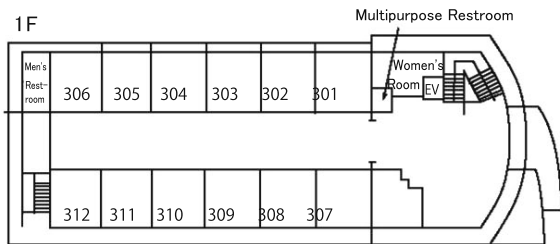

【Second Building】

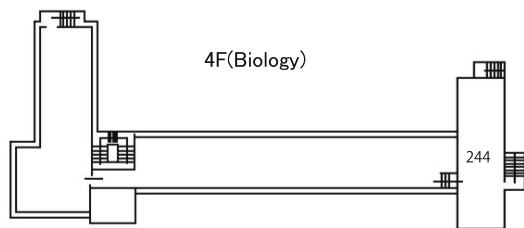
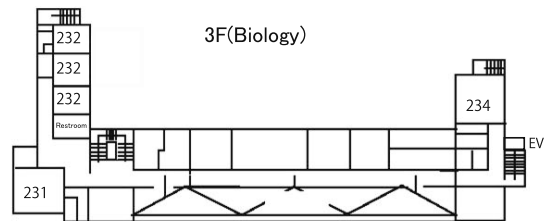
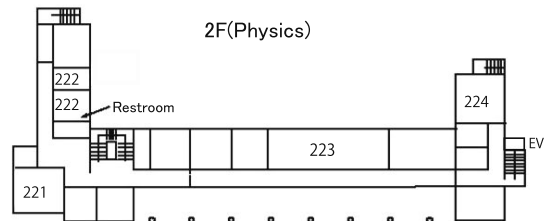
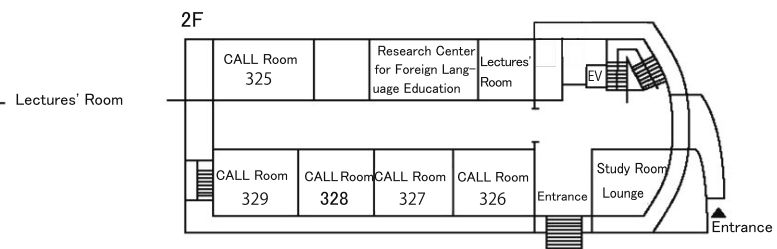
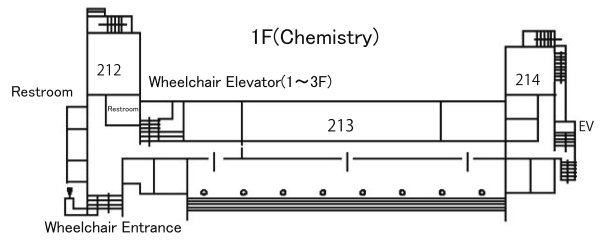

[Hiyoshi Campus Map]

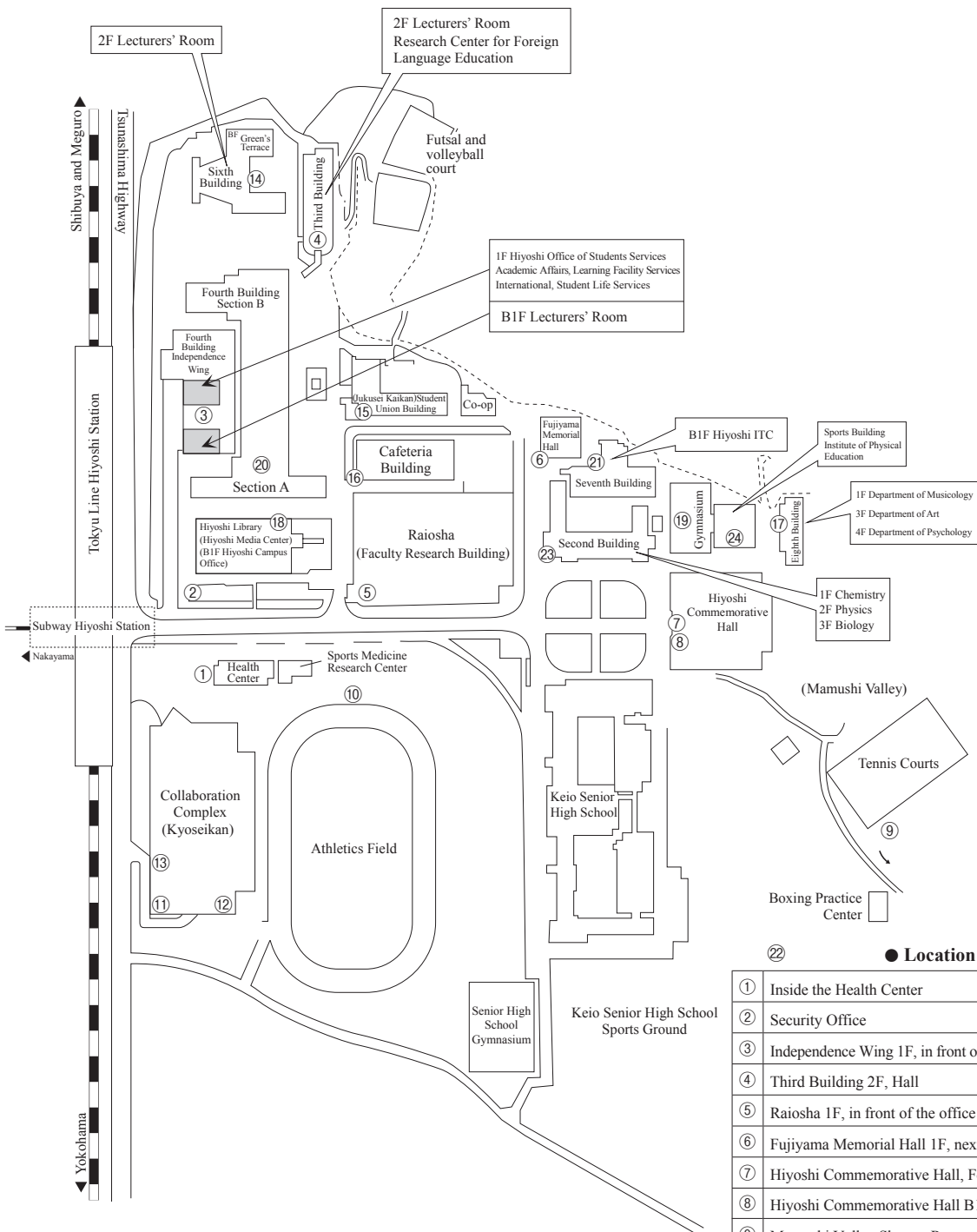

● Location of AEDs

①	Inside the Health Center
②	Security Office
③	Independence Wing 1F, in front of the Office of Student Services
④	Third Building 2F, Hall
⑤	Raiosha 1F, in front of the office
⑥	Fujiyama Memorial Hall 1F, next to the stairs
⑦	Hiyoshi Commemorative Hall, Foyer
⑧	Hiyoshi Commemorative Hall B1, Arena
⑨	Mamushi Valley Shower Rooms, in front of the men's showers
⑩	Athletics Field facility building 1F
⑪	Collaboration Complex (Kyoseikan) 1F Security Center
⑫	Collaboration Complex (Kyoseikan), underground university fitness facility entrance
⑬	Collaboration Complex (Kyoseikan) 7F, Hall in front of the elevator
⑭	Sixth Building 1F, entrance hall
⑮	Jukusei Kaikan Student Union Building 1F (Extracurricular facilities building)
⑯	Cafeteria Building student plaza (inner courtyard), side entrance
⑰	Eighth Building 1F, glass entrance
⑱	Library (Media Center) 1F, reception counter
⑲	Gymnasium (Judo hall), Hiyoshi Commemorative Hall, annex entrance
⑳	Fourth Building Section A 1F, entrance hall
㉑	Seventh Building 1F, front entrance
㉒	Mamushi Valley Gymnasium, entrance hall
㉓	Second Building 1F, glass entrance
㉔	Sports Building, entrance

As of April 2023