

FALL 2023

FACULTY OF ECONOMICS PEARL

TIMETABLE

SECOND YEAR

Notes

1. Please pay attention and do not confuse course registration numbers with classroom numbers.
2. Half-year intensive courses have two classes per week, for example, English Academic Skills. For these courses, the same course registration number is printed for both classes.
For intensive course registration, if you enter the registration number, you will be registered for both classes automatically.
3. Important announcements from the university will be posted on the Keio University Student Website or "News" on keio.jp. Also, there will be notices posted at these locations if there are any classroom changes in the middle of the semester or temporary classroom changes. It is your responsibility to check the website regularly so as not to miss notices.
4. Any results in courses you have not registered for will be invalid, even if you take the exams or submit assignments.

- * **Course Registration**

<http://keio.jp/> > **Class > **Course Registration****

- * **Keio University Syllabus and Timetable**

<https://gslbs.keio.jp/syllabus/login>

- * **Keio University Student Website**

<https://www.students.keio.ac.jp/>

		1 : 9 : 00 ~ 10 : 30					2 : 10 : 45 ~ 12 : 15				
		Lecturer	CIs	Reg. No.	Courses	Room	Lecturer	CIs	Reg. No.	Courses	Room
Mon	FOREIGN LANGUAGES										
	FOUNDATION GENERAL EDUCATION (CATEGORY I)						OLKONOMIDES, CATHERINE		96709	【Fa】 CALCULUS	12
	GENERAL EDUCATION (CATEGORY II)						YAGYU, TOMOKO		89309	【FaIn】 HISTORY	J 412
	GENERAL EDUCATION (CATEGORY III)										
Tue	MAJOR SUBJECTS										
	GENERAL EDUCATION (CATEGORY I)										
	GENERAL EDUCATION (CATEGORY II)	FUSE, TSUTOMU		98276	【Fa】 HEALTH AND HUMAN PERFORMANCE 1 (GIC-certified courses)						
Wed	FOREIGN LANGUAGES										
	GENERAL EDUCATION (CATEGORY II)						BONZI, ALANA R.		91640	【Fa】 CORPORATE SOCIAL RESPONSIBILITY AND ETHICS 1	DB110
Thu	MAJOR SUBJECTS	KAWAI, KEIICHI	P	95482	【Fa】 INTRODUCTION TO MICROECONOMICS 1	D 203	YAGYU, TOMOKO	P	95497	【Fa】 ELEMENTARY ECONOMIC HISTORY 1	12
	GENERAL EDUCATION (CATEGORY I)										
	GENERAL EDUCATION (CATEGORY II)	GORSHKOV, VICTOR		00775	【Fa】 TOPICS IN CONTEMPORARY BUSINESS 1 (GIC-certified courses)	302					
Fri	FOREIGN LANGUAGES										
	MAJOR SUBJECTS						OKA, TATSUSHI		95459	【Fa】 INTRODUCTION TO ECONOMETRICS	12
	GENERAL EDUCATION (CATEGORY I)										
Sat	GENERAL EDUCATION (CATEGORY II)						ERTL, WOLFGANG		46662	【Fa】 ETHICS 2 (GIC-certified courses)	D 205
	GENERAL EDUCATION (CATEGORY I)						SATOU, YUKIKO		91726	【Fa】 LIFE SCIENCE - CURRENT STATUS AND PERSPECTIVES (GIC-certified courses)	
	GENERAL EDUCATION (CATEGORY II)						KIBATA, MIO		01312	【Fa】 HEALTH AND HUMAN PERFORMANCE 1 (GIC-certified courses)	D 304

[Notes]:

【Fa】 : course offered in the Fall Semester

【FaIn】 : intensive course offered in the Fall Semester

→ : courses offered from preceding period

(GIC-certified courses): course not only for PEARL students whose main language of instruction is English, but also for students who take mainly courses with Japanese as the main language of instruction

(*) : Two-semester pair course

*Courses without classroom numbers listed will be offered online.

*Adjustments will be made to a course if there are a particularly large number of students registering for it. (Highly possible for General Education Courses, especially for Intensive Courses marked as 【FaIn】 .)

3 : 13 : 00 ~ 14 : 30					4 : 14 : 45 ~ 16 : 15					5 : 16 : 30 ~ 18 : 00				
Lecturer	Cls	Reg.No.	Courses	Room	Lecturer	Cls	Reg.No.	Courses	Room	Lecturer	Cls	Reg.No.	Courses	Room
AKISADA, MIHO		98190	[Fa] INTENSIVE JAPANESE 7A	J 4 3 4 B	MCCOY, DAVIDH		12224	[FaIn] GERMAN 4A	3 2 5					
					LEBOIS, JEROME		12239	[FaIn] FRENCH 4A	D 4 0 9					
					ZHANG, YUE		12243	[FaIn] CHINESE 4A	D 3 0 6					
					MATSUKAWA, KOSUKE		12258	[FaIn] SPANISH 4A	D 3 0 4					
					ONO, NAOMI		12918	[FaIn] JAPANESE 4A	J 4 2 7					
					AKISADA, MIHO		98534	[Fa] INTENSIVE JAPANESE 10A	J 4 3 4 B					
										OBATA, RIKI		91999	[Fa] SCIENCE AND THE ENVIRONMENT1 (GIC-certified courses)	2 1 4
NAGAI, YOHKO		96751	[FaIn] LITERATURE	J 4 3 3 B						IIDA, MAYU		06041	[Fa] GENDER STUDIES 2(GIC-certified courses)	D 3 1 1
										TSUCHIDA, HARUNOBU		92502	[Fa] MUSIC1(GIC-certified courses)	AV Hall
TSUDA, MAYUMI BJOERK, TOVE		35563	[Fa] THEORY OF ARTS AND CULTURE 2 (GIC-certified courses)	1 2										
					SATO, SORA		95224	[Fa] INTRODUCTION TO THE HISTORY OF ECONOMIC THOUGHT 1	2 3	SASAHARA, AKIRA		35343	[Fa] ECONOMIES AND SOCIETIES IN GLOBALIZATION	D 2 0 1
					OHNISHI, HIROSHI		95626	[Fa] MARXIAN ECONOMICS 1	D 3 0 9					
										KAJIMURA, MAYUMI		40611	[Fa] LIFE SCIENCE - CURRENT STATUS AND PERSPECTIVES(GIC-certified courses)	D 4 0 3
					INOUE, SATOSHI		92517	[Fa] MUSIC2(GIC-certified courses)	AV Hall	HAYASHI, HIDEKI		04838	[Fa] TOPICS IN CONTEMPORARY BUSINESS 2(GIC-certified courses)	3 2 5
										YAMAMOTO, YUKI		98056	[Fa] SOCIOLOGY 1(GIC-certified courses)	D 3 0 2
					MCCOY, DAVIDH		12224	[FaIn] GERMAN 4B	3 2 5	ISHIZUKA, KYOKO		98850	[Fa] INTENSIVE JAPANESE 11A	D 3 0 1
					SAUVEGRAIN, SYLVAIN		12239	[FaIn] FRENCH 4B	3 3 6					
					ZHANG, YUE		12243	[FaIn] CHINESE 4B	D 4 0 5					
					MATSUKAWA, KOSUKE		12258	[FaIn] SPANISH 4B	D 4 0 7					
					KASHIKURA, HIROMI		12918	[FaIn] JAPANESE 4B	D 4 0 6					
					ISHIZUKA, KYOKO		98520	[Fa] INTENSIVE JAPANESE 8A	D 3 0 1					
NAGAI, YOHKO MIHARA, RYOTARO		96751 91310	[FaIn] LITERATURE [FaIn] AREA STUDIES - CONTEMPORARY JAPAN	J 4 3 2 B D 3 0 5						VOGL, WALTER		94725	[Fa] LITERATURE 2(GIC-certified courses)	J 4 2 1
YUKAWA, YAYOI		46203	[Fa] GENDER STUDIES 2(GIC-certified courses)	3 3										
					KAWASHITA, MASAKAZU		91339	[Fa] SCIENCE AND THE ENVIRONMENT2 (CATEGORY 1)	D 4 1 0	KAWASHITA, MASAKAZU		92010	[Fa] SCIENCE AND THE ENVIRONMENT2 (GIC-certified courses)	D 4 1 0
										FLACHI, ANTONINO		35506	[Fa] SCIENCE AND COOKING2(GIC-certified courses)	
										LIAN, SHI		43439	[Fa] AREA STUDIES-CONTEMPORARY STATE OF AFFAIRS IN CHINA 2(GIC-certified courses)	D 3 0 9
SANAI, KAORU		98917	[Fa] INTENSIVE JAPANESE 9A	D 3 0 4	SANAI, KAORU		98921	[Fa] INTENSIVE JAPANESE 12A	D 3 0 4					
					TAKAHASHI, KEIKO		98481	[Fa] JAPANESE 5A	J 4 2 5					
MARUYA, KAZUSHI		04948	[Fa] PSYCHOLOGY 1	8 1 1	FLACHI, ANTONINO		92263	[Fa] SCIENCE AND THE ENVIRONMENT2 (GIC-certified courses)	2 2 4					
SAKO, KATSURA		92612	[Fa] LITERATURE 2(GIC-certified courses)	J 4 2 3	TARUMI, YUKO		04622	[Fa] SOCIOLOGY 1	J 6 3 1	BENNETT, ALEXANDER C.		92096	[Fa] AREA STUDIES ON CULTURE 1(GIC-certified courses)	
MIHARA, RYOTARO		91310	[FaIn] AREA STUDIES - CONTEMPORARY JAPAN	D 3 0 2	BAI, YINGJIU		39281	[Fa] GEOGRAPHY2(GIC-certified courses)	1 2					
TOYODA, KENSUKE		92335	[Fa] SCIENCE AND THE ENVIRONMENT2 (GIC-certified courses)		YAGYU, TOMOKO		89309	[FaIn] HISTORY	J 4 3 1 A					
OMAE, KETICHIRO		00813	[Fa] TOPICS IN CONTEMPORARY BUSINESS 2(GIC-certified courses)	D 2 0 1										

• In order to register courses listed in the above timetable, please register through the Course Registration System and select column A.

• If you wish to register courses for type A/B students instructed in Japanese excluding courses offered by various research institutes and other faculties, please consult with the Office of Student Services during the Course Registration Period with extra time. It is not possible to register these courses through the Course Registration System. Dates and periods of those courses can be found on the timetable for type AB students. These credits are counted as Optional Subjects.

• Students who have not taken all of the mandatory subjects for the Fall Semester of the first year should check the timetable on page 5 and carry out the course registrations.

Course Timetable

for the Various Research Centers and Institutes at Hiyoshi

There are different course registration procedures for the various research centers and institutes. Carefully read the course descriptions, syllabi online and relative documents.

1. Credits for these courses are counted as Electives (Non-specific) credits.

• Courses offered by the Institute of Physical Education

It is possible to take the same course (sport) multiple times.

In order to register for the following courses, please select column A.

Course	Lecturer	Semester	Day/Period	Registration No.	Classroom
PHYSICAL ACTIVITY A (TENNIS)	SAKAI, TOSHIAKI	Fall	Mon/2	39059	Tennis Court (Mamushi Valley)
PHYSICAL ACTIVITY A (SWIMMING)	TORIUMI, TAKASHI	Fall	Thu/3	07746	Kyoseikan Swimming Pool

▪ Courses offered by the International Center

Courses offered by the International Center are held at **Mita Campus**.

When course names are the same, students are able to take only one of them even though they are taught by different lecturers. In order to register for the following courses, please select column A.

For procedures to course registration and the results of course registration adjustment, please refer to the website:
<https://www.ic.keio.ac.jp/en/aboutic/aboutcourse/>

2. Credits for these courses are counted as Optional credits.

▪ Courses offered by the Keio Research Center for Foreign Language Education

Courses offered by the Keio Research Center for Foreign Language Education are normally taught in Japanese.

In order to register for the following courses, please select column A.

For procedures to course registration and the results of course registration adjustment, please refer to the website:
<http://www.flang.keio.ac.jp/en/>

Timetable of Mandatory Subjects and Foundation Subjects(Elective subjects) for First-Year Students

Students who have not taken all of the mandatory subjects for the Fall Semester of the first year should check the timetable below and carry out the course registrations.

The office will inform via "Message" on keio.jp students who have not completed "English Academic Skills 1" of which class to take to re-register for the course.

Course	Lecturer	Semester	Day/Period	Registration No.	Classroom
ENGLISH ACADEMIC SKILLS 1	WELCH, SHANNON	Fall	Wed/1,Fri/1	47229	D206,D301
ENGLISH ACADEMIC SKILLS 1	KAZ, DIANA M.	Fall	Wed/1,Fri/1	88321	D204,D206
ENGLISH ACADEMIC SKILLS 1	NAKATSUGAWA, MIYUKI	Fall	Wed/1,Fri/1	87894	D401,D408
ENGLISH ACADEMIC SKILLS 1	NOBUOKA, MARY	Fall	Wed/1,Fri/1	89347	J413,303
ENGLISH ACADEMIC SKILLS 1	BOHME, STEVEN	Fall	Wed/1,Fri/1	89366	D404,D401
ENGLISH ACADEMIC SKILLS 1	MURPHY, KEVIN	Fall	Wed/1,Fri/1	94342	D409,D409
GERMAN 1A	MCCOY, DAVID H.	Fall	Mon/5	89055	325
GERMAN 2A	MCCOY, DAVID H.	Fall	Wed/5	89060	325
GERMAN 3A	DEGEN, RALPH	Fall	Fri/5	89074	D404
FRENCH 1A	OSHIMA, ERIKO	Fall	Fri/5	89089	D303
FRENCH 2A	SAUVEGRAIN., SYLVAIN	Fall	Wed/5	89093	336
FRENCH 3A	BREFUEL, ROMUALD	Fall	Mon/5	89108	309
CHINESE 1A	WU, MAOSONG	Fall	Wed/5	89438	D309
CHINESE 2A	WU, MAOSONG	Fall	Fri/5	89442	J426
CHINESE 3A	MATSUKAWA, IKUYO	Fall	Mon/5	89457	D303
SPANISH 1A	MATSUKAWA, KOSUKE	Fall	Mon/5	89476	D304
SPANISH 2A	MATSUKAWA, KOSUKE	Fall	Wed/5	89495	D407
SPANISH 3A	SANCHEZ BARRERA, MARTA	Fall	Fri/5	89940	J413
JAPANESE 1A	ONO, NAOMI	Fall	Mon/5	02510	J427
JAPANESE 2A	ONO, NAOMI	Fall	Fri/5	02524	J437B
JAPANESE 3A	AKISADA, MIHO	Fall	Wed/5	02539	D406
ELEMENTARY MACROECONOMICS 1	FUJIWARA, IPPEI	Fall	Tue/2	89954	D203
INTRODUCTION TO THE JAPANESE ECONOMY	SHIRATSUKA, SHIGENORI	Fall	Tue/1	89328	D203
STATISTICS 1	OKIMOTO, TATSUYOSHI	Fall	Tue/3	89275	33

First Year Foundation Subjects (Elective subjects)

Although the course listed below is for the first year students, it is available for the second year students to take.

Course	Lecturer	Semester	Day/Period	Registration No.	Classroom
LINEAR ALGEBRA	OIKONOMIDES, CATHERINE	Fall	Mon/1	89313	12

		1st period	2nd period	3rd period	4th period	5th period
Mon.	Reg. No					
	Course Name					
	Lecturer					
	Room					
	Credits					
	Field					
Tues.	Reg. No					
	Course Name					
	Lecturer					
	Room					
	Credits					
	Field					
Wed.	Reg. No					
	Course Name					
	Lecturer					
	Room					
	Credits					
	Field					
Thurs.	Reg. No					
	Course Name					
	Lecturer					
	Room					
	Credits					
	Field					
Fri.	Reg. No					
	Course Name					
	Lecturer					
	Room					
	Credits					
	Field					
Sat.	Reg. No					
	Course Name					
	Lecturer					
	Room					
	Credits					
	Field					

Number of Credits for the Fall Semester
 _____ credits in total
 Max credits for a full year
 (2023 Fall Sem. + 2024 Spring Sem.):
 48 credits

MEMO

Classroom Map

【Fujiyama Memorial Hall】

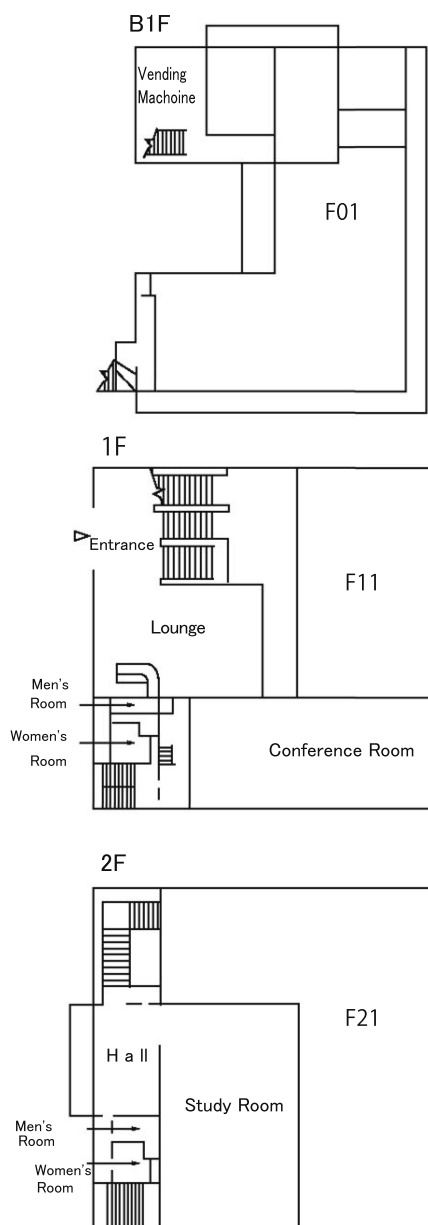

【Fourth Building Independence Wing】

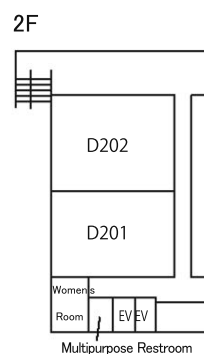
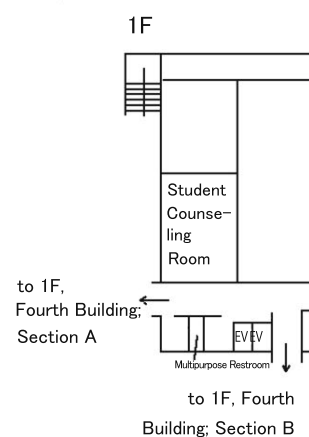
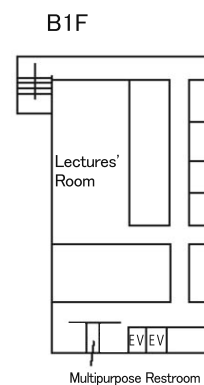
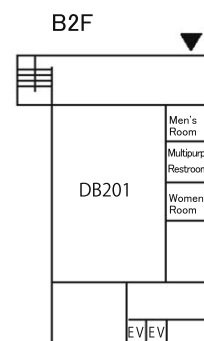
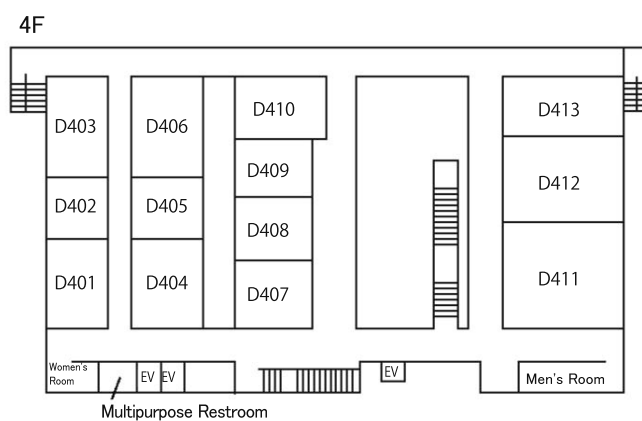
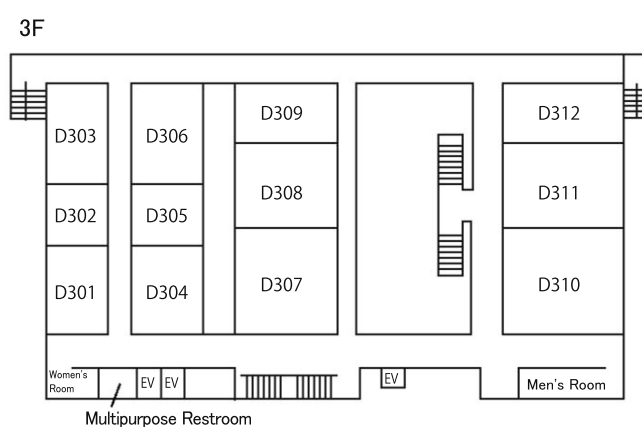

【Fourth Building General View】

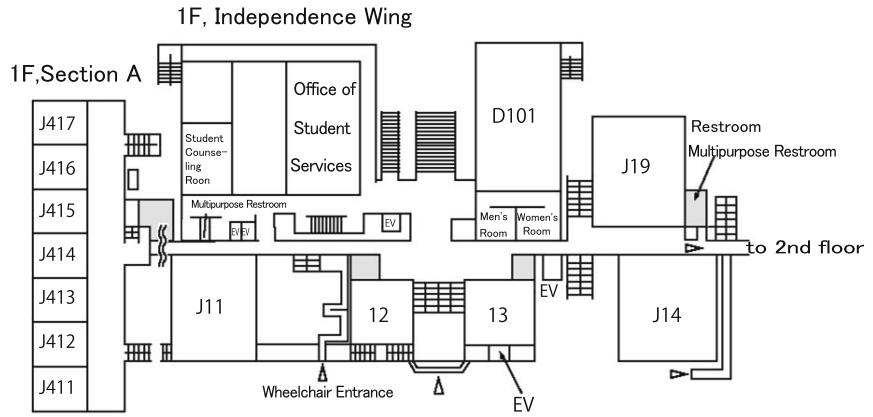
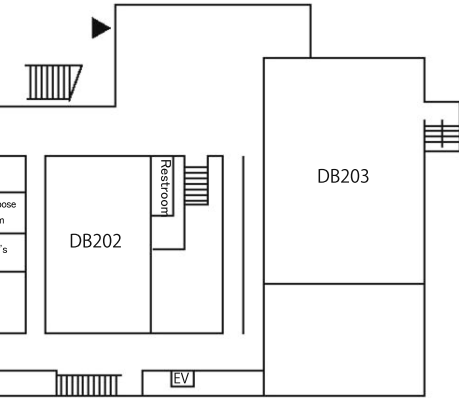

1F, Section B

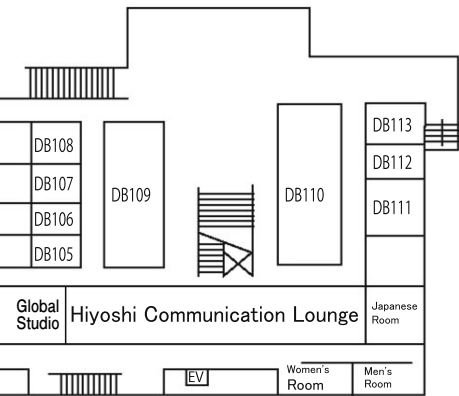

2F, Section A

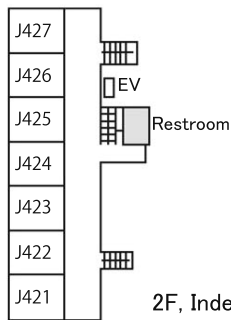

2F, Independence Wing

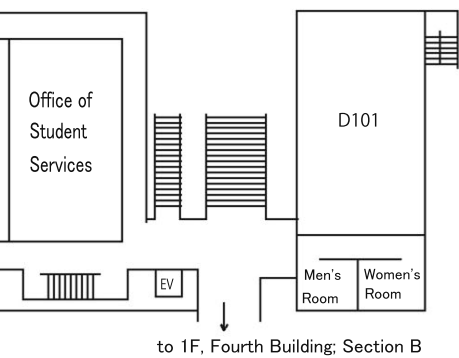

3F, Section A

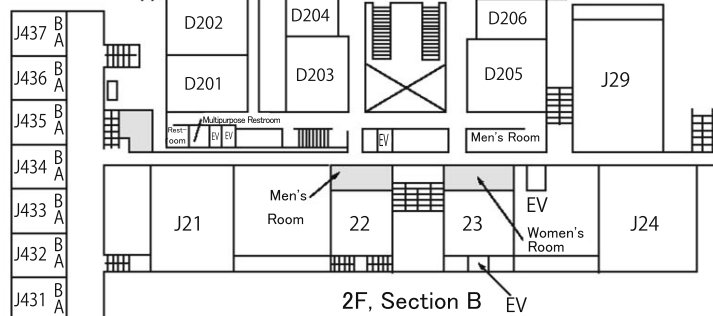

2F, Section B

3F, Independence Wing

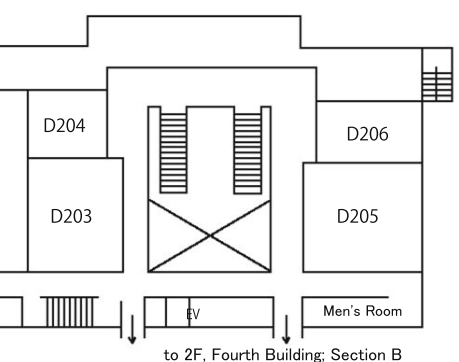

4F, Section A

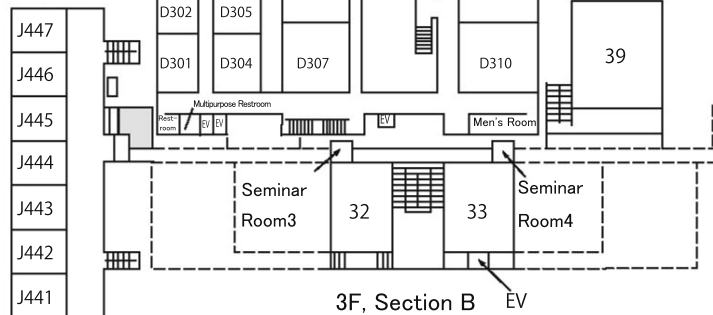

3F, Section B

【Eighth Building】

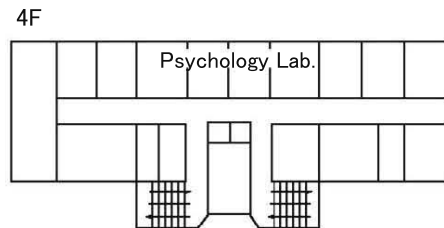
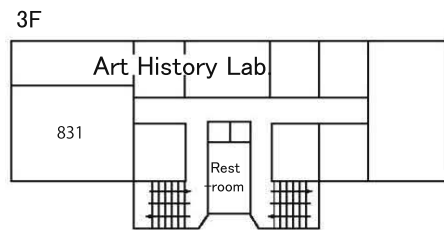
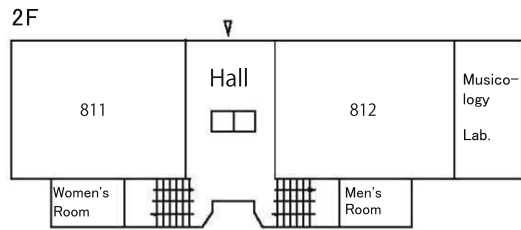

【Seventh Building】

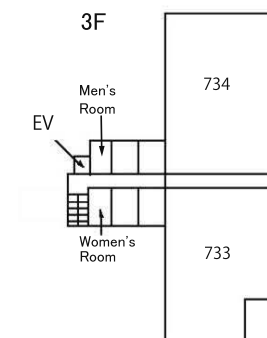
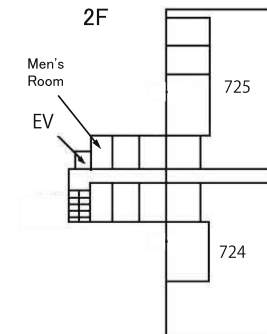
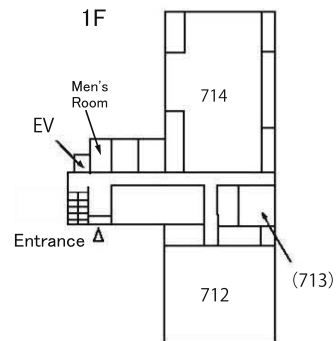
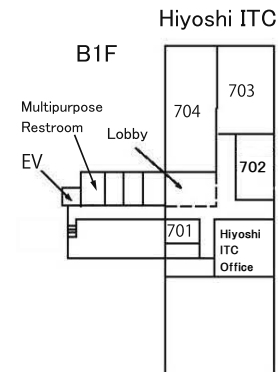

【Sixth Building】

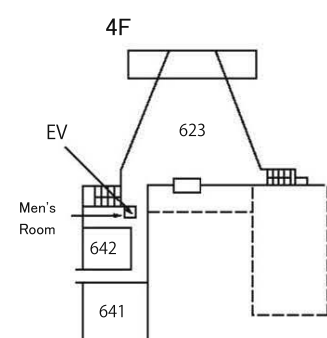
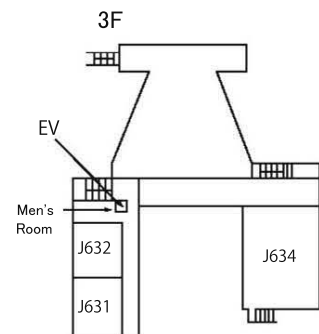
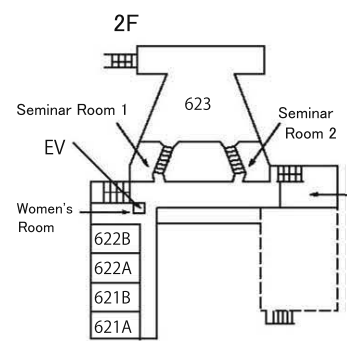
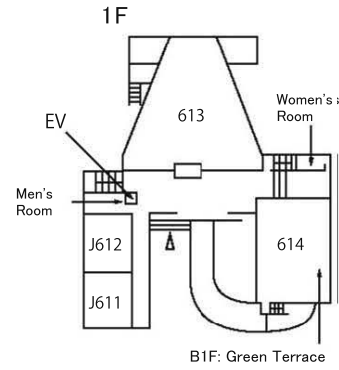

【Third Building】

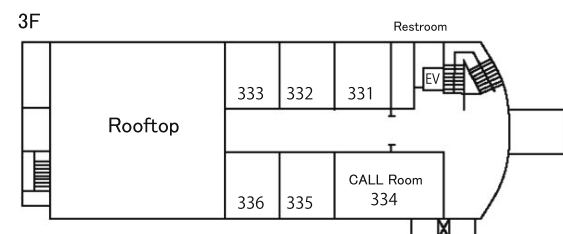
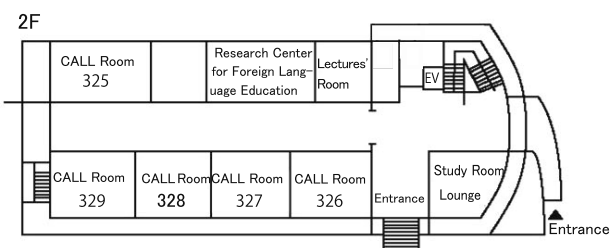
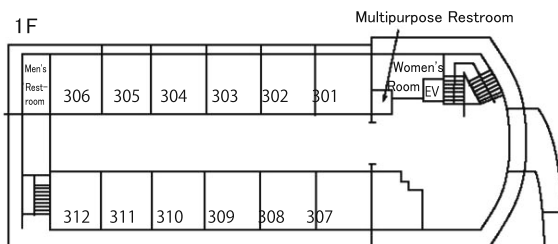

【Second Building】

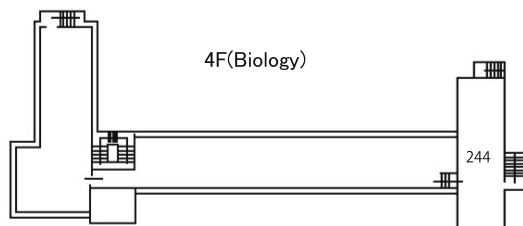
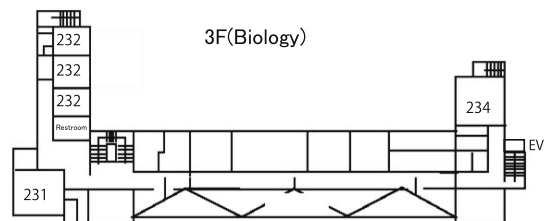
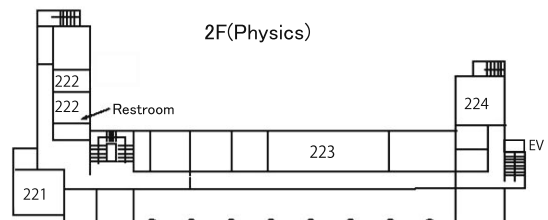
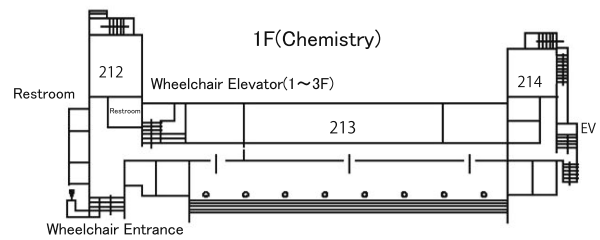

[Hiyoshi Campus Map]

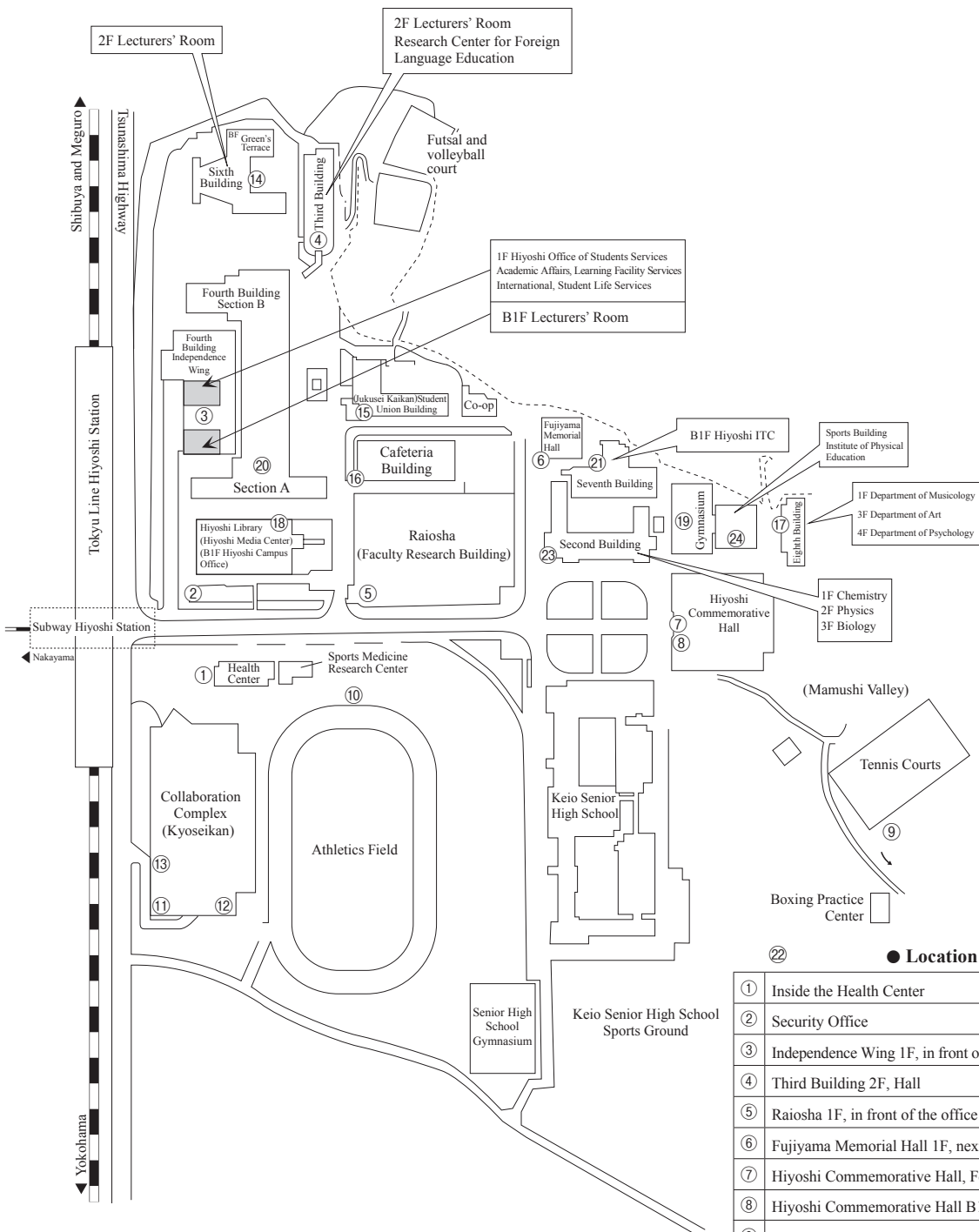

● Location of AEDs

①	Inside the Health Center
②	Security Office
③	Independence Wing 1F, in front of the Office of Student Services
④	Third Building 2F, Hall
⑤	Raiosha 1F, in front of the office
⑥	Fujiyama Memorial Hall 1F, next to the stairs
⑦	Hiyoshi Commemorative Hall, Foyer
⑧	Hiyoshi Commemorative Hall B1, Arena
⑨	Mamushi Valley Shower Rooms, in front of the men's showers
⑩	Athletics Field facility building 1F
⑪	Collaboration Complex (Kyoseikan) 1F Security Center
⑫	Collaboration Complex (Kyoseikan), underground university fitness facility entrance
⑬	Collaboration Complex (Kyoseikan) 7F, Hall in front of the elevator
⑭	Sixth Building 1F, entrance hall
⑮	Jukusei Kaikan Student Union Building 1F (Extracurricular facilities building)
⑯	Cafeteria Building student plaza (inner courtyard), side entrance
⑰	Eighth Building 1F, glass entrance
⑱	Library (Media Center) 1F, reception counter
⑲	Gymnasium (Judo hall), Hiyoshi Commemorative Hall, annex entrance
⑳	Fourth Building Section A 1F, entrance hall
㉑	Seventh Building 1F, front entrance
㉒	Mamushi Valley Gymnasium, entrance hall
㉓	Second Building 1F, glass entrance
㉔	Sports Building, entrance

As of April 2023